

SURVEY & REMONUMENTATION

DEC 13 2000

SECTION

LAND CORNER RECORDATION CERTIFICATE
FILING REQUIREMENT OF ACT 74, Mich. P.A. 1970

For corners in <u>Osceola</u>	Located in:	Corner Code#
1. Public Land Survey	T 19 N R 10 W	C-4
	T	R
	T	R
	T	R
2. Property Controlling in Section	S T R	
	S T R	
3. Miscellaneous Property in Sec.	S T R	
	S T R	
4. Lot No. _____ Recorded Plat _____		
5. Private Claims _____		

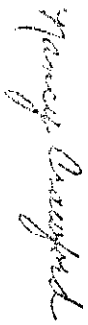
OSCEOLA COUNTY
REGISTER OF DEEDS
00 MAY -5 PM 2:51
 Register of Deeds Stamp & File Number

	A	B	C	D	E	F	G	H	I	J	K	L	M
1													
2	6	5	4	3	2	1							
3													
4	7	8	9	10	11	12							
5													
6	18	17	16	15	14	13							
7													
8	19	20	21	22	23	24							
9													
10	30	29	28	27	26	25							
11													
12	31	32	33	34	35	36							
13													

I, Robert L. Wetherell, in a field survey on April 4, 2000, do hereby certify that under requirements of P.A. 74, Michigan P.A. of 1970, the corner points mentioned in lines 1 and 2 above were in conformance with regulations and rules therefore as required in the current manual of survey instructions of the United States Department of the Interior, Bureau of Land Management or by decree of a Court of Law and/or that the corner points mentioned in lines 3, 4, and 5 above were in conformance with the rules of the Michigan Board of Land Surveyors or by a Decree Of a Court of Law; established, re-established, monumented, re-monumented, recovered, found as expressed below:

C-4 - 1/4 Corner common to Sections 7 & 8, T19N, R10W

A. Description of original monument and accessories and/or subsequent restoration:

1838 - S. Sibley, G.L.O.
#1 - 8" Hemlock S80°W 14 Links
#2 - 7" Sugar N64°E 30 Links

1919 - F. McClung, Co. Sur.
"Tile".
#3 - Post S82°E 25.2'
#4 - 4" Maple N36°E 20.3'

1997 - R.L. Wetherell, LS 24624
L.C.R.C. - Liber 03, Pg. 146
Found title and iron 4' E. of center of North and South Road.
#5 - 11" Cherry N58°W 44.06'
#6 - 12" W. Pine N79°E 82.51'
#7 - 6" Maple S74°E 60.84'
#8 - 10" W. Pine S7°E 67.24'

1891-1904 - Temple Trumbull
Remonumentation of T19N, R10W
Set 3" Clay Tiles.

B. Description of corner evidence found and/or method applied in restoring of reestablishing corner:

I found a 1/2" rod in center of 3" Clay tile 4 feet East of North and South road. Corner is 2 feet more or less North of fence lines running East and West.

Condition of the accessories are as follows: #1 Gone, #2 Gone, #3 New Post #4 Gone, #5 Found in good condition, #6 Found in good condition, #7 Found in good condition, #8 Found in good condition.

C. Description of monument for corner and accessories established to perpetuate locating the position of the corner:

I replaced the 1/2" iron in the center of the Tile with a 1" x 18" Iron Pipe with Osceola County Remon Cap, and is accepted as a careful and faithful reestablishment of the position of the original corner.

- 11" Cherry N58°W 44.06' (60d spike N.E. side) #5
- 12" W. Pine N79°E 82.51' (60d spike S. side) #6
- 6" Maple S74°E 60.84' (60d spike N. side) #7
- 10" W. Pine S07°E 67.24' (60d spike W. side) #8

APPROVED LAND CORNER
P.A. 74 OF 1970
Osceola County
R.L.W.
4-20-2000

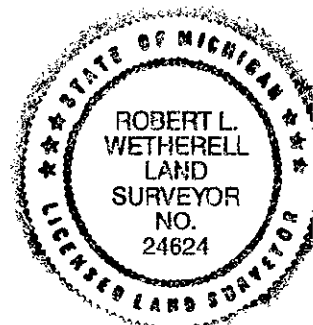

Signed by Robert L. Wetherell
Surveyor's Michigan License No. 24624

Date April 25, 2000