

SURVEY & REMONUMENTATION

DEC 13 2000

SECTION

LAND CORNER RECORDATION CERTIFICATE

FILING REQUIREMENT OF ACT 74, Mich. P.A. 1970

For corners in
Osceola

Located in: Corner Code#

- | | | | |
|--------------------------------------|--------|--------|------|
| 1. Public Land Survey | T 19 N | R 10 W | H-13 |
| | T | R | |
| | T | R | |
| | T | R | |
| 2. Property Controlling in Section | S T | R | |
| | S T | R | |
| 3. Miscellaneous Property in Sec. | S T | R | |
| | S T | R | |
| 4. Lot No. _____ Recorded Plat _____ | | | |
| 5. Private Claims _____ | | | |

Spencer Osceola

**OSCEOLA COUNTY
REGISTER OF DEEDS**

00 MAY -5 PM 2:51

Register of Deeds Stamp & File Number

I, Robert L. Wetherell, in a field survey on March 22, 2000, do hereby certify that under requirements of P.A. 74, Michigan P.A. of 1970, the corner points mentioned in lines 1 and 2 above were in conformance with regulations and rules therefore as required in the current manual of survey instructions of the United States Department of the Interior, Bureau of Land Management or by decree of a Court of Law and/or that the corner points mentioned in lines 3, 4, and 5 above were in conformance with the rules of the Michigan Board of Land Surveyors or by a Decree Of a Court of Law; established, re-established, monumented, re-monumented, recovered, found as expressed below:

	A	B	C	D	E	F	G	H	I	J	K	L	M
1													
2	6	5	4	3	2	1							
3													
4	7	8	9	10	11	12							
5													
6	18	17	16	15	14	13							
7													
8	19	20	21	22	23	24							
9													
10	30	29	28	27	26	25							
11													
12	31	32	33	34	35	36							
13													

H-13 - S. 1/4 Corner Section 34, T19N, R10W

A. Description of original monument and accessories and/or subsequent restoration:

1837 - J. Hodgson, G.L.O.

- #1 - 10" Beech N38°W 11 Links
- #2 - 7" Beech N65°E 24 Links

1976 - G. Gray, LS 17741

- L.C.R.C. - Liber 02, Pg. 116
- Survey recorded Liber 362, Pg. 582
- "Set 1/2" Iron by fence occupation".

1998 - R.L. Wetherell, LS 24624

- Found 3" Clay Tile 22.4 feet East of 1/4" rod (Gray's corner)
- No accessories given.

1891-1904 - Temple/Trumbull

- Remonumentation of T19N, R10W
- Set 3" Clay Tile.

- #3 - 24" Maple N45°W 76.20'
- #4 - Tw. 16" Maple North 104.60'
- #5 - 20" Maple S85°E 48.70'

B. Description of corner evidence found and/or method applied in restoring of reestablishing corner:

I found a 1/2" iron rod inside a 3" clay tile with cinders in an old East and West fence line. I found surveyor Gray's corner 22.4 feet West of the tile next to a fence post. I think the accessories on Gray's L.C.R.C. are not correct for this corner.

Condition of the accessories are as follows: #1 Gone, #2 Gone, #3 Gone, #4 Gone, #5 Gone.

C. Description of monument for corner and accessories established to perpetuate locating the position of the corner:

I set a 1" x 18" iron pipe with Osceola County Remon Cap in the center of the 3" tile, and is accepted as a careful and faithful reestablishment of the position of the original corner.

- 11" Maple S74°W 24.30' (60d spike S. side)
- 13" Tw. Maple N40°W 36.22' (60d spike S.W. side)
- 12" Maple N49°E 42.93' (60d spike S.E. side)
- 13" Maple S45°E 12.15' (60d spike S.W. side)
- Osceola County Monument West 5.45' (N. 1/4 Cor. Sec. 3, T18N, R10W)

APPROVED LAND CORNER
P.A. 345 OF 1090
Osceola County

R. L. W.

4-20-2000

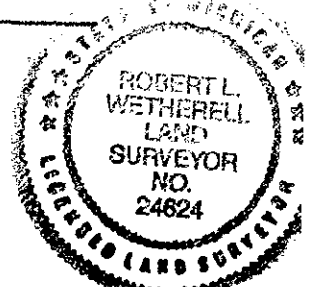

Signed by Robert L. Wetherell
Surveyor's Michigan License No. 24624

Date April 25, 2000

FORM APPROVED BY MICHIGAN STATE BOARD OF LAND SURVEYORS, JAN 28, 1971
REVISED MAY 14, 1975
REVISED JAN. 1983
ADAPTED FOR WORD PROCESSING JANUARY, 1989