

**SURVEY & REMONUMENTATION**

DEC 13 2000

**SECTION LAND CORNER RECORDATION CERTIFICATE**

FILING REQUIREMENT OF ACT 74, Mich. P.A. 1970

For corners in <u>Osceola</u>	Located in:	Corner Code#
1. Public Land Survey	T 19 N R 7 W	E-10
	T R	
	T R	
	T R	
2. Property Controlling in Section	S T R	
	S T R	
3. Miscellaneous Property in Sec.	S T R	
	S T R	
4. Lot No. _____ Recorded Plat _____		
5. Private Claims _____		

  
**OSCEOLA COUNTY REGISTER OF DEEDS**  
 00 MAY -5 PM 2:51  
 Register of Deeds Stamp & File Number

	A	B	C	D	E	F	G	H	I	J	K	L	M
1													
2	6	5	4	3	2	1							
3													
4	7	8	9	10	11	12							
5													
6	18	17	16	15	14	13							
7													
8	19	20	21	22	23	24							
9													
10	30	29	28	27	26	25							
11													
12	31	32	33	34	35	36							
13													

I, Robert L. Wetherell, in a field survey on March 29, 2000, do hereby certify that under requirements of P.A. 74, Michigan P.A. of 1970, the corner points mentioned in lines 1 and 2 above were in conformance with regulations and rules therefore as required in the current manual of survey instructions of the United States Department of the Interior, Bureau of Land Management or by decree of a Court of Law and/or that the corner points mentioned in lines 3, 4, and 5 above were in conformance with the rules of the Michigan Board of Land Surveyors or by a Decree Of a Court of Law; established, re-established, monumented, re-monumented, recovered, found as expressed below:

**E-10 - 1/4 Corner common to Sections 28 & 29, T19N, R7W**

**A. Description of original monument and accessories and/or subsequent restoration:**

**1856 - F. Coleman, G.L.O.**

- #1 - 20" Elm N47°E 49 Links
- #2 - 5" Beech S43°W (no distance)

**Undated Co. Sur. Twp., Book**

- #5 - 36" Pine N23 1/2°E 58 1/2 Links
- #6 - 36" Pine S11°E 62 Links

**1996 - R.L. Wetherell, LS 24624**

- Found 3" Clay Tile with Cinders. Added 1/2" Iron.
- #7 - 7" Maple N6°E 33.68'
- #8 - 8" W. Pine S5°E 42.33'
- #9 - 10" W. Birch S65°E 33.58'
- #10 - 5" Maple N61°W 43.86'

**1891-1904 - F. Trumbull Co. Sur.**

- Remonumentation of T19N R7W
- "Identified by Measurement".
- Set 3" Clay Tile with Cinders.
- #3 - 24" Pine Stump S48°E 144 Links
- #4 - 48" Pine Stump S37°W 84 5/6 Links

**B. Description of corner evidence found and/or method applied in restoring of reestablishing corner:**

I found the 1/2" Iron (I set in 1996) in center of a 3" Clay Tile. Corner is 2 feet North and 2 feet East of a corner Fence Post (fence running North and East).

Condition of the accessories are as follows: #1 Gone, #2 Gone, #3 Gone, #4 Gone, #5 Found Stump, #6 Found Stump, #7 Found in good condition, #8 Found in good condition, #9 Found in good condition, #10 Found in good condition.

**C. Description of monument for corner and accessories established to perpetuate locating the position of the corner:**

I replaced the 1/2" Iron with a 1" x 18" Pipe with Osceola County Remon Cap, and is accepted as a careful and faithful reestablishment of the position of the original corner.

- 7" Maple N6°E 33.68' (60d spike in W. side) #7
- 8" W. Pine S5°E 42.33' (60d spike in E. side) #8
- 10" W. Birch S65°E 33.58' (60d spike in N. side) #9
- 5" Maple N61°W 43.86' (60d spike S. side) #10

APPROVED LAND CORNER  
P.A. 345 OF 1990  
Osceola County

R. L. W.  
4-20-2000

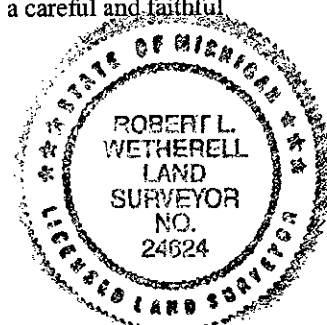

Signed by Robert L. Wetherell  
Surveyor's Michigan License No. 24624

Date April 25, 2000