

**SURVEY &
REMONUMENTATION**

NOV 01 1999

LAND CORNER RECORDATION CERTIFICATE
Filing Requirement of Act 74, Mich. P.A. 1970

SECTION

For corners in

Osceola

(County)

Located In:

Corner Code #

1. Public Land Survey

T19N 7W

H-9

| | | |
|---|---|-------|
| T | R | _____ |
| T | R | _____ |
| T | R | _____ |
| T | R | _____ |

2. Property Controlling in Section

| | | | |
|---|---|---|-------|
| S | T | R | _____ |
| S | T | R | _____ |

3. Miscellaneous Property in Sec.

| | | | |
|---|---|---|-------|
| S | T | R | _____ |
| S | T | R | _____ |

Register of Deeds Stamp & File Number

4. Lot No. _____, Recorded Plat _____
5. Private Claims _____

Robert L. Wetherell, in a field survey on Aug 12, 1999 do hereby state that under requirements of P.A. 74, Michigan P.A. of 1970, the corner points mentioned in lines 1 and 2 above were in conformance with regulations and rules therefore as required in the current manual of survey instructions of the United States Department of the Interior, Bureau of Land Management or by a decree of a Court of Law and /or that the corner points mentioned in lines 3, 4 and 5 above were in conformance with the rules of the Michigan Board of Land Surveyors or by a Decree of a Court of Law; established, re-established, monumented, recovered, found as expressed below:

NOTE: Not more than 2 corners, all in the same town and range, may be recorded on this certificate.

H-9 N ¼ Corner of Section 27, T19N, R7W

| | A | B | C | D | E | F | G | H | I | J | K | L | M |
|----|----|----|----|----|----|----|---|---|---|---|---|---|---|
| 1 | | | | | | | | | | | | | |
| 2 | 6 | 5 | 4 | 3 | 2 | 1 | | | | | | | |
| 3 | | | | | | | | | | | | | |
| 4 | 7 | 8 | 9 | 10 | 11 | 12 | | | | | | | |
| 5 | | | | | | | | | | | | | |
| 6 | 18 | 17 | 16 | 15 | 14 | 13 | | | | | | | |
| 7 | | | | | | | | | | | | | |
| 8 | 19 | 20 | 21 | 22 | 23 | 24 | | | | | | | |
| 9 | | | | | | | | | | | | | |
| 10 | 30 | 29 | 28 | 27 | 26 | 25 | | | | | | | |
| 11 | | | | | | | | | | | | | |
| 12 | 31 | 32 | 33 | 34 | 35 | 36 | | | | | | | |
| 13 | | | | | | | | | | | | | |

A. Description of original monument and accessories and/or subsequent restoration:

1856 - E. Coleman
#1-10" Beech N73W 63 Lks.
#2-14" Beech S47E 42 Lks

1891 - 1904 - A. Temple/F. Trumbull
Remonumentation of T19N, R7W
Set 3" Clay tiles

1946 Middle Branch Twp Book
Pages 32 & 33
#3 - 5= Tile & Iron, Rod & Stone
#4 - F. Post South 32.6'
#5- Church abutment NW 135.6'
#6- E ½ N. Line Sec 27 2608.05'
#7 - W ½ N Line Sec 27 2613.2'

(SEE OVER FOR CONTINUATION OF "A")

B. Description of corner evidence found and/or method applied in restoring or reestablishing corner:

Found Osceola County Monument in Tile & large rock to North. Corner in fence line North and South. And 2' North of C/L East and West Road.

Condition of the accessories are as follows: #1 Gone, #2Gone, #3 Found, #4 Found in good condition, #5 Gone. #6 Measured 2608.31'(1998), and #7 McClung measured 2613.38' in 1986.

C. Description of monument for corner and accessories established to perpetuate locating the position of the corner:

I accept Osceola County Monument (1 ½" Pipe with Osceola County Remon. Cap) as a substantial marker for the corner and is accepted as a careful and faithful reestablishment of the position of the original corner.

NE Corner Tele. Ped.S5W 31.5'
12" Pine (Nail in E. side) S13E 38.75'
14" Pine (Nail in S. side) N58W 58.95'
12" Pine (Nail in NE side) S55E 56.32'

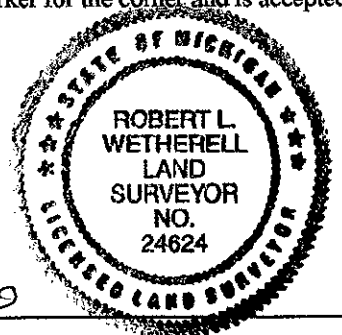

Signed by Robert L. Wetherell

Date 8-26-99

Surveyor's Michigan License No. 24624
APPROVED LAND CORNER
P.A. 345 OF 1990
Osceola County

R. L. W. 8-26-99

CONTINUATION OF DESCRIPTION OF ORIGINAL MONUMENT AND ACCESSORIES AND/OR SUBSEQUENT RETORATION.

1986 - McClung LS 13037

Survey record
L.451, Page 218
Shows Corner
No Witnesses

1986 - McClung LS 13037

Survey record
L. 451, Pg 215
Shows Corner
No Witnesses
#7- Shows W 1/2 North line as: 2613.38'

Wm. W. Crawford
99 SEP -3 AM 11:48
OSCEOLA COUNTY
REGISTER OF DEEDS

SURVEY &
REMONUMENTATION

NOV 01 1999

SECTION