

NOV 01 1999

SECTION

LAND CORNER RECORDATION CERTIFICATE
Filing Requirement of Act 74, Mich. P.A. 1970

For corners in
Osceola

Located In: Corner Code #

		19N 8W	B - 7
1. Public Land Survey	T	R	
	T	R	
	T	R	
	T	R	
2. Property Controlling in Section	S	T R	
	S	T R	
3. Miscellaneous Property in Sec.	S	T R	
	S	T R	

Register of Deeds Stamp & File Number

4. Lot No. _____, Recorded Plat _____
5. Private Claims _____

I, Robert L. Wetherell, in a field survey on Aug 11, 1999 do hereby state that under requirements of P.A. 74, Michigan P.A. of 1970, the corner points mentioned in lines 1 and 2 above were in conformance with regulations and rules therefore as required in the current manual of survey instructions of the United States Department of the Interior, Bureau of Land Management or by a decree of a Court of Law and /or that the corner points mentioned in lines 3, 4 and 5 above were in conformance with the rules of the Michigan Board of Land Surveyors or by a Decree of a Court of Law, established, re-established, monumented, recovered, found as expressed below:

NOTE: Not more than 2 corners, all in the same town and range, may be recorded on this certificate.

B-7 S 1/4 Corner of Section 18, T19N, R8W

	A	B	C	D	E	F	G	H	I	J	K	L	M
1													
2	6	5											
3													
4	7	8	9	10	11	12							
5													
6	18	17	16	15	14	13							
7	•												
8	19	20	21	22	23	24							
9													
10	30	29	28	27	26	25							
11													
12	31	32	33	34	35	36							
13													

A. Description of original monument and accessories and/or subsequent restoration:

1838 - Sibley
#1 8" Hemlock N64E 19 Lks.
#2 10" Hemlock S8W 18 Lks.

1891 - 1904 - A. Temple/F.Trumbull
Remonumentation of T19N, R8W
Set 3" Clay tiles

Undated - Hartwick Twp. Book
Set 1/4 18 & 19 Stake & Iron

(SEE OVER FOR CONTINUATION OF "A")

B. Description of corner evidence found and/or method applied in restoring or reestablishing corner:

Found McClung's Osceola County Monument.

Condition of the accessories are as follows: #1 Gone, #2 Gone, #3 Gone, #4 Gone, #5 Found in good condition (Maple Tree), #6 Gone (new pole), #7 Found in good condition, #8 Found in good condition, #9 Found in good condition and #10 Found in good condition. Also #11 Found in good condition, #12 Gone, #13 Found in good condition and #14 Found in good condition.

C. Description of monument for corner and accessories established to perpetuate locating the position of the corner:

I accept Osceola County Monument (1 1/2" Pipe with Osceola Remon Cap) as a substantial marker for the corner and is accepted it as a careful and faithful reestablishment of the position of the original corner.

- 12" Tr. Maple S40E 58.44 #14
- P. Pole S86E 98.69' #16
- 5/8" Iron S88E 86.42' #15
- Pk. Nail in top of culvert S83W 62.7' #19

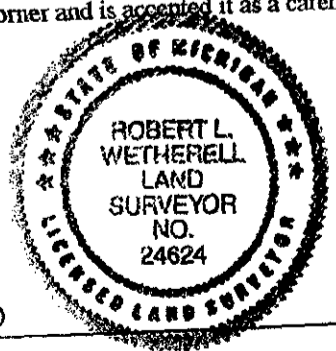

Signed by Robert L. Wetherell
Surveyor's Michigan License No. 24624

Date 8-26-99

APPROVED LAND CORNER
P.A. 345 OF 1990
Osceola County

R. L. W.
8-26-99

CONTINUATION OF DESCRIPTION OF ORIGINAL MONUMENT AND ACCESSORIES AND/OR SUBSEQUENT RETORATION.

1938- Hartwick Twp. Book

Pages 66 & 67
#3 - 3" Maple SW 46.1'
#4 - 8" Maple SE 50.1'
Distance East = 2679.'

1973- Gray LS 17741

LCRC
L.2, Pg. 117
Fd. Iron
#5 - 30" Oak S30E 58.0'
#6 - P. P. East 93.7'

1980 - McClung 13037

Survey
L 381, P 264
Fd. Iron
#3 - 3" Maple SW 46.1'
#4 - 8" Maple SE 50.1'

1983 - McClung 13037

Fd. Iron
Survey Record
L. 418, Pg. 55
#3 - 3" Maple SW 46.1'
#4 - 8" Maple SE 50.1'

1992 - McClung 13037

LCRC
L 3, Pg. 69
Fd. Iron & Tile
#6 - Utility Pole East 93.7'
#7 - I & C #13037 S89-41-51E 86.42'
#5- 30" Oak SSE 58.0'
8- Stone SE 63.0'
#9- Stone SSE 19'

1993- Smih LS 39098

LCRC
L3, Pg. 8282
Fd. 1" Pipe
#5 -Tri. 12" Maple S40E 58.44'
#7 - 5/8" Iron S88E 86.42'
#10 - Power Pole S86E 98.69'
#11 - 1/2" Iron & Cap S65E 36'
#12 - 1/2" Iron & Cap South 22.54'
#13 - Pk nail in top of culvert S83W 62.70'

1998 McClung LS 13037

Fd. Iron 1" Rod
Set Osceola County Monument
#14 - 12" Maple S66E 72.6'
#10 - P. Pole East 98.65'
#5 - 8" Triple Maple S44E 58.45'
#13 - Top Center Culvert S76W 62.6'

1998 Wetherell LS 24624

Fd. Osceola County Monument
#5 - 12" Tr. Maple S40E 58.44'
#10 - P. Pole S86E 98.69'
#7 - 5/8" Iron S88E 86.42'
#13 - Pk nail in top of culvert S83W 62.7'

W. Gray
OSCEOLA COUNTY
REGISTER OF DEEDS
99 SEP - 3 AM 11:48

SURVEY &
REMONUMENTATION

NOV 01 1999

SECTION