

NOV 01 1999

LAND CORNER RECORDATION CERTIFICATE  
Filing Requirement of Act 74, Mich. P.A. 1970

SECTION

For corners in  
Osceola

(County)	Located in:	Corner Code #
1. Public Land Survey	T <u>20N</u> 7W R _____	I-10
	T _____ R _____	_____
	T _____ R _____	_____
	T _____ R _____	_____
2. Property Controlling in Section	S _____ T _____ R _____	_____
	S _____ T _____ R _____	_____
3. Miscellaneous Property in Sec.	S _____ T _____ R _____	_____
	S _____ T _____ R _____	_____

Register of Deeds Stamp & File Number

4. Lot No. \_\_\_\_\_, Recorded Plat \_\_\_\_\_  
5. Private Claims \_\_\_\_\_

I, Robert L. Wetherell, in a field survey on Aug 12, 1999 do hereby state that under requirements of P.A. 74, Michigan P.A. of 1970, the corner points mentioned in lines 1 and 2 above were in conformance with regulations and rules therefore as required in the current manual of survey instructions of the United States Department of the Interior, Bureau of Land Management or by a decree of a Court of Law and /or that the corner points mentioned in lines 3, 4 and 5 above were in conformance with the rules of the Michigan Board of Land Surveyors or by a Decree of a Court of Law; established, re-established, monumented, recovered, found as expressed below:

NOTE: Not more than 2 corners, all in the same town and range, may be recorded on this certificate.

I-10 - E 1/4 Corner of Section 27, T20N, R7W

	A	B	C	D	E	F	G	H	I	J	K	L	M
1													
2	6		5		4		3		2		1		
3													
4	7		8		9		10		11		12		
5													
6	18		17		16		15		14		13		
7													
8	19		20		21		22		23		24		
9													
10	30		29		28		27		26		25		
11													
12	31		32		33		34		35		36		
13													

A. Description of original monument and accessories and/or subsequent restoration:

1856- F. Coleman  
#1- 12" Hemlock N59W 15 Lks.  
#2- 12" Beech S84E 25 Lks

1891 - 1904 - A. Temple/F.Trumbull  
Remonumentation of T20N, R7W  
Set 3" Clay tiles

1907 Marion Twp. Book  
Pages 42 & 43  
#3 Distance North = 2617.12  
Front Pages, page 7  
1/4 26 & 27 = Tile & rod

B. Description of corner evidence found and/or method applied in restoring or reestablishing corner:

(SEE OVER FOR CONTINUATION OF "A")

I found Osceola Co. Monument and tile. Corner is in Fence Row East & West & 1' West of C/L of Road to North and South.

Condition of the accessories are as follows: #1 Gone, #2 Gone, #3 Found in good condition, #4 Found in good condition, #5 Found in good condition and #6 Found in good condition.

C. Description of monument for corner and accessories established to perpetuate locating the position of the corner:

I accept the Osceola County Monument (1 1/2" Pipe with Osceola County Remon Cap) and tile as a substantial marker for the corner and is accepted it as a careful and faithful reestablishment of the position of the original corner.

Corner F. Post (Nail in N. side) S89E 36.55' #3  
6" Poplar (Nail in S. side) N75W 43.45' #4  
Treated F. Post (Nail in SW side) S40E 51.55' #5  
F. Post (Nail in NW side) N40E 64.2' #6

Signed by Robert L. Wetherell

Date 8-26-99

Surveyor's Michigan License No. 24624

APPROVED LAND CORNER  
P.A. 345 OF 1990  
Osceola County

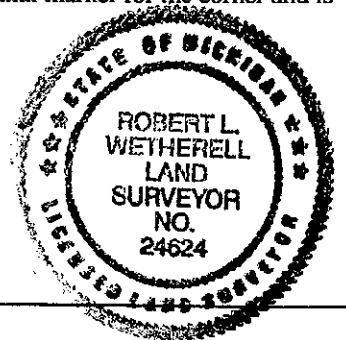

OSCEOLA COUNTY  
REGISTER OF DEEDS

99 SEP -3 AM 11:48

*Nancy Crawford*

CONTINUATION OF DESCRIPTION OF ORIGINAL MONUMENT AND ACCESSORIES AND/OR SUBSEQUENT RETORATION.

1998 - McClung LS 13037

Survey Record

L. 658, Pg. 804

Fd. 3/8" rod & Tile

Set Osceola County Monument

#3 - Corner F. Post (Nail in N. side) S89E 36.55'

#4 - 6" Poplar (Nail in S. side) N75W 43.45'

#5 - Treated F. Post (Nail in SW side) S40E 51.55'

#6 - F. Post (Nail in NW side) N40E 64.2'

SURVEY &  
REMONUMENTATION

NOV 01 1999

SECTION