

**SURVEY &
REMONUMENTATION**

SEP 29 1994

COMMISSION

**LAND CORNER RECORDATION CERTIFICATE
Filing Requirement of Act 74, Mich. P.A. 1970**

L 3 Pg 280

For corners in

Oscoda (County)	Located In:	Corner Code #
1. Public Land Survey	T <u>26N</u> R <u>2E</u>	D - 7
	T _____ R _____	_____
	T _____ R _____	_____
	T _____ R _____	_____
2. Property Controlling in Section	S _____ T _____ R _____	_____
	S _____ T _____ R _____	_____
3. Miscellaneous Property in Sec.	S _____ T _____ R _____	_____
	S _____ T _____ R _____	_____

STATE OF MICHIGAN
OSCODA COUNTY
FILED

14 SEP 94 11:07 A.M.

PATSY J. PETERS
REGISTER OF DEEDS

Register of Deeds Stamp & File Number

4. Lot No. _____, Recorded Plat _____
5. Private Claims _____

I, Marvin E. Myers, in a field survey on July 11, 19 94, do hereby certify that under requirements of P.A. 74, Michigan P.A. of 1970, the corner points mentioned in lines 1 and 2 above were in conformance with regulations and rules therefore as required in the current manual of survey instructions of the United States Department of the Interior, Bureau of Land Management or by a decree of a Court of Law and/or that the corner points mentioned in lines 3, 4 and 5 above were in conformance with the rules of the Michigan Board of Land Surveyors or by a Decree of a Court of Law; established, re-established, monumented, re-monumented, recovered, found as expressed below:

	A	B	C	D	E	F	G	H	I	J	K	L	M
2	6	5	4	3	2	1							
3													
4	7	8	9	10	11	12							
5													
6	18	17	16	15	14	13							
7		●											
8	19	20	21	22	23	24							
9													
10	30	29	28	27	26	25							
11													
12	31	32	33	34	35	36							
13													

NOTE: Not more than 4 corners, all in the same town and range, may be recorded on this certificate.

A. Description of original monument and accessories and/or subsequent restoration:

GLO-July 1839 Coon Mon-Post WIT: 14" W. Birch N74½°E 19 lks. 10" Beech S11°W 24 lks.	May 22, 1914 C.O. Seeley Mon-Remarkd Fd. US BT	GLO-1935 Guy Veal Mon-Fd. 1" Pipe set by Seeley from original BT replaced with 3½" Brass Tabliet 6" Dia. Conc. Mon. WIT: 24" W. Birch N74½°E 19 lks. 14" Sugar Maple S39½°W 43½ lks. 12" Beech N08½°W 78 lks. In Fence Cor. S & W
		L.2, pg.112 Oct. 1964 N. Caldwell Mon-Fd. US GLO Mon in Fence cor. WIT: 24" W. Birch (GLO) Stump S75°E 12.50' 20" Maple Stump (GLO) S40°W 28.70'

B. Description of corner evidence found and/or method applied in restoring or reestablishing corner:

Found US GLO Monument verified position and is accepted as a careful and faithful perpetuation of the position of the original corner.

APPROVED

County Remonumentation
Peer Review

NCC
27 AUG 94

C. Description of monument for corner and accessories established to perpetuate locating the position of the corner:

Mon-Fd. GLO Mon 1" E of Cor. Post. (fence N. S. E. & W).
(1" Pipe on N side of Mon.)
WIT: Nail SE root 12' Maple S55°W 17.02'
Nail E. 8" Maple S39°E 22.72'
Nail NW face 10" Maple N35°E 23.22'
Nail SE 20" Maple N42°W 11.77'

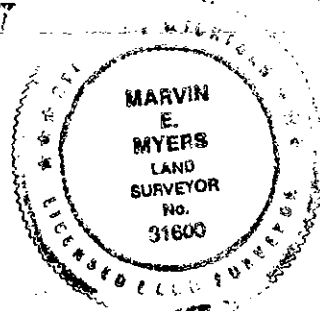

Signed by Marvin E. Myers

Date AUG 23, 1994

Surveyor's Michigan License No. 31600