

**SURVEY &
REMONUMENTATION**

SEP 29 1994

COMMISSION

**LAND CORNER RECORDATION CERTIFICATE
Filing Requirement of Act 74, Mich. P.A. 1970**

L3 Pg 286

For corners in

Oscoda (County)	Located In:	Corner Code #
1. Public Land Survey	T 26N R 2E	E-5
	T _____ R _____	_____
	T _____ R _____	_____
	T _____ R _____	_____
2. Property Controlling in Section	S _____ T _____ R _____	_____
	S _____ T _____ R _____	_____
3. Miscellaneous Property in Sec.	S _____ T _____ R _____	_____
	S _____ T _____ R _____	_____

STATE OF MICHIGAN
OSCODA COUNTY
FILED

14 SEP 94 11:09 A.M.

PATSY J. PETERS
REGISTER OF DEEDS

Register of Deeds Stamp & File Number

4. Lot No. _____, Recorded Plat _____
5. Private Claims _____

I, Marvin E. Myers, in a field survey on July 12, 19 94, do hereby certify that under requirements of P.A. 74, Michigan P.A. of 1970, the corner points mentioned in lines 1 and 2 above were in conformance with regulations and rules therefore as required in the current manual of survey instructions of the United States Department of the Interior, Bureau of Land Management or by a decree of a Court of Law and/or that the corner points mentioned in lines 3, 4 and 5 above were in conformance with the rules of the Michigan Board of Land Surveyors or by a Decree of a Court of Law; established, re-established, monumented, re-monumented, recovered, found as expressed below:

	A	B	C	D	E	F	G	H	I	J	K	L	M
2	6	5	4	3	2	1							
3													
4	7	8	9	10	11	12							
5													
6	18	17	16	15	14	13							
7													
8	19	20	21	22	23	24							
9													
10	30	29	28	27	26	25							
11													
12	31	32	33	34	35	36							
13													

NOTE: Not more than 4 corners, all in the same town and range, may be recorded on this certificate.

A. Description of original monument and accessories and/or subsequent restoration:

- GLO-1839 Coon
Mon-Post
Wit- 12" Spruce Pine N73°E 191ks
18" Spruce Pine S32°W 221ks
- 1888 Randall
Mon-Found U.S. Post
Found SW Stub legible
Found NE Hollow
Remarkd Corner
Wit-36" Y. Pine S58½°W 3.15
- May 1914 Seeley
Mon- 1½"x24" Pipe
at Post found by Randall
- GLO-Oct 1935 Guy Veal
Mon-6" Concrete monument with
3½" Brass tablet Fd. Seeley Pipe
Wit-8" B. Oak S76½°E 60 lks
10" B. Oak N61½°E 60 lks
8" B. Oak S15½°E 63½ lks
7" J. Pine N34°W 134 lks

B. Description of corner evidence found and/or method applied in restoring or reestablishing corner:

Found USGLO Monument verified position by measurement to accessories of record and is accepted as a careful and faithful perpetuation of the position of the original corner.

APPROVED
County Remonumentation
Peer Review Group

NCC
27 AUG 94

C. Description of monument for corner and accessories established to perpetuate locating the position of the corner:

- Mon-USGLO 6" concrete monument with 3½" Brass tablet with 1½" pipe 0.41 South for Magnetic attraction.
- Wit- Found 7" J. Pine N34°W (Now N26°W 134 lks (scribed stump visible)).
- 4" Polebarn nail in S. side 5" B. Oak S88°W 17.24
- 4" Polebarn nail in W. side 4" R. Pine N01°W 9.57
- 4" Polebarn nail in S. side 5" R. Pine N75°E 3.82
- 4" Polebarn nail in SW side 4" R. Pine S30°E 14.81

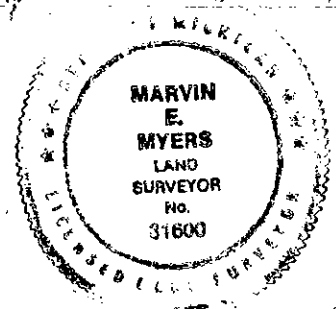

Signed by Marvin E. Myers
Surveyor's Michigan License No. 31600

Date AUG 23, 1994