

**SURVEY & REMONUMENTATION**

SEP 29 1994

COMMISSION

**LAND CORNER RECORDATION CERTIFICATE**  
Filing Requirement of Act 74, Mich. P.A. 1970

L3 Pg 287

For corners in

Oscoda (County)	Located In:	Corner Code -#
1. Public Land Survey	T 26N R 2E	E - 6
	T _____ R _____	_____
	T _____ R _____	_____
	T _____ R _____	_____
2. Property Controlling in Section	S _____ T _____ R _____	_____
	S _____ T _____ R _____	_____
3. Miscellaneous Property in Sec.	S _____ T _____ R _____	_____
	S _____ T _____ R _____	_____

STATE OF MICHIGAN  
OSCODA COUNTY  
FILED

14 SEP 94 11:09 A.M.

PATSY J. PETERS  
REGISTER OF DEEDS

Register of Deeds Stamp & File Number

4. Lot No. \_\_\_\_\_, Recorded Plat \_\_\_\_\_  
5. Private Claims \_\_\_\_\_

	A	B	C	D	E	F	G	H	I	J	K	L	M
2	6	5	4	3	2	1							
3													
4	7	8	9	10	11	12							
5													
6	18	17	16	15	14	13							
7													
8	19	20	21	22	23	24							
9													
10	30	29	28	27	26	25							
11													
12	31	32	33	34	35	36							
13													

I, Marvin E. Myers, in a field survey on July 11, 19 94, do hereby certify that under requirements of P.A. 74, Michigan P.A. of 1970, the corner points mentioned in lines 1 and 2 above were in conformance with regulations and rules therefore as required in the current manual of survey instructions of the United States Department of the Interior, Bureau of Land Management or by a decree of a Court of Law and/or that the corner points mentioned in lines 3, 4 and 5 above were in conformance with the rules of the Michigan Board of Land Surveyors or by a Decree of a Court of Law; established, re-established, monumented, re-monumented, recovered, found as expressed below:

**NOTE: Not more than 4 corners, all in the same town and range, may be recorded on this certificate.**

**A. Description of original monument and accessories and/or subsequent restoration:**

<p>GLO-July 1839 Coon Mon-Post WIT: 10" W. Birch N66½°E 4 lks. 8" W. Pine N55½°W 8½ ghs.</p> <p>May 1914 C.O. Seeley Mon-Set 1½"x2½" Pipe WIT: NBT 36" W. Pine N80½°E 1.67 chs.</p> <p>GLO-1935 Guy Veal Mon-3½" Dia. Brass Tablet in 6" Conc. Mon. WIT: 8" Poplar N38°E 56½ lks. 5" Birch N13 3/4°W 60 lks. Near C L M-72</p>	<p>Consumers Power Co. Files (MSHD 1958 MKW) Mon-US GLO WIT: 12" Birch N49°W 95.54' Driveshaft N14°W 40.20' 6" Birch N12°W 52.02' 6" Birch N26°W 69.10'</p> <p>L.2, pg.110 Apr. 1969 N.Caldwell Mon-MSHD Mon. Box US GLO replaced by MSHD road construction 1960</p>	<p>L.3, pg.17 July 1979 G.Henning Mon-Fd. US GLO Mon. WIT: 12" Birch N49°W 95.54' Driveshaft N14°W 40.20' 6" Birch N12°W 52.02' 6" Birch N26°E 69.10'</p> <p>LCRC L3, pg.248 Dec. 1993 C.Lindgren Mon-1½" Pipe in Mon Box on C L M-72 WIT: Nail &amp; Tag 10" W. Birch N35°W 121.4 Top Center R/W marker North 75.16' Nail &amp; Tag P.Pole N60°E 129.44' Nail &amp; Tag 6" Poplar S25°E 82.96'</p>
--	--	---

**B. Description of corner evidence found and/or method applied in restoring or reestablishing corner.**  
No evidence of Seeley pipe. Guy Veal reestablished position by proparate measure. Found 1½" pipe in Mon. Box verified position and is accepted as a careful and faithful reestablishment of the position of the original corner.

**APPROVED**  
County Remonumentation  
Peer Review Group

*NCC*  
*27 AUG 94*

**C. Description of monument for corner and accessories established to perpetuate locating the position of the corner:**

Mon-Fd. 1½" Pipe in Mon. Box  
WIT: Fd. R/W marker North 75.35'  
Fd. Nail & Tag SW 10" Birch N40°W 121.75'  
Fd. Nail SE Power Pole N60°E 129.22'  
Fd. Nail & Tag 6" above ground SW side 6" Poplar S25°E 83.20'

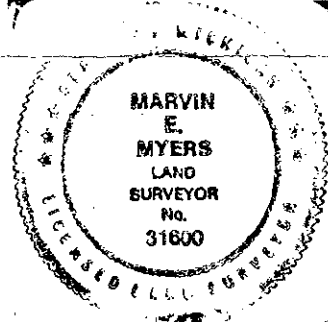

Signed by Marvin E. Myers Date AUG 23, 1994

Surveyor's Michigan License No. 31600