

OCT 08 1997

COMMISSION

LAND CORNER RECORDATION CERTIFICATE  
Filing Requirement of Act 74, Mich. P.A. 1970

*Liber 4 Page 186*

For corners in

<u>Oscoda</u> (County)	Located In:	Corner Code #
1. Public Land Survey	T27N R 3E	E-12
	T ___ R ___	_____
	T ___ R ___	_____
	T ___ R ___	_____
2. Property Controlling in Section	S ___ T ___ R ___	_____
	S ___ T ___ R ___	_____
3. Miscellaneous Property in Sec.	S ___ T ___ R ___	_____
	S ___ T ___ R ___	_____

STATE OF MICHIGAN  
OSCODA COUNTY  
FILED

29 AUG 97 9:13 A.M.

PATSY J. PETERS  
REGISTER OF DEEDS

Register of Deeds Stamp & File Number

4. Lot No. \_\_\_\_\_, Recorded Plat \_\_\_\_\_  
5. Private Claims \_\_\_\_\_

I, Marvin E. Myers, P.S., in a field survey on June 23, 1997 do hereby state that under requirements of P.A. 74, Michigan P.A. of 1970, the corner points mentioned in lines 1 and 2 above were in conformance with regulations and rules therefore as required in the current manual of survey instructions of the United States Department of the Interior, Bureau of Land Management or by a decree of a Court of Law and for that the corner points mentioned in lines 3, 4 and 5 above were in conformance with the rules of the Michigan Board of Land Surveyors or by a Decree of a Court of Law, established, re-established, monumented, recovered, found as expressed below:

NOTE: Not more than 2 corners, all in the same town and range, may be recorded on this certificate.

- A. Description of original monument and accessories and/or subsequent restoration:
 

GLO - Oct 1839 L. Clason, D.S. Mon - Post Wit: 4" Spruce Pine N84°E 102 Lks 4" Spruce Pine N23°W 90 Lks	LCRC L. 2, P 372 Caldwell, P.S. #12018 Jan 1971 Mon - Found record 1/2" pipe replaced with Std. Co. Corner. Wit: 12" J. Pine S85°W 58.2 1/2" Pipe East 33.00 1/2"x3/4" Bar West 33.00
Jan 9, 1891 J. Randall, Co. Surveyor Mon - Set Post single proportion. Wit: 4" Spruce Pine N40°W 23 Lks.	L 4, P. 113 F. King, P.S. #25852 Aug 26, 1986 Mon - Found Rec. Co. Bk 2, P372
	Feb 19, 1991 L. Beauregard, P.S. #18654 Mon - Existing Std. Co. Cor. Wit: 5" Norway East 38.81 Existing Iron West 33.00 6" Norway S45°E 44.97 4" J. Pine N85°W 44.6 (Placed nail in side of tree, typical)

1	A	B	C	D	E	F	G	H	I	J	K	L	M
2	6		5		4		3		2		1		
3													
4	7		8		9		10		11		12		
5													
6	18		17		16		15		14		13		
7													
8	19		20		21		22		23		24		
9													
10	30		29		28		27		26		25		
11													
12	31		32		33		34		35		36		

**APPROVED**

County Remonumentation  
Peer Review Group

*NCC/12 AUG 97*

- B. Description of corner evidence found and/or method applied in restoring or reestablishing corner:  
Found Standard Oscoda County Monument and all accessories recorded in L.2, P. 372 noted above; In line with fence line West.  
Found a 1" pipe S41°W 5.55 not of record appears to be new pipe and not the work of a Licensed Land Surveyor. Accepted the Standard Oscoda County Monument as a careful and faithful establishment of the position of the corner.

- C. Description of monument for corner and accessories established to perpetuate locating the position of the corner:

1/4 corner common to Sections 32 & 33, T27N, R3E  
 Mon - Standard Oscoda County Monument in centerline of N-S gravel road.  
 Wit: Spike in S. side 6" J. Pine N75°W 44.6  
 Spike in N. Side 8" J. Pine N67°E 34.45  
 Spike in E. Side 8" R. Pine S34°E 53.20  
 Spike in SE side 6" J. Pine S20W 95.83

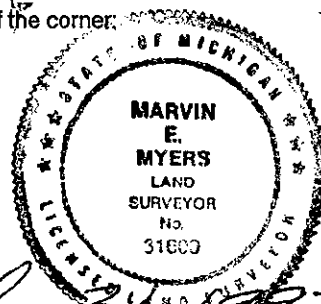

Signed by *Marvin E. Myers*  
Surveyor's Michigan License No. 31600

Date *July 31, 1997*