

SURVEY & REMONUMENTATION

OCT 08 1997

COMMISSION

LAND CORNER RECORDATION CERTIFICATE
 Filing Requirement of Act 74, Mich. P.A. 1970

Liber 4 Page 178

For corners in

<u>Oscoda</u> (County)	Located In:	Corner Code #
1. Public Land Survey	T <u>27N</u> R <u>3E</u>	<u>G-11</u>
	T <u> </u> R <u> </u>	<u> </u>
	T <u> </u> R <u> </u>	<u> </u>
	T <u> </u> R <u> </u>	<u> </u>
2. Property Controlling in Section	S <u> </u> T <u> </u> R <u> </u>	<u> </u>
	S <u> </u> T <u> </u> R <u> </u>	<u> </u>
3. Miscellaneous Property in Sec.	S <u> </u> T <u> </u> R <u> </u>	<u> </u>
	S <u> </u> T <u> </u> R <u> </u>	<u> </u>

STATE OF MICHIGAN
 OSCODA COUNTY
 FILED

29 AUG 97 9:05 A.M.

PATSY J. PETERS
 REGISTER OF DEEDS

Register of Deeds Stamp & File Number

4. Lot No. _____, Recorded Plat _____
 5. Private Claims _____

A	B	C	D	E	F	G	H	I	J	K	L	M
1												
2	6		5		4		3		2			1
3												
4	7		8		9		10		11			12
5												
6	18		17		16		15		14			13
7												
8	19		20		21		22		23			24
9												
10	30		29		28		27		26			25
11												
12	31		32		33		34		35			36
13												

P.S.
 I, Marvin E. Myers, in a field survey on April 1, 1997 do hereby state that under requirements of P.A. 74, Michigan P.A. of 1970, the corner points mentioned in lines 1 and 2 above were in conformance with regulations and rules therefore as required in the current manual of survey instructions of the United States Department of the Interior, Bureau of Land Management or by a decree of a Court of Law and /or that the corner points mentioned in lines 3, 4 and 5 above were in conformance with the rules of the Michigan Board of Land Surveyors or by a Decree of a Court of Law; established, re-established, monumented, recovered, found as expressed below:

NOTE: Not more than 2 corners, all in the same town and range, may be recorded on this certificate.

- A. Description of original monument and accessories and/or subsequent restoration:
- | | |
|---|--|
| GLO - Oct 1839 L. Clason, D.S.
Mon - Post
Wit: 8" Aspen S43°E 22 Lks
6" Aspen N40°W 12 Lks | June 15, 1916 C.O. Seeley, Co. Surveyor
Mon-Drove 1 1/4" pipe at stake
Wit: NBT 8" Oak N30 1/2°W 132 Lks |
| L. 1, P. 349 N. Caldwell, P.S. 7-31-1973
Mon- Found Seeley's pipe replaced
Std. Co. Mon.
Wit: 14" Y. Pine S60°W 138.6
14" Y. Pine N20°E 149.6 | L. 1, P. 488 N. Caldwell, P.S. #12018 Mar 27, 1974
Mon - Not Given
Wit - 1/2" bar East 33.00 |
| L3, P.473 L. Beauregard 8-23-1984
Mon- Existing Std. Co. Mon | L. 1, P. 228 N. C. Caldwell 9-25, 1979
Mon- Found 1 1/2" Pipe by Seeley, replaced with Std. Co. Mon.
Wit: 14" Y. Pine S60°W 138.6
14" Y. Pine N20°E 149.6
West 33.0 Fence in line with corner. |
| L.5, P. 7 L. G. Beauregard 4-26-1991
Mon - Existing Std. Co. Mon.
Wit: Fence Post S80°W 27.27
Fence Post S80°E 67.13
15' W. Pine N35°E 61.20 | |

APPROVED

County Remonumentation
 Peer Review Group

NCC/12 AUG 97

B. Description of corner evidence found and/or method applied in restoring or reestablishing corner:
 Found Std. Co. Mon. found fence post S74°W (recorded as S80°W) 27.27; found fence post S76°E (recorded as S80°E) 67.13; found 15" W. Pine N37°E (recorded as N35°E) 61.20; found 14" Y. Pine (Norway) N20°E 149.6; 14" Y. Pine (Norway) S60°W 138.6. Accepted Standard Oscoda County Monument as a perpetuation of the Original Government Corner.

C. Description of monument for corner and accessories established to perpetuate locating the position of the corner:

Section corner common to Sections 27, 28, 33, & 34, T27N, R3E
 Mon- Std co. Mon. Left in place in centerline of gravel road North
 Wit: Top Center of Hinge pin, West gate attached to Stone Pillar S19°E 92.45
 Fence post S74°W (recorded as S80°W) 27.27
 Fence post S76°E (recorded as S80°E) 67.13
 15" W. Pine N37°E (recorded as N35°E) 61.20
 14" Y. Pine (Norway) N20°E 149.6
 14" Y. Pine (Norway) S60°W 138.6

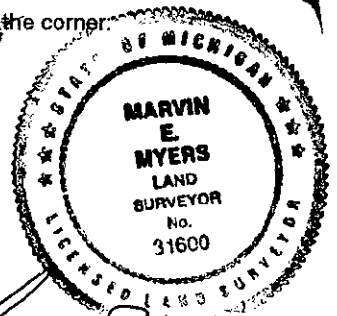

Signed by *Marvin E. Myers*
 Surveyor's Michigan License No. 31600

Date *July 31, 1997*