

MICHIGAN
DEPARTMENT OF CONSERVATION
FORESTRY DIVISION

LAND CORNER RECORD

T. 28 N.R. 1 E.

Oscoda COUNTY

DESCRIPTION OF CORNER Section corner common to Sections 31-32 on south boundary of township

CORNER MONUMENT Set 1" x 24" pipe

DATE MONUMENT PLACED AND WITNESSED August 24, 1962

WITNESSES TO CORNER.....

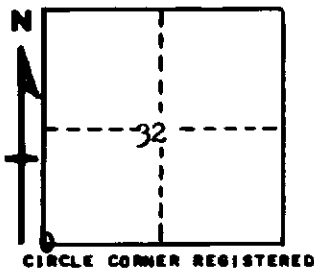

9" J. Pine N 38½ E 18.7'

8" J. Pine N 54 W 26.9'

AND

DESCRIPTION IN DETAIL AS TO HOW CORNER WAS LOCATED AND IDENTIFIED OR RESTORED.

This corner was found while making a survey of Section 32. Found 1/2" x 8" bolt at corner, as established by C. O. Seeley in 1915 at which time a U.S. BT was evident. His NBT stumps still in place.

Closing corner to Sections 5 - 6 T27NR1E is 39 links east.

SURVEYOR'S SEAL

SIGNED *Kenneth J. Ostling* DATE September 4, 1962
REGISTERED LAND SURVEYOR