

MICHIGAN  
DEPARTMENT OF CONSERVATION  
FORESTRY DIVISION

# LAND CORNER RECORD

T. 28 N.R. 2 E

OSCODA COUNTY

DESCRIPTION OF CORNER 1/4 corner on S. Side Sec. 33, T28N-R2E

CORNER MONUMENT Set DNR Monument below surface.

DATE MONUMENT PLACED AND WITNESSED 5-13-69

WITNESSES TO CORNER.....

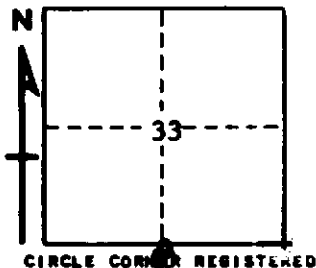

10" W. Pine N 16 E 63.8'

8" R. Pine N 17 W 71.1'

AND

DESCRIPTION IN DETAIL AS TO HOW CORNER WAS LOCATED AND IDENTIFIED OR RESTORED.

This corner was found during a retracement in this area. Found 1½" pipe in place, by Marcus Schaaf during 1930s. Stump remains in place for both U.S.B.T.s. Falls in center of E-W fireline.

SURVEYOR'S SEAL

SIGNED *Clarence H. Kellogg* DATE 6/9/69  
REGISTERED LAND SURVEYOR 10068