

MICHIGAN  
DEPARTMENT OF CONSERVATION  
FORESTRY DIVISION

LAND CORNER RECORD

T. 28 N.R. 1 W  
T. 29 N.R. 1 W Crawford  
Otsego COUNTY

DESCRIPTION OF CORNER Sec. corner common to sections 5-6-31-32

CORNER MONUMENT Set Cons. Dept. Mon.

DATE MONUMENT PLACED AND WITNESSED 5/7/68

WITNESSES TO CORNER.....

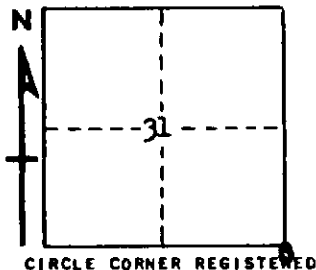

8" J. Pine	N 75 E	47.5
6" J. Pine	N 14 W	46.0
8" J. Pine	S 18 W	51.0

AND

DESCRIPTION IN DETAIL AS TO HOW CORNER WAS LOCATED AND IDENTIFIED OR RESTORED.

This corner was restored by double proportionate measurement between existing corners one mile in each direction. This method was used in recognition of the total measurement available between corners, rather than single proportionate method, which would place a considerable overrun in Section 5 at the expense of Section 32.

An iron post, possibly placed in some unrecorded survey was found at the approximate longitude of our corner, but some two chains north, but was considered unacceptable because of the inequitable distribution of lands in Sections 5 and 32.

SURVEYOR'S SEAL

SIGNED *Kimberly A. Estley* DATE 5/10/68  
REGISTERED LAND SURVEYOR #10068