

FEB 24 2000

RECORDED

99 DEC -2 PM 1:13

OTTAWA COUNTY REMONUMENTATION  
LAND CORNER RECORDATION CERTIFICATE  
Filing Requirement of Act 74, Mich. P.A. 1970

*[Signature]*  
REGISTER OF DEEDS  
OTTAWA COUNTY MI

For corners in

OTTAWA

(County)

Located In:

Corner Code #

1. Public Land Survey

T5N R 13W A-6, W 1/4 corner  
T R Section 18,  
T R Jamestown Twp  
T R

2. Property Controlling in Section

S T R  
S T R  
S T R  
S T R

3. Miscellaneous Property in Sec.

4. Lot No. \_\_\_\_\_, Recorded Plat \_\_\_\_\_  
5. Private Claims \_\_\_\_\_

Register of Deeds Stamp & File Number

I, Randal J. Vugteveen, in a field survey on September 27, 1999 do hereby state that under requirements of P.A. 74, Michigan P.A. of 1970, the corner points mentioned in lines 1 and 2 above were in conformance with regulations and rules therefore as required in the current manual of survey instructions of the United States Department of the Interior, Bureau of Land Management or by a decree of a Court of Law and /or that the corner points mentioned in lines 3, 4 and 5 above were in conformance with the rules of the Michigan Board of Land Surveyors or by a Decree of a Court of Law; established, re-established, monumented, recovered, found as expressed below:

NOTE: Not more than 2 corners, all in the same town and range, may be recorded on this certificate.

	A	B	C	D	E	F	G	H	I	J	K	L	M
1													
2	6	5	4	3	2	1							
3													
4	7	8	9	10	11	12							
5													
6	18	17	16	15	14	13							
7													
8	19	20	21	22	23	24							
9													
10	30	29	28	27	26	25							
11													
12	31	32	33	34	35	36							
13													

A. Description of original monument and accessories and/or subsequent restoration:

A-6 This corner was not set by GLO

11/15/99  
YDZ

B. Description of corner evidence found and/or method applied in restoring or reestablishing corner:

A-6 June 13, 1999 Found "T" Iron 46.34' South of M-6 Remon Corner and 0.03' West of Township line

MVK Capped Iron East 32.93'

A-5 Jamestown Twp North 2664.12'

A-7 Jamestown Twp South 2664.39'

(See sketch on back)

This position not established by original government surveyors. Accepted "T" Iron as the best available evidence of the position of the corner.

Replaced "T" Iron with a 3/4" X 24" long solid iron bar with remon cap on Town line.

C. Description of monument for corner and accessories established to perpetuate locating the position of the corner:

A-6 3/4" X 24" Iron Bar with Remon Cap

Set Nail & Remon Tag in S side Guy Pole N66°E 32.35'

Set Nail & Remon Tag in S side P. Pole N59°W 35.12'

Found Nail & Remon Tag in N side P. Pole N79°W 153.08'

Set PK with Remon Tag in top of 72" Corrugated Metal Pipe N13°E 156.06'

Remon Bar and cap (M-6 Zeeland Twp) North 46.34'

On centerline gravel (to be paved October 1999)

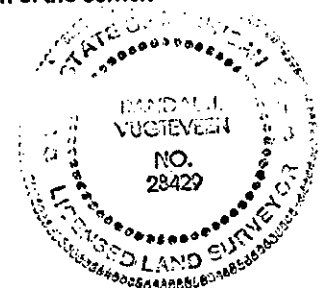

\$11.00 CORNER  
Receipt #64945

Signed by *[Signature]*  
Surveyor's Michigan License No. 28429

Date OCTOBER 27, 1999

FEB 24 2000

SECTION

Sept 27, 1999

Section 13  
Zeeland Twp.

Section 18,  
James town Twp

