

OTTAWA COUNTY REMONUMENTATION

LAND CORNER RECORDATION CERTIFICATE
Filing Requirement of Act 74, Mich. P.A. 1970

For corners in
Ottawa
(County)

Located In: Jamestown Twp. Corner Code # D-9, N1/4 cor.
5N 13W
Sec. 29

1. Public Land Survey	T	R	
	T	R	
	T	R	
	T	R	
2. Property Controlling in Section	S	T	R
	S	T	R
3. Miscellaneous Property in Sec.	S	T	R
	S	T	R

RECORDED

96 DEC 17 AM 10:43

R. D. Feenstra
REGISTER OF DEEDS
OTTAWA COUNTY, MI

Register of Deeds Stamp & File Number

4. Lot No. _____, Recorded Plat _____
5. Private Claims _____

I, Randal D. Feenstra, in a field survey on Sept 18, 19 96 do hereby state that under requirements of P.A. 74, Michigan P.A. of 1970, the corner points mentioned in lines 1 and 2 above were in conformance with regulations and rules therefore as required in the current manual of survey instructions of the United States Department of the Interior, Bureau of Land Management or by a decree of a Court of Law and /or that the corner points mentioned in lines 3, 4 and 5 above were in conformance with the rules of the Michigan Board of Land Surveyors or by a Decree of a Court of Law, established, re-established, monumented, recovered, found as expressed below:

A	B	C	D	E	F	G	H	I	J	K	L	M
1												
2	6		5		4		3		2		1	
3												
4	7		8		9		10		11		12	
5												
6	10		17		16		15		14		13	
7												
8	19		20		21		22		23		24	
9												
10	30		29		28		27		26		25	
11												
12	31		32		33		34		35		36	
13												

NOTE: Not more than 2 corners, all in the same town and range, may be recorded on this certificate.

A. Description of original monument and accessories and/or subsequent restoration:

G.I.O. Hardwood Post	L-3, P 142 Bt. Spk.		
Lucius Lyons, (1832)	NW Cor Bldg. Fndn	SE	59.28'
15" Sugar N51°W 19 lks	SE Cor Bldg. Fndn	NNE	47.41'
6" Beech S63°E 14 lks	Pk in side P. Pole	WNW	51.54'

P.A. 343 OTTAWA COUNTY
PEER APPROVED 11-11-96

R. D. Feenstra

B. Description of corner evidence found and/or method applied in restoring or reestablishing corner:

D-9 Found: Bt. Spk. in bit. road			
SE Cor Bldg. Fndn.	Az	15°	47.48'
Ottawa County Remon Nail & Tag N Side 40" Maple	Az	102°	106.42'
Pk and Ottawa County Remon Tag N side P. Pole	Az	259°	92.40'
Pk and Ottawa County Remon Tag N side P. Pole	Az	296°	51.44'

Accepted as a careful and faithful perpetuation of the position of the original corner

C. Description of monument for corner and accessories established to perpetuate locating the position of the corner:

D-9 Set Ottawa County Rod and Cap in Monument Box			
SE Cor. Bldg. Fndn.	Az.	15°	47.48'
Ottawa County Remon Tag & Nail N side 40" Maple	Az.	102°	106.42'
Ottawa County Remon Tag & Nail N side P. Pole	Az.	259°	92.40'
Ottawa County Remon Tag & Nail N side P. Pole	Az.	296°	51.44'
Centerline E/W Bit. Road N 4' (Perry St.)			
Centerline Bit. Road to S W 2' (36th Ave.)			
On tree row to N			

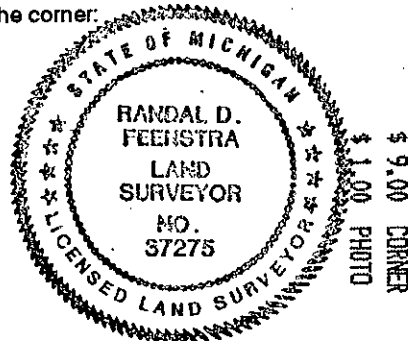

Signed by *Randal D. Feenstra*
Surveyor's Michigan License No. 37275

Date October 10, 1996