

SURVEY & REMONUMENTATION

DEC 1 6 1996

OTTAWA COUNTY REMONUMENTATION

COMMISSION

LAND CORNER RECORDATION CERTIFICATE
Filing Requirement of Act 74, Mich. P.A. 1970

For corners in

Ottawa (County)	Located In:	Corner Code #
1. Public Land Survey	Jamestown Twp. T <u>5N</u> R <u>13W</u>	D-11, S1/4 cor. Sec. 29
2. Property Controlling in Section	S <u> </u> T <u> </u> R <u> </u>	
3. Miscellaneous Property in Sec.	S <u> </u> T <u> </u> R <u> </u>	

RECORDED
96 NOV 14 AM 11:21
Randal D. Feenstra
REGISTER OF DEEDS
OTTAWA COUNTY, MI
Register of Deeds Stamp & File Number

4. Lot No. _____, Recorded Plat _____
5. Private Claims _____

I, Randal D. Feenstra, in a field survey on Oct 10, 1996 do hereby state that under requirements of P.A. 74, Michigan P.A. of 1970, the corner points mentioned in lines 1 and 2 above were in conformance with regulations and rules therefore as required in the current manual of survey instructions of the United States Department of the Interior, Bureau of Land Management or by a decree of a Court of Law and /or that the corner points mentioned in lines 3, 4 and 5 above were in conformance with the rules of the Michigan Board of Land Surveyors or by a Decree of a Court of Law; established, re-established, monumented, recovered, found as expressed below:

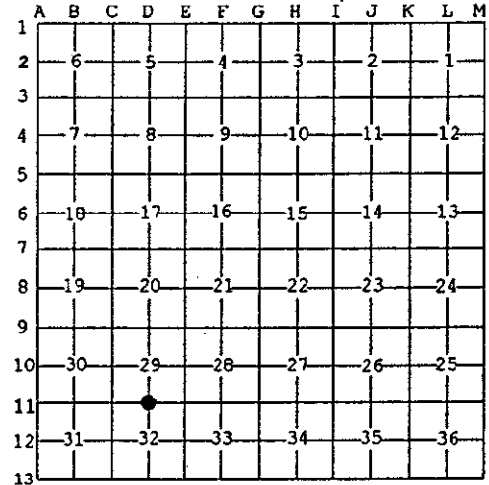

NOTE: Not more than 2 corners, all in the same town and range, may be recorded on this certificate.

A. Description of original monument and accessories and/or subsequent restoration:

G.L.O. Post Lucius Lyons, (1832) 6" Beech N77°W 27 lks 9" Beech N40°E 10 lks	L-3, P-43, Rerod in Monument Box PK in side P. Pole SW 61.91' PK in side P. Pole NW 81.80" Center St. sign NE 41.7'	L-3, P-76, Monument Box & Iron Bar Road Sign N45°W 39.22' P. Pole N45°W 81.95' P. Pole S45°W 62.00' W. Cherry N25°W 77.54'	L-5, P-189 Cast Iron Monument Fence Post NW 38.54' St. Sign NE 44.13' Cable Mar. SE 32.99' P. Pole SW 61.85'
---	--	--	---

B. Description of corner evidence found and/or method applied in restoring or reestablishing corner:
D-11 Found: Cast Iron Monument in Monument Box in Paved Road

St. Sign	Az. 46°	44.3'
Nail in NW side P. Pole	Az. 227°	63.36'
PK & Tag in SW side P. Pole	Az. 324°	81.94'

P.A. 345 OTTAWA COUNTY
PEER APPROVED 10-21-96
R. D. F.

Accepted as a careful and faithful perpetuation of the position of the original corner

C. Description of monument for corner and accessories established to perpetuate locating the position of the corner:

D-11 Cast Iron Monument in Box		
Nail and Ottawa County Remon Tag in NW side 15" Maple	Az. 48°	60.74'
Nail and Ottawa County Remon Tag in E side 12" Stump	Az. 179°	31.63'
Nail and Ottawa County Remon Tag in NW side P. Pole	Az. 227°	63.36'
Nail and Ottawa County Remon Tag in SW side P. Pole	Az. 324°	81.94'
Centerline E/W Paved Road, Adams St. N 0.7'		on tree row to S
Centerline Gravel road to N (36th Ave.) 4'E		

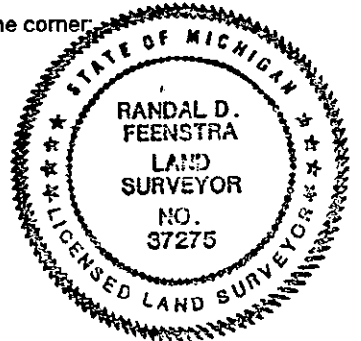

Signed by Randal D. Feenstra
Surveyor's Michigan License No. 37275

Date October 10, 1996