

OTTAWA COUNTY REMONUMENTATION

LAND CORNER RECORDATION CERTIFICATE
Filing Requirement of Act 74, Mich. P.A. 1970

For corners in

Ottawa

(County)

Located In:

Corner Code #

		Jamestown Twp.		
		5N	13W	
1. Public Land Survey	T	R		I-6, E 1/4 cor.
	T	R		Sec. 15
	T	R		
	T	R		
2. Property Controlling in Section	S	T	R	
	S	T	R	
3. Miscellaneous Property in Sec.	S	T	R	
	S	T	R	

RECORDED

96 DEC 17 AM 10:43

Randy D. Feenstra
REGISTER OF DEEDS
OTTAWA COUNTY, MI

Register of Deeds Stamp & File Number

4. Lot No. _____, Recorded Plat _____
5. Private Claims _____

I, Randal D. Feenstra, in a field survey on Oct. 10, 1996 do hereby state that under requirements of P.A. 74, Michigan P.A. of 1970, the corner points mentioned in lines 1 and 2 above were in conformance with regulations and rules therefore as required in the current manual of survey instructions of the United States Department of the Interior, Bureau of Land Management or by a decree of a Court of Law and/or that the corner points mentioned in lines 3, 4 and 5 above were in conformance with the rules of the Michigan Board of Land Surveyors or by a Decree of a Court of Law; established, re-established, monumented, recovered, found as expressed below:

NOTE: Not more than 2 corners, all in the same town and range, may be recorded on this certificate.

1	A	B	C	D	E	F	G	H	I	J	K	L	M
2		6		5		4		3		2		1	
3													
4		7		8		9		10		11		12	
5													
6		10		17		16		15		14		13	
7													
8		19		20		21		22		23		24	
9													
10		30		29		28		27		26		25	
11													
12		31		32		33		34		35		36	
13													

A. Description of original monument and accessories and/or subsequent restoration:

G.L.O. Hardwood Post	L-3, P-327, "L" Iron	L-6, P-170
Lucius Lyons 1832	"X" on S end conc. dr. culvert	NNW 61.75' Cast Iron Monument
6" Beech S59°E 19 lks.	"X" on S end conc. dr. culvert	NNE 52.67' Fence Post SW 43.15'
8" Beech N20°W 24 lks	"X" on S end conc. dr. culvert	SSW 37.64' P. Pole Pk Nail WNW 27.27'
	Nail on N side P. Pole	WNW 27.30' P. Pole Pk Nail ENE 32.16'
	CL Gravel East 3'	Pk Nail in Bit. dr. NW 73.12'

B. Description of corner evidence found and/or method applied in restoring or reestablishing corner:

I-6 Found: Broken Cast Iron Monument

P. Pole Pk WNW 27.18'
P. Pole Pk ENE 32.22'
Pk in Bit. dr. NW 73"±

Accepted as a careful and faithful perpetuation of the position of the original corner.

P.A. 540 OTTAWA COUNTY
PEER APPROVED 11-11-96
R.D.F.

C. Description of monument for corner and accessories established to perpetuate locating the position of the corner:

I-6 Broken Cast Iron Monument in Gravel Rd.
Ottawa County Remon Nail & Tag in W side P. Pole N 9°E 214.92'
Ottawa County Remon Nail & Tag in S side P. Pole N 74°E 32.22'
Ottawa County Remon Nail & Tag in N side P. Pole N 72°W 27.18'
"X" in N. End 12" conc. culv. S 6°W 181.47'
Centerline 16th Ave. (Gravel Rd.) 3.5'E

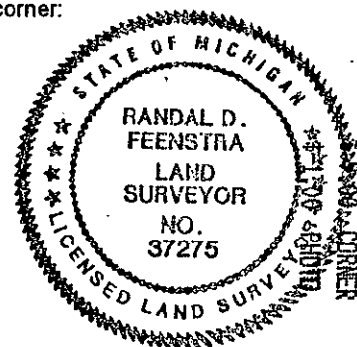

Signed by *Randal D. Feenstra*
Surveyor's Michigan License No. 37275

Date October 10, 1996