

SURVEY & REMONUMENTATION

DEC 1 8 1996

COMMISSION

OTTAWA COUNTY REMONUMENTATION

LAND CORNER RECORDATION CERTIFICATE
Filing Requirement of Act 74, Mich. P.A. 1970

For corners in

Ottawa (County)	Located In:	Corner Code #
1. Public Land Survey	Jamestown Twp. 5N 13W	J-13, S1/4 cor. Sec. 35
	T ___ R ___	_____
	T ___ R ___	_____
	T ___ R ___	_____
2. Property Controlling in Section	S ___ T ___ R ___	_____
	S ___ T ___ R ___	_____
3. Miscellaneous Property in Sec.	S ___ T ___ R ___	_____
	S ___ T ___ R ___	_____

RECORDED

96 NOV 14 AM 11:21

Randal D. Feenstra
REGISTER OF DEEDS
OTTAWA COUNTY, MI

Register of Deeds Stamp & File Number

4. Lot No. _____, Recorded Plat _____
5. Private Claims _____

I, Randal D. Feenstra, in a field survey on Oct 10, 1996 do hereby state that under requirements of P.A. 74, Michigan P.A. of 1970, the corner points mentioned in lines 1 and 2 above were in conformance with regulations and rules therefore as required in the current manual of survey instructions of the United States Department of the Interior, Bureau of Land Management or by a decree of a Court of Law and /or that the corner points mentioned in lines 3, 4 and 5 above were in conformance with the rules of the Michigan Board of Land Surveyors or by a Decree of a Court of Law; established, re-established, monumented, recovered, found as expressed below:

	A	B	C	D	E	F	G	H	I	J	K	L	M
1													
2	6	5	4	3	2	1							
3													
4	7	8	9	10	11	12							
5													
6	18	17	16	15	14	13							
7													
8	19	20	21	22	23	24							
9													
10	30	29	28	27	26	25							
11													
12	31	32	33	34	35	36							
13													

NOTE: Not more than 2 corners, all in the same town and range, may be recorded on this certificate.

A. Description of original monument and accessories and/or subsequent restoration:

G.L.O. Hardwood Post Lucius Lyons, (1831) 25" Sugar N60°E 2 lks 18" Sugar N85.5°W 57 lks	P-5, (1979) C.P. Nail and Tag on Hickory Nail and Tag on 9" W. Cherry Iron	NE 32.38' N 50.7' E 21.72'
---	---	----------------------------------

P.A. 345 OTTAWA COUNTY
PEER APPROVED 10-21-96
[Signature]

B. Description of corner evidence found and/or method applied in restoring or reestablishing corner:

J-13 Found: 2" Round Iron

Iron E 21.74'

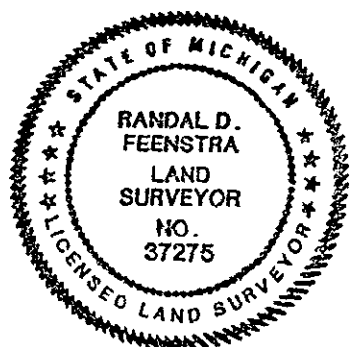

Accepted as a careful and faithful perpetuation of the position of the original corner

C. Description of monument for corner and accessories established to perpetuate locating the position of the corner:

J-13 Set Ottawa County Remon Bar and Cap 0.8' below gravel road	Az. 11°	37.54'
Nail and Ottawa County Remon Tag E side 10" Elm	Az. 102°	115.58'
Nail and Ottawa County Remon Tag N side 24" Walnut	Az. 195°	124.12'
NW cor. barn fndn.	Az. 258°	78.66'
"X" cut on top conc. headwall W end culv.		
Centerline gravel road to S and W, 2' N of Ottagan St., on tree row to N		
"T" Iron E 21.89'		

Signed by *Randal D. Feenstra*
Surveyor's Michigan License No. 37275

Date October 10, 1996