

OTTAWA COUNTY REMONUMENTATION

RECORDED

LAND CORNER RECORDATION CERTIFICATE
Filing Requirement of Act 74, Mich. P.A. 1970

96 DEC 18 PM 4:56

For corners in
Ottawa

Randal D. Feenstra
REGISTER OF DEEDS
OTTAWA COUNTY, MI

Located In:	Corner Code #
Jamestown Twp.	M-5, SE cor.
T <u>5N</u> R <u>13W</u>	Sec. 12
T _____ R _____	_____
T _____ R _____	_____
T _____ R _____	_____
S _____ T _____ R _____	_____
S _____ T _____ R _____	_____
S _____ T _____ R _____	_____
S _____ T _____ R _____	_____

Register of Deeds Stamp & File Number

4. Lot No. _____, Recorded Plat _____
5. Private Claims _____

	A	B	C	D	E	F	G	H	I	J	K	L	M
1													
2	6		5		4		3		2		1		
3													
4	7		8		9		10		11		12		
5													
6	18		17		16		15		14		13		
7													
8	19		20		21		22		23		24		
9													
10	30		29		28		27		26		25		
11													
12	31		32		33		34		35		36		
13													

I, Randal D. Feenstra, in a field survey on Dec. 9, 1996 do hereby state that under requirements of P.A. 74, Michigan P.A. of 1970, the corner points mentioned in lines 1 and 2 above were in conformance with regulations and rules therefore as required in the current manual of survey instructions of the United States Department of the Interior, Bureau of Land Management or by a decree of a Court of Law and /or that the corner points mentioned in lines 3, 4 and 5 above were in conformance with the rules of the Michigan Board of Land Surveyors or by a Decree of a Court of Law; established, re-established, monumented, recovered, found as expressed below:

NOTE: Not more than 2 corners, all in the same town and range, may be recorded on this certificate.

A. Description of original monument and accessories and/or subsequent restoration:

G.L.O. Post	L-2, P-830, Iron		
Lucius Lyons, (1831)	"X" Cut on North End of Concrete Culvert	NW	35.19'
12" Elm N73°W 65 lks.	"X" Cut on South End of Concrete Culvert	SW	36.72'
10" Elm S22°W 35 lks.	End of Road Sign	SE	11.25'

From Kent County L.C.R.C #5703 Ottawa County Corner is South 164.88' from Kent County Monument

B. Description of corner evidence found and/or method applied in restoring or reestablishing corner:

M-5 Found: Rerod with Cap
Found Kent County Monument (A-5 Byron Twp.) N 164.88'

P.A. 345 OTTAWA COUNTY
PEER APPROVED 12-9-96

R. D. Feenstra

Accepted as a careful and faithful perpetuation of the position of the original corner

C. Description of monument for corner and accessories established to perpetuate locating the position of the corner.

M-5 Set Remon Bar and Cap in New Monument Box (See Sketch on Back)		
"X" Cut in North End Concrete Culvert	Az. 317°	41.34'
"X" Cut in South End Concrete Culvert	Az. 217°	43.07'
"X" Cut in West End Concrete Culvert	Az. 354°	134.47'
"X" Cut in East End Concrete Culvert	Az. 17°	112.24'
Centerline N/S Bit. Road	E 3.5' (Kenowa Ave.)	
on Centerline Bit. Road to W (Riley St.)		
Kent County Monument (A-5 Byron Twp.)	N 164.88'	

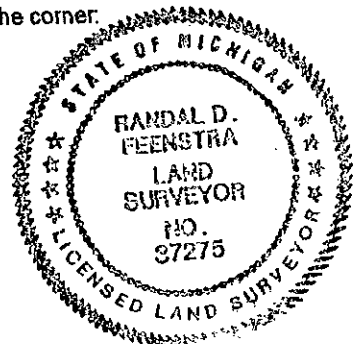

Signed by *Randal D. Feenstra*
Surveyor's Michigan License No. 37275

Date December 9, 1996

