

FEB 24 2000

OTTAWA COUNTY REMONUMENTATION
LAND CORNER RECORDATION CERTIFICATE
Filing Requirement of Act 74, Mich. P.A. 1970

RECORDED
99 SEP 23 PM 3: 21

Dany Subella
REGISTER OF DEEDS
OTTAWA COUNTY, MI

SECTION

For corners in

Ottawa
(County)

Located In: Zeeland Township
Corner Code #

1. Public Land Survey	T <u>5</u> N R <u>14</u> W	B-3
	T <u> </u> R <u> </u>	N 1/4 Corner
	T <u> </u> R <u> </u>	Section <u>7</u>
	T <u> </u> R <u> </u>	
2. Property Controlling in Section	S <u> </u> T <u> </u> R <u> </u>	
	S <u> </u> T <u> </u> R <u> </u>	
3. Miscellaneous Property in Sec.	S <u> </u> T <u> </u> R <u> </u>	
	S <u> </u> T <u> </u> R <u> </u>	

Register of Deeds Stamp & File Number

4. Lot No. _____, Recorded Plat _____
5. Private Claims _____

I, Rodney D. Unema, in a field survey on August 27, 1999 do hereby state that under requirements of P.A. 74, Michigan P.A. of 1970, the corner points mentioned in lines 1 and 2 above were in conformance with regulations and rules therefore as required in the current manual of survey instructions of the United States Department of the Interior, Bureau of Land Management or by a decree of a Court of Law and/or that the corner points mentioned in lines 3, 4 and 5 above were in conformance with the rules of the Michigan Board of Land Surveyors or by a Decree of a Court of Law; established, re-established, monumented, recovered, found as expressed below:

NOTE: Not more than 2 corners, all in the same town and range, may be recorded on this certificate.

A	B	C	D	E	F	G	H	I	J	K	L	M
1												
2	6	5	4	3	2	1						
3												
4	7	8	9	10	11	12						
5												
6	16	17	16	15	14	13						
7												
8	19	20	21	22	23	24						
9												
10	30	29	28	27	26	25						
11												
12	31	32	33	34	35	36						
13												

A. Description of original monument and accessories and/or subsequent restoration:

B-3 1/4 Corner between Sections 6 and 7:
April, 1832 G.L.O. Survey by C. Britain
Set 1/2 mile post
24" Hemlock N61°E 30 links
4" Beech S39°W 10 links
Feb. 10, 1973 (John Clapp)
Liber 2, page 47
Found bent pipe, set steel bar
St sign SE 25.57'
Twin 18" Sycamore NW 81.25'
8" Ash S 47.05'
MBT Box SW 41.80'

Sept. 24, 1982 (Thomas Joiner)
Liber 4, page 342
Set cast iron monument
10" Ash S 47.09'
Twin 8" Sycamore NNW 82.34'
Street sign S 25.49'
Tele. Ped. SSW 41.88'

B. Description of corner evidence found and/or method applied in restoring or reestablishing corner:

B-3 Found 5/8" solid bar in mon. box
Street sign S 29.2'
other wit. are gone.

* Also, field work in 1989 tied into witnesses from above L.C.R.C's

The position of the solid bar checks with 1/2 mile measurements from sectional information in 1989 by Exxel Engineering. *(See sketch on back). Accepted as a careful and faithful perpetuation of the position of the original corner, and replaced with standard Ottawa County cap on 24" x 3/4" steel bar.

C. Description of monument for corner and accessories established to perpetuate locating the position of the corner:

B-3 3/4" x 24" solid iron with O.C. Remon cap in mon. box
Set O.C. remon nail & tag in E sde of P. pole N10°W 185.56'
Set O.C. remon nail & tag in W sde of P. pole S15°E 31.74'
Set O.C. remon nail & tag in N sde of P. pole S80°W 175.29'
Set O.C. remon nail & tag in S sde of P. pole S85°E 222.23'
on centerline of E-W bt road (Riley)
centerline of gravel to North (92nd Ave) East 3'

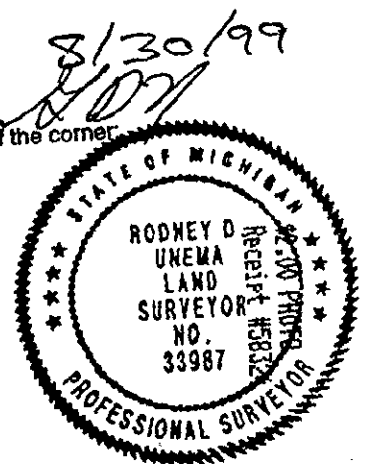

Signed by Rodney D. Unema
Surveyor's Michigan License No. 33987

Date August 30, 1999

FEB 24 2000

SECTION

