

FEB 24 2000

RECORDED

99 SEP 23 PM 3:20

SECTION

OTTAWA COUNTY REMONUMENTATION
LAND CORNER RECORDATION CERTIFICATE
Filing Requirement of Act 74, Mich. P.A. 1970

Dan Schell
REGISTER OF DEEDS
OTTAWA COUNTY, MI

For corners in
Ottawa

Located In: Zeeland Township
Corner Code #

1. Public Land Survey	T 5N R 14W	B-11
	T R	N 1/4 corner
	T R	Section 31
	T R	
2. Property Controlling in Section	S T R	
	S T R	
3. Miscellaneous Property in Sec.	S T R	
	S T R	

Register of Deeds Stamp & File Number

4. Lot No. _____, Recorded Plat _____
5. Private Claims _____

A	B	C	D	E	F	G	H	I	J	K	L	M
1												
2	6	5	4	3	2	1						
3												
4	7	8	9	10	11	12						
5												
6	10	17	16	15	14	13						
7												
8	19	20	21	22	23	24						
9												
10	30	29	28	27	26	25						
11	▲											
12	31	32	33	34	35	36						
13												

I, Rodney D. Unera, in a field survey on August 27, 1999 do hereby state that under requirements of P.A. 74, Michigan P.A. of 1970, the corner points mentioned in lines 1 and 2 above were in conformance with regulations and rules therefore as required in the current manual of survey instructions of the United States Department of the Interior, Bureau of Land Management or by a decree of a Court of Law and /or that the corner points mentioned in lines 3, 4 and 5 above were in conformance with the rules of the Michigan Board of Land Surveyors or by a Decree of a Court of Law; established, re-established, monumented, recovered, found as expressed below:

NOTE: Not more than 2 corners, all in the same town and range, may be recorded on this certificate.

A. Description of original monument and accessories and/or subsequent restoration:
B-11 1/4 Corner between Sections 30 and 31

April, 1832 G.L.O. Survey by C. Britain Set 1/2 mile post 12" Sugar N8°W 21 links 12" W. Ash S5°E 8 links	Aug. 24, 1972 (Bonnema) Liber 1, page 605 Found T iron PK nail in P. Pole North 88.0' PK nail in 42" Ash N-NW 76.67' C/L of 20" wide bit. Conc. South 0.3'	Aug. 11, 1976 (Clapp) Liber 3, page 106 Found T iron 48" Willow NW 76.07' Power pole NNW 86.80'	March 18, 1988 (Greer) Liber 5, page 293 Found T iron 52" Ash NW 76.07' P. Pole NNW 86.80' P. Pole N 87.84' C/L hydrant NW 44.32'
--	--	---	---

B. Description of corner evidence found and/or method applied in restoring or reestablishing corner:

B-11 Found 1/2 solid bar on centerline of Adams Street
Centerline hydrant NW 44.25'
Centerline 52" Ash NW 76.0'
P. Pole NNW 87.1'
P. Pole N 88.0'

MDA 8/30/99

Accepted as a careful and faithful perpetuation of the position of the original corner, and replaced 1/2" bar with Ottawa Co. Cap on 3/4" x 24" bar in new monument box.

C. Description of monument for corner and accessories established to perpetuate locating the position of the corner:

B-11 1/4 Corner between Sections 30 and 31
Ottawa Co. Cap on 3/4" x 24" steel bar in monument box
Set O.C. remon nail & tag in W sde of P. Pole North 88.0'
Set O.C. remon nail & tag in N sde of P. Pole S70°E 134.44'
Set O.C. remon nail & tag in N sde of P. Pole S60°W 93.83'
Centerline hydrant N40°W 44.25'
NW cor 2'x2' brick pier (W sde of driveway hse #9261) N55°E 88.98'

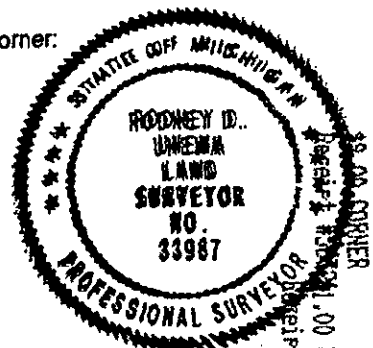

Signed by Rodney D. Unera
Surveyor's Michigan License No. 33987

Date August 30, 1999