

FEB 24 2000

OTTAWA COUNTY REMONUMENTATION
LAND CORNER RECORDATION CERTIFICATE
Filing Requirement of Act 74, Mich. P.A. 1970

RECORDED

99 SEP 23 PM 3: 21

For corners in

OTTAWA SECTION
(County)

Located In: ZEELAND TOWNSHIP
Corner Code #

- 1. Public Land Survey T 5N R 14W F-1
T R N 1/4 Corner
T R Section 4
T R
- 2. Property Controlling S T R
in Section S T R
- 3. Miscellaneous S T R
Property In Sec. S T R

Greg Schell
REGISTER OF DEEDS
OTTAWA COUNTY, MI

Register of Deeds Stamp & File Number

- 4. Lot No. _____, Recorded Plat _____
- 5. Private Claims _____

I, Rodney D. Unema, in a field survey on September 16, 19 99 do hereby state that under requirements of P.A. 74, Michigan P.A. of 1970, the corner points mentioned in lines 1 and 2 above were in conformance with regulations and rules therefore as required in the current manual of survey instructions of the United States Department of the Interior, Bureau of Land Management or by a decree of a Court of Law and /or that the corner points mentioned in lines 3, 4 and 5 above were in conformance with the rules of the Michigan Board of Land Surveyors or by a Decree of a Court of Law; established, re-established, monumented, recovered, found as expressed below:

NOTE: Not more than 2 corners, all in the same town and range, may be recorded on this certificate.

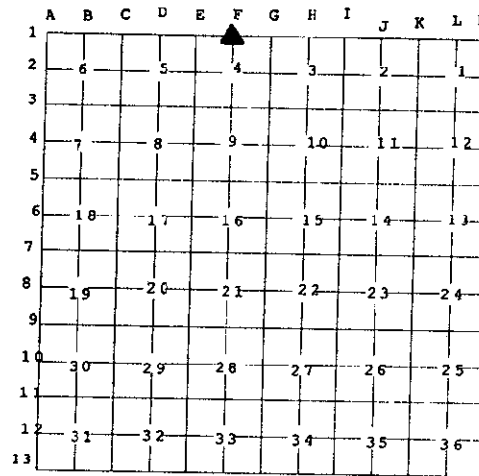

A. Description of original monument and accessories and/or subsequent restoration:

F-1 N 1/4 Corner, Section 4

| | | |
|----------------------------------|--|--|
| Corner not set by G.L.O. Survey | Jan 11, 1972 (Greer) Liber 1, page 231 Found Iron Pipe | April 1, 1982 (Joiner) Liber 4, page 309 Found Iron Pipe, set Cast Iron Mon. |
| 24" Oak | WSW 75.74' | Blendon Cor. East 46.72' |
| P.P. | SW 82.71' | 40" Oak SW 77.35' |
| P.P. | NE 106.28' | Power Pole SW 83.00' |
| Street sign | SE 55.23' | Street sign SE 55.00' |
| Iron Pipe, Blendon Twp Cor, East | 46.76' | Power Pole NE 106.96' |

B. Description of corner evidence found and/or method applied in restoring or reestablishing corner:

F-1 Found Cast Iron Mon. - on Township Line in Gravel Road

| | | |
|----------------------------------|---------------|------------------|
| F-13 T6N, R14W, Cast iron mon. | East 46.72' | *OVER FOR SKETCH |
| Centerline street sign | S66°E 55.2' | |
| Fnd nail & tag in SE sde P. Pole | N66°E 106.88' | |
| Centerline of 40" Oak | S74°W 77.5' | |
| Fnd nail in NW sde P. Pole | S38°W 82.85' | |

This position not established by original government surveyors. This monument is accepted as the best available evidence of the position of the corner.

C. Description of monument for corner and accessories established to perpetuate locating the position of the corner:

| | | |
|--|-------|---------|
| F-1 Cast Iron Mon. in E-W Gravel Road (New Holland Street) | | |
| Set rod 0.5' East of base of street sign | S66°E | 55.63' |
| Set nail & O.C. remon tag in SE side P. Pole | N66°E | 106.91' |
| Set nail & O.C. remon tag in S side 40" Oak | S74°W | 77.56' |
| Set nail & O.C. remon tag in NW side P. Pole | S38°W | 82.85' |
| F-13 T6N, R14W - Cast iron mon. | East | 46.72' |
| Centerline of E-W gravel road | North | 2.5' |

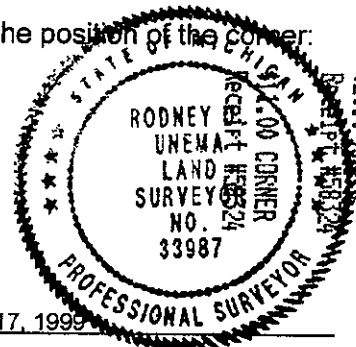

Signed by Rodney D. Unema
Surveyor's Michigan License No. 33987

Date September 17, 1999

FEB 24 2000

SECTION

