

FEB 24 2000

OTTAWA COUNTY REMONUMENTATION
LAND CORNER RECORDATION CERTIFICATE
Filing Requirement of Act 74, Mich. P.A. 1970

RECORDED

99 SEP 23 PM 3: 20

For corners in SECTION

OTTAWA
(County)

Located In: ZEELAND TOWNSHIP
Corner Code #

- 1. Public Land Survey T 5N R 14W I-1
T R NW Corner
T R Section 2
T R
- 2. Property Controlling S T R
in Section S T R
- 3. Miscellaneous S T R
Property In Sec. S T R

[Signature]
REGISTER OF DEEDS
OTTAWA COUNTY, MI

Register of Deeds Stamp & File Number

- 4. Lot No. _____, Recorded Plat _____
- 5. Private Claims _____

I, Rodney D. Unema, in a field survey on September 16, 19 99 do hereby state that under requirements of P.A. 74, Michigan P.A. of 1970, the corner points mentioned in lines 1 and 2 above were in conformance with regulations and rules therefore as required in the current manual of survey instructions of the United States Department of the Interior, Bureau of Land Management or by a decree of a Court of Law and /or that the corner points mentioned in lines 3, 4 and 5 above were in conformance with the rules of the Michigan Board of Land Surveyors or by a Decree of a Court of Law; established, re-established, monumented, recovered, found as expressed below:

NOTE: Not more than 2 corners, all in the same town and range, may be recorded on this certificate.

	A	B	C	D	E	F	G	H	I	J	K	L	I
1													
2	6			5			4		3			2	1
3													
4	7						8		9		10	11	12
5													
6	18						17		16		15	14	13
7													
8	19						20		21		22	23	24
9													
10	30						29		28		27	26	25
11													
12	31						32		33		34	35	36
13													

A. Description of original monument and accessories and/or subsequent restoration:

I-1 NW Corner, Section 2

March 29, 1832, G.L.O. Survey - C. Britain
Set corner to Sections 2 & 3 on
North boundary 55 links West of Post
8" Sugar S1°E 34 links
18" Sugar S29°W 39 links

March 7, 1978 (Nederveld)
Liber 3, page 261
Found 1" Pinched Iron
NW cor. of N-S Headwall
SW (not wingwall) 31.4'
NE cor. of N-S Headwall
SE (not wingwall) 39.4'
Centerline Street sign North 36.5'
"T" Iron E. (SE cor. Sec. 34, T6N,
R14W) 36.26'

Sept. 24, 1982 (Joiner)
Liber 4, page 346
Found 1" Pinched Iron, Set Cast Iron Mon.
NW corner N-S headwall SE 39.45'
NE corner N-S headwall SW 31.45'
Centerline street sign N 36.50'
TP N 104.30'
Blendon Corner E 32.26' (apparently incorrect)

B. Description of corner evidence found and/or method applied in restoring or reestablishing corner:

Found Cast Iron Mon 1' +/- Deep in Gravel Road
Fnd O.C.R.M> in gravel road East 36.29'
Centerline street sign post North 36.50'

*OVER FOR SKETCH

Measured existing cast iron monument to be 0.37' North of Blendon Township line, and accepted as a careful and faithful perpetuation of the position of the original corner. Set Ottawa County cap on 3/4" x 24" Bar 0.37' South of existing cast iron monument.

C. Description of monument for corner and accessories established to perpetuate locating the position of the corner:

- I-1 Ottawa County Cap on 3/4" x 24" Bar at intersection of New Holland & 64th Avenue
Top of cap is 6" below gravel surface
- Nail & O.C. Remon tag in S. sde P. pole S75°W 151.73'
- Nail & O.C. Remon tag in SW sde 20" Maple N40°W 147.69'
- SE corner house (brick) 2.0 above ground N8°W 155.28'
- Nail & O.C. remon tag in W. sde 10" Crab Apple S10°E 175.69'
- Cast iron mon. (closing corner) N0°E 0.37'
- I-13 T6N, R14W Cast iron mon. N90°E 36.29'

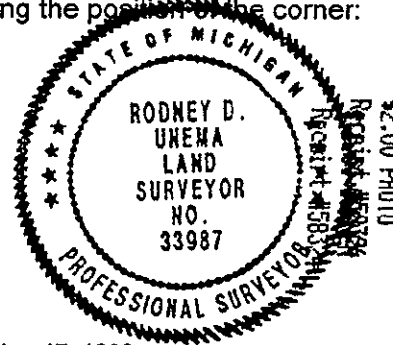

Signed by Rodney D. Unema
Surveyor's Michigan License No. 33987

Date September 17, 1999

FEB & 4 2000

SECTION

