

FEB 24 2000

OTTAWA COUNTY REMONUMENTATION  
LAND CORNER RECORDATION CERTIFICATE  
Filing Requirement of Act 74, Mich. P.A. 1970

RECORDED

99 SEP 23 PM 3:20

For corners in SECTION

OTTAWA (County)

Located In: ZEELAND TOWNSHIP Corner Code #

- 1. Public Land Survey T 5N R 14W J-1  
T R N 1/4 Corner  
T R Section 2  
T R
- 2. Property Controlling S T R  
in Section S T R
- 3. Miscellaneous S T R  
Property In Sec. S T R

*Randy Sublett*  
REGISTER OF DEEDS  
OTTAWA COUNTY, MI

Register of Deeds Stamp & File Number

- 4. Lot No. \_\_\_\_\_, Recorded Plat \_\_\_\_\_
- 5. Private Claims \_\_\_\_\_

I, Rodney D. Unema, in a field survey on September 17, 19 99 do hereby state that under requirements of P.A. 74, Michigan P.A. of 1970, the corner points mentioned in lines 1 and 2 above were in conformance with regulations and rules therefore as required in the current manual of survey instructions of the United States Department of the Interior, Bureau of Land Management or by a decree of a Court of Law and/or that the corner points mentioned in lines 3, 4 and 5 above were in conformance with the rules of the Michigan Board of Land Surveyors or by a Decree of a Court of Law; established, re-established, monumented, recovered, found as expressed below:

**NOTE: Not more than 2 corners, all in the same town and range, may be recorded on this certificate.**

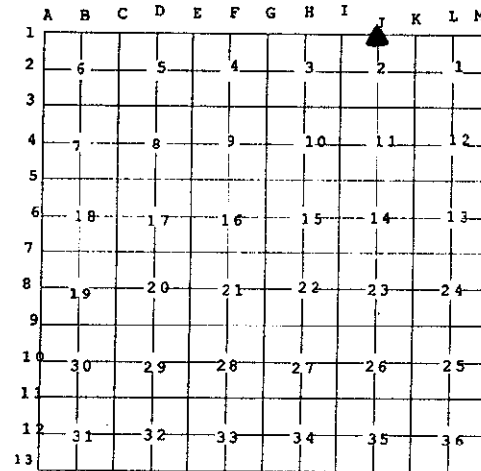

A. Description of original monument and accessories and/or subsequent Restoration:

J-1 N 1/4 Corner, Section 2  
Corner not set by G.L.O.

March 5, 1980 (Jonker)  
Liber 4, page 36

Found flat stock solid iron  
Nail in W. sde 20" Hickory NNE 55.24'  
R.R. spk in face P. pole South 49.52'  
"T" iron (S 1/4 cor. Sec 25, T6N, R14W) E 25.29'  
Centerline fence ROW to South E 3'

Sept. 24, 1982 (Joiner)  
Liber 4, page 346

Found iron, set cast iron monument  
20" Oak NE 55.50'  
PP S 49.52'  
Blendon Cor. E 25.29'

B. Description of corner evidence found and/or method applied in restoring or reestablishing corner:

J-1 Fnd cast mon 1'+/- deep in Gravel Road

Fnd nail in W sde 20" Oak NE 55.63'  
Fnd R.R. spk in N. sde P. pole S 49.52' to face pole  
Fnd O.C.R.M. in gravel road E 25.37'  
Centerline E-W gravel road N 4.0'  
Centerline tree ROW to South E 3.0'

\*OVER FOR SKETCH

- Cast iron monument is 1.82' North of Blendon Township line. Held monument for E-W position of 1/4 line.  
Set O.C. cap on 3/4" x 24" bar on Township line.

This position not established by original government surveyors. This monument is accepted as the best available evidence of the position of the corner.

C. Description of monument for corner and accessories established to perpetuate locating the position of the corner:

J-1 O.C. Cap on 3/4" x 24" steel bar in gravel road (New Holland) 4" below surface

Set nail & O.C. tag in W. sde Triple 12" Elm S8°W 20.21'  
Set nail & O.C. tag in W. sde Triple 20" Oak N29°E 57.30'  
Set nail & O.C. tag in E. sde P. pole S0°W 48.17'  
Cast iron mon. N0°E 1.82'  
J-13 Blendon Twp corner N90°E 25.28'  
Centerline of E-W gravel road (New Holland St). N0°E 5.2'

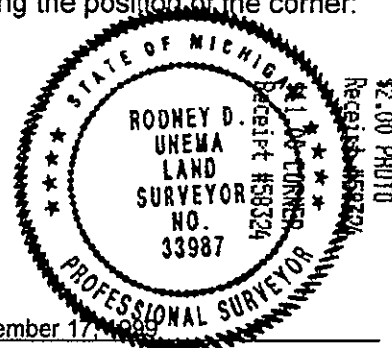

Signed by Rodney D. Unema  
Surveyor's Michigan License No. 33987

Date September 17, 1999

FEB 24 2000

SECTION

