

SURVEY & REMONUMENTATION

FEB 27 1998

SECTION

**OTTAWA COUNTY REMONUMENTATION
LAND CORNER RECORDATION CERTIFICATE
Filing Requirement of Act 74, Mich. P.A. 1970**

For corners in
Ottawa (County) Located In: _____ Corner Code # _____

1. Public Land Survey T5N R15W A-2 (W 1/4 cor. Sec. 6), Holland Twp.
T R
T R
T R

2. Property Controlling in Section S T R
S T R

3. Miscellaneous Property in Sec. S T R
S T R

4. Lot No. _____, Recorded Plat _____

5. Private Claims _____

RECORDED

97 DEC -8 AM 11:38

Sam S. [Signature]
REGISTER OF DEEDS
OTTAWA COUNTY, MI

Register of Deeds Stamp & File Number

I, Steve Lampen, in a field survey on November 18 19 97, do hereby certify that under requirements of P.A. 74, Michigan P.A. of 1970, the corner points mentioned in lines 1 and 2 above were in conformance with regulations and rules therefore as required in the current manual of survey instructions of the United States Department of the Interior, Bureau of Land Management or by a decree of a Court of Law and/or that the corner points mentioned in lines 3, 4 and 5 above were in conformance with the rules of the Michigan Board of Land Surveyors or by a Decree of a Court of Law; established, re-established, monumented, re-monumented, recovered, found as expressed below:

NOTE: Not more than 4 corners, all in the same town and range, may be recorded on this certificate.

A. Description of original monument and accessories and/or subsequent restoration:

A-2
G.L.O. - not set

L.C.R.C.
Liber 2, Page 163, 1973
Found 1" iron pipe
Most Northerly corner Southwest wingwall South Southwest 172.70'
Power Pole West Southwest 105.70'
Power Pole Northwest 135.77'

L.C.R.C. - Liber 5, Page 280, 1987
Found 1" pipe, set cast iron monument
Nail in wood fence corner East 84.75'
Park Township corner South 25.06'
Nail in wood gate post SE 95.05'
Nail in railroad tie mailbox South Southeast 76.05'

L.C.R.C.
Liber 5, Page 140, 1984
Found iron pipe
Power pole West Southwest 105.70'
Power pole Northwest 135.77'
Cast iron monument
Park Township corner South 29.13'
Power pole Northwest 161.69'
Center gas pipeline marker West Northwest 33.98'
22" Maple East 102.78

1	A	B	C	D	E	F	G	H	I	J	K	L	M
2	6	5	4	3	2	1							
3													
4	7	8	9	10	11	12							
5													
6	18	17	16	15	14	13							
7													
8	19	20	21	22	23	24							
9													
10	30	29	28	27	26	25							
11													
12	31	32	33	34	35	36							
13													

B. Description of corner evidence found and/or method applied in restoring or reestablishing corner:

A-2
Found iron
Power pole West Southwest 105.70'
Nail in wood gate post Southeast 95.05'
Nail in wood fence corner East 84.75'
Park Township corner South 25.06'
Power pole Northwest 135.77'
See sketch on back

OTTAWA COUNTY
PEER APPROVED 12-1-97
[Signature]

Established corner at the intersection of East and West 1/4 line of Section 6 with the East line Section 1, T5N, R.16W and set an Ottawa County Remonumentation iron and cap in a set monument box. This monument is accepted as the best available evidence of the position of the corner.
See sketch on back

C. Description of monument for corner and accessories established to perpetuate locating the position of the corner:

A-2
Ottawa County Remonumentation iron with cap in monumentation box.
AZ = Michigan State Plane grid direction

Found iron	91° 22'	0.7'
Centerline North and South asphalt road	91°	5.0'
Fence line to the East	180°	2.0'
Tree line to the East	0°	2.0'
Hydrant top centerline	145° 05'	75.15'
Hydrant top centerline	44° 45'	51.53'
M-1, T5N, R16W, cast iron monument in monument box	179° 05' 21"	25.00'
Remonumentation tag South side power pole	260° 17'	105.41'
Remonumentation tag Southwest side power pole	310° 27'	135.49'

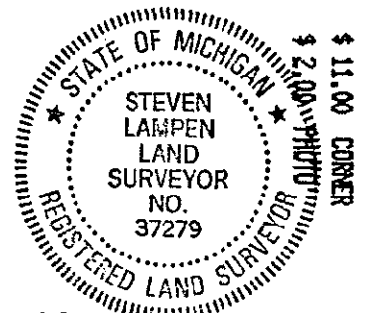

Signed by Steven Lampen Date DECEMBER 2, 1997

Surveyor's Michigan License No. 37279

SECTION 1

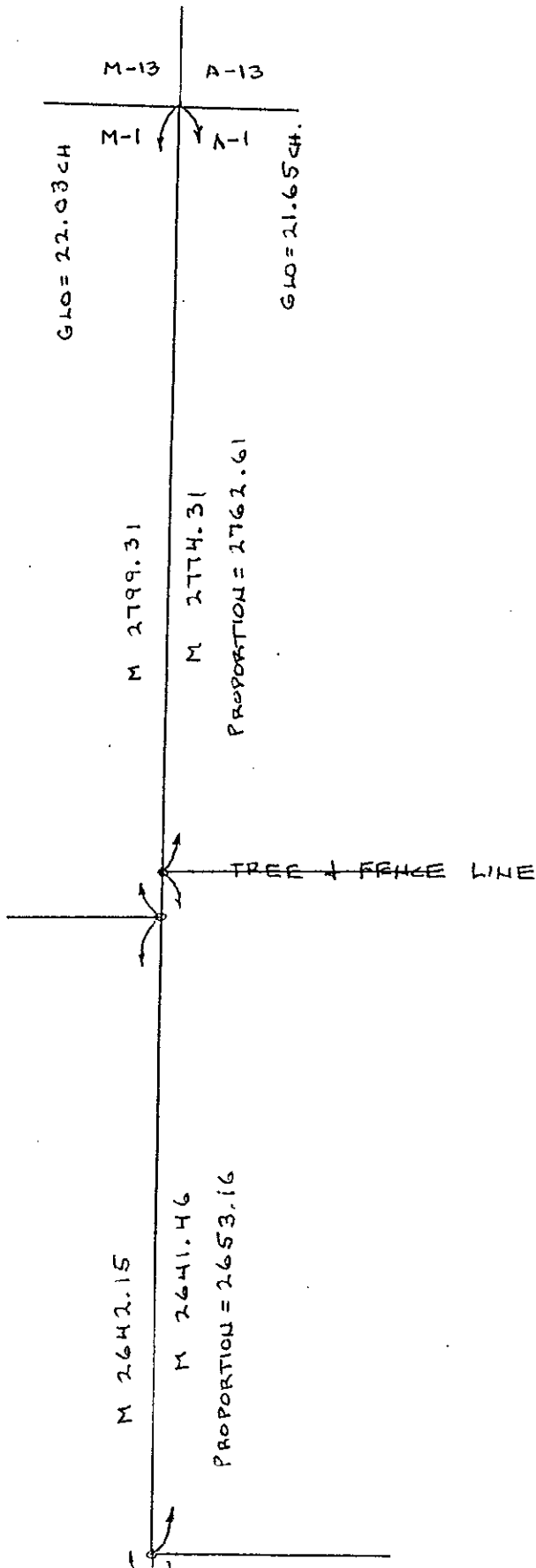

SECTION 6

SURVEY &
REMONUMENTATION

FEB 27 1998

SECTION