

RECORDED

97 JUL 24 PM 2: 25

OTTAWA COUNTY REMONUMENTATION
LAND CORNER RECORDATION CERTIFICATE
Filing Requirement of Act 74, Mich. P.A. 1970

R. J. ...
REGISTER OF DEEDS
OTTAWA COUNTY, MI

For corners in

Ottawa

(County)

Located In:

Corner Code #

Georgetown Twp.

1. Public Land Survey

T 6N R 13W

A-10, W 1/4 Cor

T R

Sec. 30

T R

T R

2. Property Controlling in Section

S T R

S T R

3. Miscellaneous Property in Sec.

S T R

S T R

Register of Deeds Stamp & File Number

4. Lot No. _____, Recorded Plat _____
5. Private Claims _____

I, Randal D. Feenstra, in a field survey on Nov. 20, 1996 do hereby state that under requirements of P.A. 74, Michigan P.A. of 1970, the corner points mentioned in lines 1 and 2 above were in conformance with regulations and rules therefore as required in the current manual of survey instructions of the United States Department of the Interior, Bureau of Land Management or by a decree of a Court of Law and /or that the corner points mentioned in lines 3, 4 and 5 above were in conformance with the rules of the Michigan Board of Land Surveyors or by a Decree of a Court of Law; established, re-established, monumented, recovered, found as expressed below:

NOTE: Not more than 2 corners, all in the same town and range, may be recorded on this certificate.

| | A | B | C | D | E | F | G | H | I | J | K | L | M |
|----|----|---|----|---|----|---|----|---|----|---|----|---|---|
| 1 | | | | | | | | | | | | | |
| 2 | 6 | | 5 | | 4 | | 3 | | 2 | | 1 | | |
| 3 | | | | | | | | | | | | | |
| 4 | 7 | | 8 | | 9 | | 10 | | 11 | | 12 | | |
| 5 | | | | | | | | | | | | | |
| 6 | 18 | | 17 | | 16 | | 15 | | 14 | | 13 | | |
| 7 | | | | | | | | | | | | | |
| 8 | 19 | | 20 | | 21 | | 22 | | 23 | | 24 | | |
| 9 | | | | | | | | | | | | | |
| 10 | 30 | | 29 | | 28 | | 27 | | 26 | | 25 | | |
| 11 | | | | | | | | | | | | | |
| 12 | 31 | | 32 | | 33 | | 34 | | 35 | | 36 | | |
| 13 | | | | | | | | | | | | | |

A. Description of original monument and accessories and/or subsequent restoration:

G.L.O.
Not Set

P.A. 345 OTTAWA COUNTY
PEER APPROVED 12-9-96

R.D.F.

B. Description of corner evidence found and/or method applied in restoring or reestablishing corner:

A-10 Found: Cast Iron Monument - Unrecorded

See sketch on back

This position not established by original government surveyors. This monument is accepted as the best available evidence of the position of the corner.

C. Description of monument for corner and accessories established to perpetuate locating the position of the corner:

A-10: Cast Iron Monument in Box (SEE SKETCH ON BACK)

| | | |
|---|--------|---------|
| Ottawa County Remon Nail & Tag in 8" Poplar | N 90°E | 42.85' |
| Ottawa County Remon Nail & Tag in Power Pole | S 15°E | 115.90' |
| Ottawa County Remon Nail & Tag in Power Pole | S 60°W | 64.90' |
| Ottawa County Remon Nail & Tag in Twin 6" Birch | N 22°W | 67.93' |

E 1/4 Cor. Sec. 25 of Blendon Township N0°E 10.24
On CL 48th Ave., Treeline East and West - 5' N.

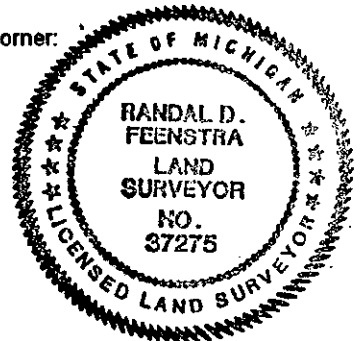

Signed by Randal D. Feenstra
Surveyor's Michigan License No. 37275

Date February 5, 1996

111 00 22

BLENDON TOWNSHIP

GEORGETOWN TOWNSHIP

