

SURVEY & RECONSTRUCTION

FEB 18 1994

OTTAWA COUNTY REMONUMENTATION
LAND CORNER RECORDATION CERTIFICATE
Filing Requirement of Act 74, Mich. P.A. 1970

RECORDED
93 NOV -8 PM 1:58

D. Lynda Robinson
REGISTER OF DEEDS
OTTAWA COUNTY, MI

For corners in
Ottawa COMMISSION
(County)

Located in: Corner Code #

- 1. Public Land Survey T 6N R 13W A-13, SW COR
T _____ R _____ Sec. 31, Geotwn.
T _____ R _____
T _____ R _____
- 2. Property Controlling S _____ T _____ R _____
in Section S _____ T _____ R _____
- 3. Miscellaneous S _____ T _____ R _____
Property in Sec. S _____ T _____ R _____

Register of Deeds Stamp & File Number

- 4. Lot No. _____, Recorded Plat _____
- 5. Private Claims _____

I, Randal D. Feenstra in a field survey on Sept. 27, 19 93, do hereby certify that under requirements of P.A. 74, Michigan P.A. of 1970, the corner points mentioned in lines 1 and 2 above were in conformance with regulations and rules therefore as required in the current manual of survey instructions of the United States Department of the Interior, Bureau of Land Management or by a decree of a Court of Law and/or that the corner points mentioned in lines 3, 4 and 5 above were in conformance with the rules of the Michigan Board of Land Surveyors or by a Decree of a Court of Law; established, re-established, monumented, re-monumented, recovered, found as expressed below:

NOTE: Not more than 4 corners, all in the same town and range, may be recorded on this certificate.

	A	B	C	D	E	F	G	H	I	J	K	L	M
2	6	5	4	3	2	1							
3													
4	7	8	9	10	11	12							
5													
6	18	17	16	15	14	13							
7													
8	19	20	21	22	23	24							
9													
10	30	29	28	27	26	25							
11													
12	31	32	33	34	35	36							
13													

A. Description of original monument and accessories and/or subsequent restoration:

A-13, Georgetown Township, L.C.R.C # L-5, P-92 Cast Iron Monument
P.Pole NW 77.60
P.Pole SW 31.90
Hydrant NE 40.80
P.Pole SE 50.25

B. Description of corner evidence found and/or method applied in restoring or reestablishing corner:

A-13 Found Cast Iron Monument - accepted as a careful and faithful perpetuation of the position of the original corner.
Found P.Pole SE 50.25'
P.Pole NW 77.60'
Hydrant NE 40.80'

C. Description of monument for corner and accessories established to perpetuate locating the position of the corner:

A-13 Set O.C. Remon. Rod and Cap in concrete
O.C. Remon. Nail & Tag in P.Pole S50°W 48.16'
O.C. Remon. Nail & Tag in P.Pole S50°E 50.01'
O.C. Remon. Nail & Tag in P.Pole N20°W 77.45'
CL Hydrant N50°E 42.91
At CL "X", New Holland and 48th

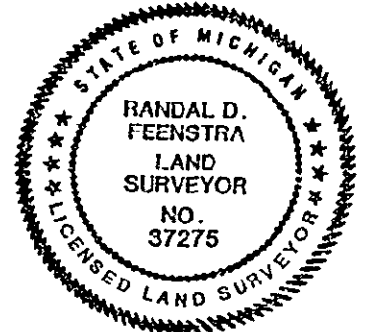

Signed by Randal D. Feenstra

Date Sept 29, 1993

Surveyor's Michigan License No. 37275