

OTTAWA COUNTY REMONUMENTATION

LAND CORNER RECORDATION CERTIFICATE
Filing Requirement of Act 74, Mich. P.A. 1970

For corners in
Ottawa

| | |
|--------------|-----------------|
| Located in: | Corner Code # |
| Blendon Twp. | |
| T 6N R 14W | A-2, W 1/4 cor. |
| T R | Sec. 6' |
| T R | |
| T R | |
| S T R | |
| S T R | |
| S T R | |
| S T R | |

RECORDED

96 DEC 17 AM 10:44

Randy D. Feenstra
REGISTER OF DEEDS
OTTAWA COUNTY, MI

Register of Deeds Stamp & File Number

1. Public Land Survey

2. Property Controlling in Section

3. Miscellaneous Property in Sec.

4. Lot No. _____, Recorded Plat _____
5. Private Claims _____

I, Randal D. Feenstra, in a field survey on Feb. 20, 1996 do hereby state that under requirements of P.A. 74, Michigan P.A. of 1970, the corner points mentioned in lines 1 and 2 above were in conformance with regulations and rules therefore as required in the current manual of survey instructions of the United States Department of the Interior, Bureau of Land Management or by a decree of a Court of Law and /or that the corner points mentioned in lines 3, 4 and 5 above were in conformance with the rules of the Michigan Board of Land Surveyors or by a Decree of a Court of Law; established, re-established, monumented, recovered, found as expressed below:

NOTE: Not more than 2 corners, all in the same town and range, may be recorded on this certificate.

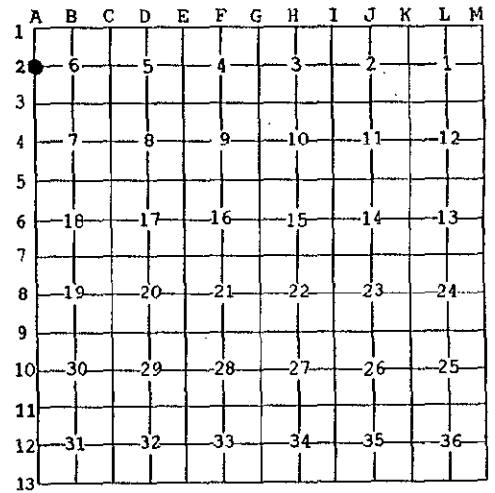

A. Description of original monument and accessories and/or subsequent restoration:

| | | |
|---------|--------------------|--------------------------|
| G.L.O. | L-1, P-493, (1972) | L-4, P-79, (1980) |
| | "8" Pine | E 47.05' |
| Not Set | N Guard Post | SE 35.02' |
| | Olive Twp. Cor. | S 38.90' |
| | P. Pole | SW 78.0' |
| | | Cast Iron Monument |
| | | P. Pole SW 77.55' |
| | | 10" Pine SE 60.02' |
| | | 10" Pine E 46.90' |
| | | Olive Twp. Cor. S 38.89' |

P.A. 345 OTTAWA COUNTY

PEER APPROVED 11-11-96

B. Description of corner evidence found and/or method applied in restoring or reestablishing corner:

A-2 Found: Cast Iron Monument in Box

| | | |
|-------------------------------|----------|--------|
| Pk and Tag in NW side P. Pole | AZ. 212° | 77.65' |
| Olive Twp. Cor. S 38.90' | | |
| Nail and Tag N side 16" Pine | AZ. 91° | 46.95' |

This position not established by original government surveyors. This monument is accepted as the best available evidence of the position of the corner.

C. Description of monument for corner and accessories established to perpetuate locating the position of the corner:

| | |
|--|--|
| A-2 Cast Iron Monument in Box | (0.22' E. of Townline, See Sketch on Back) |
| Ottawa County Remon Nail & Tag in SE side P. Pole | AZ. 212° 77.90' |
| Ottawa County Remon Nail & Tag in S side P. Pole | AZ. 272° 79.08' |
| Ottawa County Remon Nail & Tag in S side 16" Pine | AZ. 93° 46.77' |
| Ottawa County Remon Nail & Tag in SW side 16" Pine | AZ. 150° 92.56' |
| Olive Twp. Cor. Cast Iron Monument in Box | S 38.90' |
| Centerline Stanton St. (bit. conc. to West) | S .39' |
| Centerline 96th Ave. (bit. conc.) | W 1.8' |

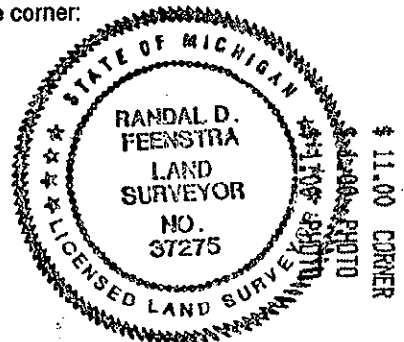

Signed by Randal D. Feenstra
Surveyor's Michigan License No. 37275

Date February 20, 1996

OLIVE TOWNSHIP

