

RECORDED

OTTAWA COUNTY REMONUMENTATION

LAND CORNER RECORDATION CERTIFICATE 97 JUL 24 PM 2: 24

Filing Requirement of Act 74, Mich. P.A. 1970

D. J. ...
REGISTER OF DEEDS
OTTAWA COUNTY, MI

For corners in
Ottawa

(County)

Located In:

Corner Code #

1. Public Land Survey	T	6N	R	14W	C-9, NW Cor.
	T		R		Sec. 29
	T		R		Blendon Twp.
	T		R		
2. Property Controlling in Section	S		T	R	
	S		T	R	
3. Miscellaneous Property in Sec.	S		T	R	
	S		T	R	

Register of Deeds Stamp & File Number

4. Lot No. _____, Recorded Plat _____
5. Private Claims _____

Randal D. Feenstra

September 21

95

I, _____, in a field survey on _____, 19____, do hereby certify that under requirements of P.A. 74, Michigan P.A. of 1970, the corner points mentioned in lines 1 and 2 above were in conformance with regulations and rules therefore as required in the current manual of survey instructions of the United States Department of the Interior, Bureau of Land Management or by a decree of a Court of Law and/or that the corner points mentioned in lines 3, 4 and 5 above were in conformance with the rules of the Michigan Board of Land Surveyors or by a Decree of a Court of Law; established, re-established, monumented, re-monumented, recovered, found as expressed below:

NOTE: Not more than 4 corners, all in the same town and range, may be recorded on this certificate.

A	B	C	D	E	F	G	H	I	J	K	L	M
2	6	5	4	3	2	1						
3												
4	7	8	9	10	11	12						
5												
6	18	17	16	15	14	13						
7												
8	19	20	21	22	23	24						
9												
10	30	29	28	27	26	25						
11												
12	31	32	33	34	35	36						
13												

A. Description of original monument and accessories and/or subsequent restoration:

G.L.O. By Calvin Britain	L-1, P-563, 1972	L-5, P-122, 1984
April 21, 1832	R.R. Spike	C.I.M.
POST	15" Ash	NE 50.38'
8" Beech	N49°E 9 links	CL USGS Mon. SW 38.90'
5" Hemlock	N60°W 6 links	18" P.P. SW 51.30'
	T. Pole	NE 44.85'
		PP SW 51.00'
		Cen. St. Sign SE 43.52'
		T. Pole NE 47.88'
		P.P. NW 78.45'

B. Description of corner evidence found and/or method applied in restoring or reestablishing corner:

Found: C.I.M. in box
Nail in E side P. Pole NW 78.47'
Nail in E side P.Pole SW 51.03'

PA. 345 OTTAWA COUNTY
PEER APPROVED 9-16-96

R.D.F.

C. Description of monument for corner and accessories established to perpetuate locating the position of the corner:

C-9 C.I.M. in box
Ottawa County Remon. Nail and Tag in E side P. Pole N 30°W 78.49'
Ottawa County Remon. Nail and Tag in W side P. Pole N 30°E 72.15'
Ottawa County Remon. Nail and Tag in E side P. Pole S 45°W 51.03'
PK in S end 60" CSP S 50°E 37.44'
1.5'S and 2'E of centerline Port Sheldon and 88th Ave. to North

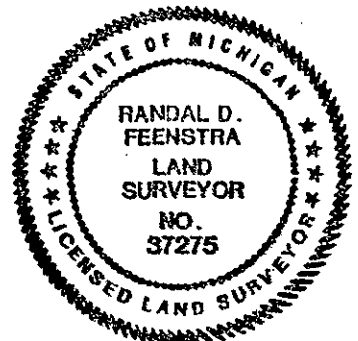

Randal D. Feenstra

Randal D. Feenstra

Date September 21, 1995

Signed by _____
Surveyor's Michigan License No. 37275