

**OTTAWA COUNTY REMONUMENTATION
LAND CORNER RECORDATION CERTIFICATE
Filing Requirement of Act 74, Mich. P.A. 1970**

RECORDED

97 JUL 24 PM 2: 24

Phyllis Alderman
REGISTER OF DEEDS
OTTAWA COUNTY, MI

For corners in
Ottawa

(County)

Located In:

Corner Code #

- | | | | | | |
|---------------------------------------|---|----|---|-----|-----------------|
| 1. Public Land Survey | T | 6N | R | 14W | D-9, N 1/4 Cor. |
| | T | | R | | Sec. 29 |
| | T | | R | | Blendon Twp. |
| | T | | R | | |
| 2. Property Controlling
in Section | S | | T | R | |
| | S | | T | R | |
| 3. Miscellaneous
Property in Sec. | S | | T | R | |
| | S | | T | R | |
4. Lot No. _____, Recorded Plat _____
5. Private Claims _____

Register of Deeds Stamp & File Number

A	B	C	D	E	F	G	H	I	J	K	L	M
2	6	5	4	3	2	1						
3												
4	7	8	9	10	11	12						
5												
6	18	17	16	15	14	13						
7												
8	19	20	21	22	23	24						
9												
10	30	29	28	27	26	25						
11												
12	31	32	33	34	35	36						
13												

Randal D. Feenstra

September 21

95

I, _____, in a field survey on _____, 19____, do hereby certify that under requirements of P.A. 74, Michigan P.A. of 1970, the corner points mentioned in lines 1 and 2 above were in conformance with regulations and rules therefore as required in the current manual of survey instructions of the United States Department of the Interior, Bureau of Land Management or by a decree of a Court of Law and/or that the corner points mentioned in lines 3, 4 and 5 above were in conformance with the rules of the Michigan Board of Land Surveyors or by a Decree of a Court of Law; established, re-established, monumented, re-monumented, recovered, found as expressed below:

NOTE: Not more than 4 corners, all in the same town and range, may be recorded on this certificate.

- A. Description of original monument and accessories and/or subsequent restoration:
- | | |
|--------------------------|---------------------|
| G.L.O. By Calvin Britain | L-1, P-383, 1972 |
| April 21, 1832 | C.I.M. |
| POST | P.P. NW 50.83' |
| 6" Beech S30°E 16 links | 24" Maple NE 79.20' |
| 9" Elm N47°W 5 links | P.P. SE 122.14' |
| | St. Sign SE 45.43' |

- B. Description of corner evidence found and/or method applied in restoring or reestablishing corner:
- Found: C.I.M. in box
Spike in W side 32" Maple NE 80.03'

P.A. 345 OTTAWA COUNTY
PEER APPROVED 9-16-96
M.D.N.

- C. Description of monument for corner and accessories established to perpetuate locating the position of the corner:

D-9 C.I.M. in box

- | | |
|---|--------------|
| Ottawa County Remon. Nail and Tag in W side 32" Maple | N20°E 79.90 |
| Ottawa County Remon. Nail and Tag in top of 4"x4" Post | S60°E 45.76' |
| Ottawa County Remon. Nail and Tag in E side of 4"x4" Post | S45°W 51.63' |
| Ottawa County Remon. Nail and Tag in NW side 10" Maple | S60°W 75.73' |
| 2'S and 2'E of centerline Port sheldon and 84th Ave. | |

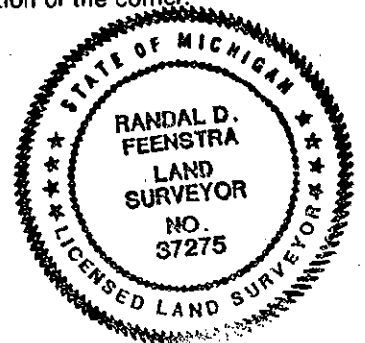

Randal D. Feenstra
Randal, D. Feenstra

September 21, 1995

Signed by _____
37275

Date _____

Surveyor's Michigan License No. _____