

**OTTAWA COUNTY REMONUMENTATION**  
**LAND CORNER RECORDATION CERTIFICATE**  
 Filing Requirement of Act 74, Mich. P.A. 1970

For corners in  
Ottawa  
 (County)

Located In: Blendon Twp. Corner Code # D-13, S 1/4 cor.

	T	6N	R	14W	<u>Sec. 32</u>
1. Public Land Survey	T		R		
	T		R		
	T		R		
2. Property Controlling in Section	S		T	R	
	S		T	R	
3. Miscellaneous Property In Sec.	S		T	R	
	S		T	R	

4. Lot No. \_\_\_\_\_, Recorded Plat \_\_\_\_\_  
 5. Private Claims \_\_\_\_\_

**RECORDED**  
 96 DEC 17 AM 10:41  
*Randal D. Feenstra*  
 REGISTER OF DEEDS  
 OTTAWA COUNTY, MI  
 Register of Deeds Stamp & File Number

I, Randal D. Feenstra, in a field survey on Oct 10, 1996 do hereby state that under requirements of P.A. 74, Michigan P.A. of 1970, the corner points mentioned in lines 1 and 2 above were in conformance with regulations and rules therefore as required in the current manual of survey instructions of the United States Department of the Interior, Bureau of Land Management or by a decree of a Court of Law and /or that the corner points mentioned in lines 3, 4 and 5 above were in conformance with the rules of the Michigan Board of Land Surveyors or by a Decree of a Court of Law; established, re-established, monumented, recovered, found as expressed below:

A	B	C	D	E	F	G	H	I	J	K	L	M
1												
2	6		5		4		3		2		1	
3												
4	7		8		9		10		11		12	
5												
6	18		17		16		15		14		13	
7												
8	19		20		21		22		23		24	
9												
10	30		29		28		27		26		25	
11												
12	31		32		33		34		35		36	
13												

NOTE: Not more than 2 corners, all in the same town and range, may be recorded on this certificate.

A. Description of original monument and accessories and/or subsequent restoration:  
 G.L.O. (1832) From Zeeland Twp. Cor. (D-1)  
 Calvin Britain, D.S. L-3, P-103, (1976)  
 Post Measured East 46.70 feet from Zeeland Corner to Blendon Corner  
 10" Sugar Maple N46°E 24 lks  
 2" Wh. Ash N33°W 24 lks

**P.A. 345 OTTAWA COUNTY**  
 PEER APPROVED 11-11-96  
*R.D.F.*

B. Description of corner evidence found and/or method applied in restoring or reestablishing corner:  
 D-13 Found: "T" Iron  
 Nail & Bottlecap SE Side Post Az 207° 37.24'  
 Nail W Side 12" Elm Az 130° 43.74'  
 Cast Iron Monument N 1/4 corner Sec. 5, T5N, R14W, Zeeland Twp. D-1 W 46.63'

Accepted as a careful and faithful perpetuation of the position of the original corner.

C. Description of monument for corner and accessories established to perpetuate locating the position of the corner:  
 D-13 Set Ottawa County Remon Bar and Cap (SEE SKETCH ON BACK)  
 Ottawa County Remon Nail & Tag NE side P. Pole Az. 126° 129.80'  
 Ottawa County Remon Nail & Tag W side Post Az. 209° 37.31'  
 Ottawa County Remon Tag & Nail SE side P. Pole Az. 39° 166.63'  
 Cast Iron Monument D-1, Zeeland Twp. W 46.63'  
 Centerline 84th Ave. N (Gravel Rd.) 2'E  
 Centerline New Holland St. E-W (Gravel Rd.) 2'N

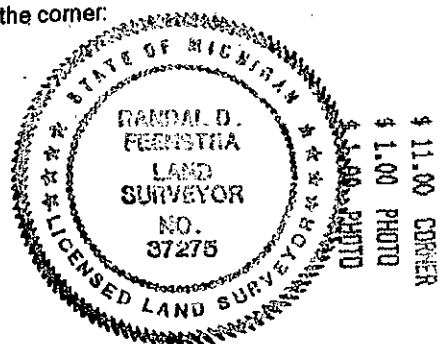

Signed by Randal D. Feenstra  
 Surveyor's Michigan License No. 37275

Date October 10, 1996

BLENDON TWP.

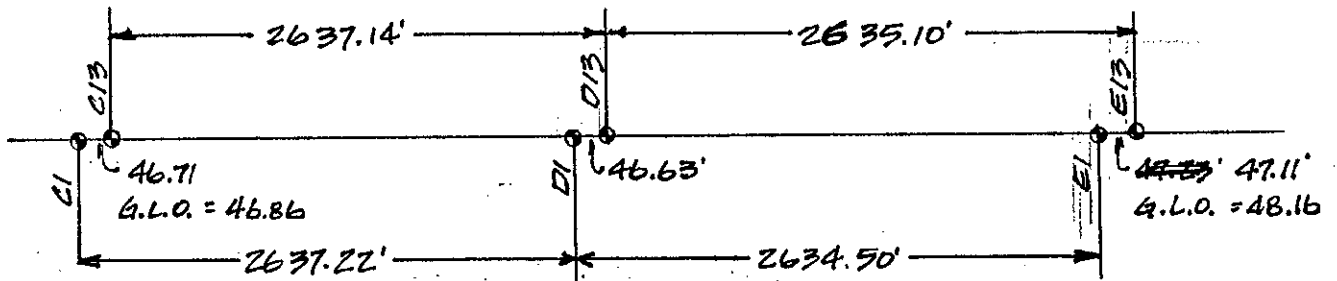

ZEELAND TWP.