

OTTAWA COUNTY REMONUMENTATION

T14E 111

LAND CORNER RECORDATION CERTIFICATE
Filing Requirement of Act 74, Mich. P.A. 1970

For corners in
Ottawa

Located In:	Corner Code #
Blendon Twp. T <u>6N</u> R <u>14W</u>	E-1, NE cor.
T <u> </u> R <u> </u>	Sec. 5
T <u> </u> R <u> </u>	
T <u> </u> R <u> </u>	
S <u> </u> T <u> </u> R <u> </u>	
S <u> </u> T <u> </u> R <u> </u>	
S <u> </u> T <u> </u> R <u> </u>	
S <u> </u> T <u> </u> R <u> </u>	

- 1. Public Land Survey
- 2. Property Controlling in Section
- 3. Miscellaneous Property in Sec.

RECORDED

96 DEC 17 AM 10:44

Randal D. Feenstra
REGISTER OF DEEDS
OTTAWA COUNTY, MI

Register of Deeds Stamp & File Number

4. Lot No. _____, Recorded Plat _____
5. Private Claims _____

I, Randal D. Feenstra, in a field survey on February 1, 1996 do hereby state that under requirements of P.A. 74, Michigan P.A. of 1970, the corner points mentioned in lines 1 and 2 above were in conformance with regulations and rules therefore as required in the current manual of survey instructions of the United States Department of the Interior, Bureau of Land Management or by a decree of a Court of Law and/or that the corner points mentioned in lines 3, 4 and 5 above were in conformance with the rules of the Michigan Board of Land Surveyors or by a Decree of a Court of Law; established, re-established, monumented, recovered, found as expressed below:

	A	B	C	D	E	F	G	H	I	J	K	L	M
1													
2	6			5		4		3		2			1
3													
4	7			8		9		10		11			12
5													
6	18			17		16		15		14			13
7													
8	19			20		21		22		23			24
9													
10	30			29		28		27		26			25
11													
12	31			32		33		34		35			36
13													

NOTE: Not more than 2 corners, all in the same town and range, may be recorded on this certificate.

A. Description of original monument and accessories and/or subsequent restoration:

G.L.O. (1831)	LIBER 1, PAGE 557 (1972)	LIBER 3, PAGE 10, (1975)
Lucius Lyon	"T" Iron	"T" Iron
Post	"T" Iron @ Allendale Cor.	Nail NE Side P. Pole
10" Black Ash N 55°W 27 lks.	S. Side P. Pole	NW 38.52'
7" Black Ash N 74°E 35 lks.	N Side P. Pole	Nail NE Side P. Pole
	P. Pole	WNW 23.57'
		Nail SE Side P. Pole
		NE 74.48'
		Iron (SW cor. Sec.33 Allendale Twp.)
		E 6.90'

CONTINUED ON BACK

B. Description of corner evidence found and/or method applied in restoring or reestablishing corner:

Found: C.I.M. in box	Accepted as a careful and faithful perpetuation of the position of the original corner.
Nail S side P. Pole	AZ 62° 70.39'
Nail E side P. Pole	AZ 321° 31.60'
Nail N side 4" post	AZ 225° 47.75'
Pk. E side 6" post	AZ 187° 78.05'
SE Cor. Sec. 32, T7N, R14W	AZ 90° 7.01'

P.A. 345 OTTAWA COUNTY
PEER APPROVED 11-11-96
[Signature]

C. Description of monument for corner and accessories established to perpetuate locating the position of the corner:

E-1	C.I.M. in Box (0.17' S. OF TOWNLINE - SEE SKETCH ON BACK)		
	Ottawa County Remon. Nail & Tag in E. side P. Pole	AZ 321°	31.60'
	Ottawa County Remon. Nail & Tag in SE side 6" Post	AZ 240°	42.07'
	Ottawa County Remon. Nail & Tag in NW side P. Pole	AZ 61°	70.65'
	Ottawa County Remojn. Nail & Tag in W side 6" Poplar	AZ 168°	129.25'
	SE cor. Sec. 32, Allendale Twp.	AZ 90°	7.01'

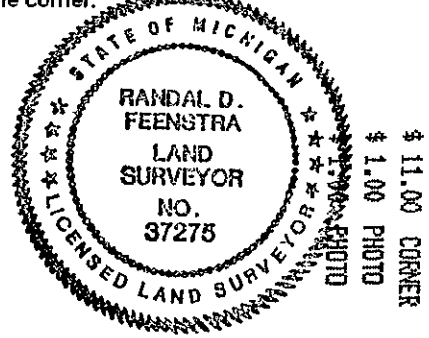

Signed by Randal D. Feenstra
Surveyor's Michigan License No. 37275

Date February 1, 1996

LIBER 3, PAGE 367, (1979)

"T" Iron
 S Side P. Pole NW 32.56'
 N Side P. Pole NW 38.50'
 Face Side P. Pole NE 74.03'
 Allendale Cor. (Iron) E 6.96'

LIBER 4, PAGE 135, (1980)

C.I.M.
 P. Pole NE 68.49
 P. Pole NW 38.50'
 St. Sign NE 20.17'
 Allendale Cor. E 6.97'

LIBER 5, PAGE 153, (1984)

C.I.M.
 Nail E. Side P. Pole N40°W 32.53'
 Nail S. Side P. Pole N70°E 74.55'
 Centerline St. Sign N25°E 20.62'
 SE Cor. Sec. 32, T7N, R14W E 6.98'

LIBER 6, PAGE 149, (1991)

C.I.M.
 Nail NE Side P. Pole N40°W 31.60'
 Nail S Side P. Pole N65°E 70.39'
 1/2" Rebar SE Cor. intersection S20°E 66.04'
 Pk E side 6" Post S15°W 78.02'
 Nail N Side 4" Post S45°W 47.60'
 SE Cor. Sec. 32, T7N, R14W N90°E 6.98'

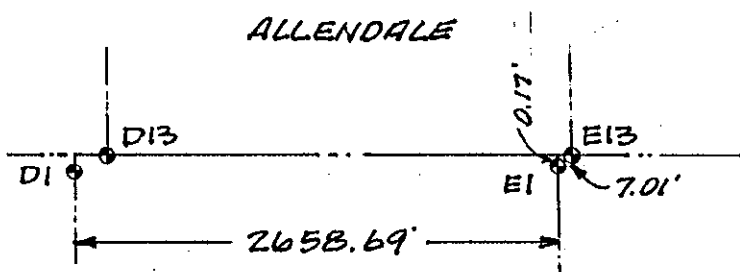

BLENDON

NOTE: G.L.O. INFORMATION INDICATES A DISTANCE OF 5.28' FROM E1 TO E13