

SURVEY & REMONUMENTATION

DEC 16 1996

COMMISSION

OTTAWA COUNTY REMONUMENTATION

LAND CORNER RECORDATION CERTIFICATE
Filing Requirement of Act 74, Mich. P.A. 1970

For corners in
Ottawa

	Located in:	Corner Code #
(County)	Blendon Twp.	
	6N 14W	E-2, E 1/4 cor.
1. Public Land Survey	T <u> </u> R <u> </u>	Sec. 5
	T <u> </u> R <u> </u>	
	T <u> </u> R <u> </u>	
	T <u> </u> R <u> </u>	
2. Property Controlling in Section	S <u> </u> T <u> </u> R <u> </u>	
	S <u> </u> T <u> </u> R <u> </u>	
3. Miscellaneous Property in Sec.	S <u> </u> T <u> </u> R <u> </u>	
	S <u> </u> T <u> </u> R <u> </u>	
4. Lot No. _____, Recorded Plat _____		
5. Private Claims _____		

RECORDED

96 NOV 14 AM 11:20

Randal D. Feenstra
REGISTER OF DEEDS
OTTAWA COUNTY, MI

Register of Deeds Stamp & File Number

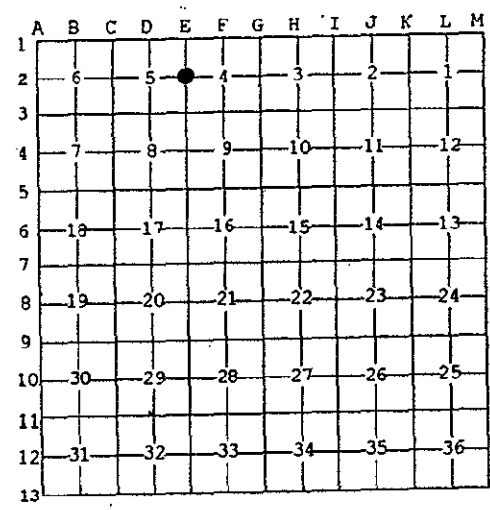

I, Randal D. Feenstra, in a field survey on March 21, 1996 do hereby state that under requirements of P.A. 74, Michigan P.A. of 1970, the corner points mentioned in lines 1 and 2 above were in conformance with regulations and rules therefore as required in the current manual of survey instructions of the United States Department of the Interior, Bureau of Land Management or by a decree of a Court of Law and/or that the corner points mentioned in lines 3, 4 and 5 above were in conformance with the rules of the Michigan Board of Land Surveyors or by a Decree of a Court of Law; established, re-established, monumented, recovered, found as expressed below.

NOTE: Not more than 2 corners, all in the same town and range, may be recorded on this certificate.

A. Description of original monument and accessories and/or subsequent restoration:

G.L.O. (1832) Calvin Britain Post	LIBER 1, PAGE 557 (1972) 1/2" Iron Pipe P. Pole SW 40.98' Centerline St. Sign E 25.56' P. Pole SSE 88.67'	LIBER 4, PAGE 218 (1981) Cast Iron Monument P. Pole SSE 89.15' P. Pole SW 41.60' NW Cor. Wood Shed E 94.84' St. Sign ENE 25.47'
---	---	--

B. Description of corner evidence found and/or method applied in restoring or reestablishing corner:

Found: Cast Iron Monument Accepted as a careful and faithful perpetuation of the position of the original corner.

Nail & Tag in N side P. Pole AZ 230° 42.91'
NW Cor. Frame Shed AZ 99° 94.88'
Centerline St. Sign AZ 85° 25.40'

OTTAWA COUNTY
FEELER APPROVED 9-16-96
R.D.F.

C. Description of monument for corner and accessories established to perpetuate locating the position of the corner:

E-2	Cast Iron Monument		
	Ottawa County Remon. Nail & Tag in N side P. Pole	AZ 230°	42.91'
	Ottawa County Remon. Nail & Tag in W side Twin 8" Maple	AZ 160°	150.29'
	Centerline Street Sign	AZ 85°	94.88'
	SE Cor. Metal Pole Barn	AZ 323°	149.25'
	Centerline 80th Ave. N-S (gravel)	0.0'E	
	Centerline Stanton St. W (gravel)	6'N	

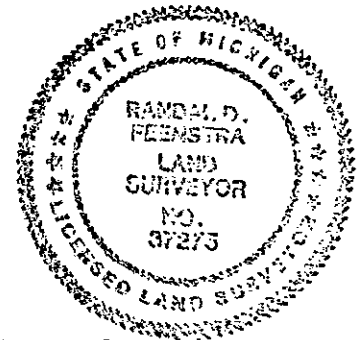

Signed by *Randal D. Feenstra*
Surveyor's Michigan License No. 37275

Date March 21, 1996