

OTTAWA COUNTY REMONUMENTATION

LAND CORNER RECORDATION CERTIFICATE
 Filing Requirement of Act 74, Mich. P.A. 1970

For corners in
Ottawa

(County)

Located In:	Blendon Twp.	Corner Code #
	6N 14W	E-13, SE cor.
1. Public Land Survey	T <u> </u> R <u> </u>	<u> </u>
	T <u> </u> R <u> </u>	<u>Sec. 32</u>
	T <u> </u> R <u> </u>	<u> </u>
	T <u> </u> R <u> </u>	<u> </u>
2. Property Controlling in Section	S <u> </u> T <u> </u> R <u> </u>	<u> </u>
	S <u> </u> T <u> </u> R <u> </u>	<u> </u>
3. Miscellaneous Property in Sec.	S <u> </u> T <u> </u> R <u> </u>	<u> </u>
	S <u> </u> T <u> </u> R <u> </u>	<u> </u>

RECORDED
 96 DEC 17 AM 10:44
Randy Robinson
 REGISTER OF DEEDS
 OTTAWA COUNTY, MI
 Register of Deeds Stamp & File Number

4. Lot No. _____, Recorded Plat _____
 5. Private Claims _____

I, Randal D. Feenstra, in a field survey on Oct 10, 19 96 do hereby state that under requirements of P.A. 74, Michigan P.A. of 1970, the corner points mentioned in lines 1 and 2 above were in conformance with regulations and rules therefore as required in the current manual of survey instructions of the United States Department of the Interior, Bureau of Land Management or by a decree of a Court of Law and/or that the corner points mentioned in lines 3, 4 and 5 above were in conformance with the rules of the Michigan Board of Land Surveyors or by a Decree of a Court of Law; established, re-established, monumented, recovered, found as expressed below:

NOTE: Not more than 2 corners, all in the same town and range, may be recorded on this certificate.

1	A	B	C	D	E	F	G	H	I	J	K	L	M
2		6		5		4		3		2		1	
3													
4		7		8		9		10		11		12	
5													
6		18		17		16		15		14		13	
7													
8		19		20		21		22		23		24	
9													
10		30		29		28		27		26		25	
11													
12		31		32		33		34		35		36	
13													

A. Description of original monument and accessories and/or subsequent restoration:

G.L.O. (1832)	From Zeeland Twp. Cor. (E-1)
Calvin Britain, D.S.	L-3, P-103, (1976)
Post	Measured East 47.22 feet from Zeeland Corner to Blendon Corner
7" Sugar Maple N26°E 10 lks	
30" Beech N80°W 40 lks	

P.A. 345 OTTAWA COUNTY
 PEER APPROVED 11-11-96

B. Description of corner evidence found and/or method applied in restoring or reestablishing corner:
 E-13 Found: "T" Iron

PK Nail SW Side P. Pole AZ 129° 77.90'
 Cast Iron Monument NE corner Sec. 5, T5N, R14W, Zeeland Twp. E-1 W 47.11'

Accepted as a careful and faithful perpetuation of the position of the original corner.

C. Description of monument for corner and accessories established to perpetuate locating the position of the corner:

E-13 Set Ottawa County Remon Bar and Cap	(SEE SKETCH ON BACK)
Ottawa County Remon Nail & Tag SW side P. Pole	Az. 129° 77.90'
Ottawa County Remon Nail & Tag S side Elm	Az. 257° 102.06'
Ottawa County Remon Tag & Nail E side Post	Az. 356° 130.75'
Centerline Street sign	Az. 201° 32.06'
Cast Iron Monument E-1, Zeeland Twp.	Az. 273° 47.11'
Centerline New Holland St. E-W (Gravel Rd.)	N 2.5'
Centerline 80th Ave. N (Gravel Rd.) E 3.5'	

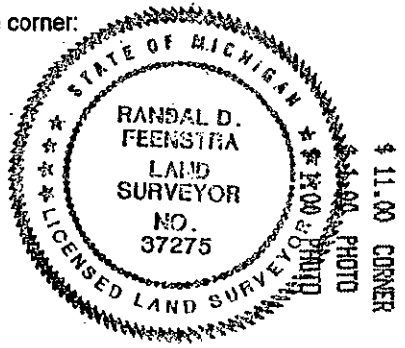

Signed by Randal D. Feenstra
 Surveyor's Michigan License No. 37275

Date October 10, 1996

