

SURVEY & REMONUMENTATION

FEB 27 1998

OTTAWA COUNTY REMONUMENTATION

LAND CORNER RECORDATION CERTIFICATE
Filing Requirement of Act 74, Mich. P.A. 1970

SECTION

For corners in

<u>Ottawa</u>	Located In:	Corner Code #	
(County)			
	Blendon Twp.		
1. Public Land Survey	T <u>6N</u> R <u>14W</u>	G-2, E 1/4 cor.	
	T ___ R ___	Sec. 4	
	T ___ R ___		
	T ___ R ___		
2. Property Controlling in Section	S ___ T ___ R ___		
	S ___ T ___ R ___		
3. Miscellaneous Property in Sec.	S ___ T ___ R ___		
	S ___ T ___ R ___		

RECORDED

97 DEC -8 AM 11: 27

Harry J. ...
REGISTER OF DEEDS
OTTAWA COUNTY, MI

Register of Deeds Stamp & File Number

4. Lot No. _____, Recorded Plat _____
5. Private Claims _____

I, Randal D. Feenstra, in a field survey on Feb 18, 1997 do hereby state that under requirements of P.A. 74, Michigan P.A. of 1970, the corner points mentioned in lines 1 and 2 above were in conformance with regulations and rules therefore as required in the current manual of survey instructions of the United States Department of the Interior, Bureau of Land Management or by a decree of a Court of Law and/or that the corner points mentioned in lines 3, 4 and 5 above were in conformance with the rules of the Michigan Board of Land Surveyors or by a Decree of a Court of Law; established, re-established, monumented, recovered, found as expressed below.

NOTE: Not more than 2 corners, all in the same town and range, may be recorded on this certificate.

A	B	C	D	E	F	G	H	I	J	K	L	M
1												
2	6	5	4	●	3	2	1					
3												
4	7	8	9	10	11	12						
5												
6	18	17	16	15	14	13						
7												
8	19	20	21	22	23	24						
9												
10	30	29	28	27	26	25						
11												
12	31	32	33	34	35	36						
13												

A. Description of original monument and accessories and/or subsequent restoration:

G.L.O. (1832)	LCRC, L-3, P. 244	LCRC, L-3, P. 260	LCRC, L-4, P. 20
Calvin Britain, D.S.	G-2 Found 5/8" Iron in Mon. Box	G-2 Found Iron in Mon. Box	G-2 Found Iron in Mon. Box
Post	P.K. in S Side P. Pole SW 44.27'	P.K. on N Side P. Pole WSW 42.83'	P.K. on N Side P. Pole WSW 42.83'
6" Maple S 10°E 44lks	P.K. in N Side P. Pole WSW 42.80'	P.K. on S Side P. Pole SW 44.28'	P.K. on S Side P. Pole SW 44.28'
10" Maple N 4°E 59 lks	South end of Culvert SE 53.65'	CL Culv. at N end Culv. SE 53.7'	CL Culv. at N end Culv. SE 53.7'
LCRC, L-5, P. 178			
G-2 Set Cast Iron Monument			
N End Culvert	SE 53.70'		
P. Pole	SW 44.28'		
P. Pole	SSE 200.14'		
P. Pole	NNE 174.68'		

B. Description of corner evidence found and/or method applied in restoring or reestablishing corner:

G-2 Found: Cast Iron Monument in Mon. Box

Nail in W. side P. Pole NNE 174.89'
Nail in W. side P. Pole SSE 200.65'
Nail in S. side P. Pole SW 44.22'

P.A. 345 OTTAWA COUNTY
PEER APPROVED 8-18-97
[Signature]

Accepted as a careful and faithful perpetuation of the position of the original corner.

C. Description of monument for corner and accessories established to perpetuate locating the position of the corner:

G-2: Cast Iron Monument in Mon. Box

Ottawa County Remon Nail and Tag in W Side of P. Pole N 15°E 174.89'
Ottawa County Remon Nail & Tag in S. Side of Fence Post E 58.94'
Ottawa County Remon Nail & Tag in W Side of P. Pole S 13°E 200.65'
Ottawa County Remon Nail & Tag in SE Side of P. Pole S 35°W 44.22'
On CL N-S Bit. Rd. (72nd Ave.)

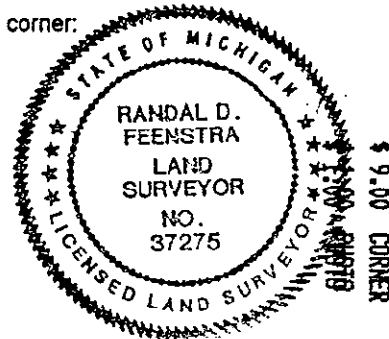

Signed by *Randal D. Feenstra*
Surveyor's Michigan License No. 37275

Date February 18, 1997