

OCT 24 1994

COMMISSION

OTTAWA COUNTY REMONUMENTATION

RECORDED

LAND CORNER RECORDATION CERTIFICATE 94 OCT -7 PM 12:33
Filing Requirement of Act 74, Mich. P.A. 1970

For corners in

Ottawa
(County)

Located In:

Corner Code #

- 1. Public Land Survey T 6N R 14W G-3, NE COR
T R Sec. 9, Blendon
- 2. Property Controlling S T R
- in Section S T R
- 3. Miscellaneous S T R
- Property in Sec. S T R

R. J. ...
REGISTER OF DEEDS
OTTAWA COUNTY, MI

Register of Deeds Stamp & File Number

- 4. Lot No. _____, Recorded Plat _____
- 5. Private Claims _____

A	B	C	D	E	F	G	H	I	J	K	L	M
2	6	5	4	3	2	1						
3												
4	7	8	9	10	11	12						
5												
6	18	17	16	15	14	13						
7												
8	19	20	21	22	23	24						
9												
10	30	29	28	27	26	25						
11												
12	31	32	33	34	35	36						
13												

I, Randal D. Feenstra in a field survey on May 9, 19 94, do hereby certify that under requirements of P.A. 74, Michigan P.A. of 1970, the corner points mentioned in lines 1 and 2 above were in conformance with regulations and rules therefore as required in the current manual of survey instructions of the United States Department of the Interior, Bureau of Land Management or by a decree of a Court of Law and/or that the corner points mentioned in lines 3, 4 and 5 above were in conformance with the rules of the Michigan Board of Land Surveyors or by a Decree of a Court of Law; established, re-established, monumented, re-monumented, recovered, found as expressed below:

NOTE: Not more than 4 corners, all in the same town and range, may be recorded on this certificate.

A. Description of original monument and accessories and/or subsequent restoration:

G.L.O. (1932)	Liber 2, Pg. 239 (7/1973)	Liber 2, Pg. 287 (8/1973)
POST		
5" Tamarack N82°W 5.9 Mon. Box.		Mon. Box
4" Tamarack S81°E 9.2 NE cor frdn.	SW 124.83	NE cor Bridge NE 29.80
Samuel Marrs NE cor conc. pillar	NW 27.61	NW cor Bridge NW 28.97
NW cor conc. pillar	NE 28.50	SW cor Bridge W 18.13
		SE cor Bridge SE 18.70

3. Description of corner evidence found and/or method applied in restoring or reestablishing corner:

Found: Cast Iron Mon. - accepted as a careful and faithful perpetuation of the position of the original corner.

Found Witnesses:

None
None
None

P.A. 345 OTTAWA COUNTY

PEER APPROVED 8/27/94

Cordyn D. Nedwell

C. Description of monument for corner and accessories established to perpetuate locating the position of the corner:

-3 Cast Iron Monument		
I.C. Remon. Nail & tag SE side MBT Support Post	S60°W	122.26
I.C. Remon. Nail & tag W side PP	S25°E	58.03
I.C. Remon. Nail & tag SE side PP	N60°E	71.79
I.C. Remon. Nail & tag top of guard rail post W		36.09
CL of 72nd and ± 21' North of Taylor CL		

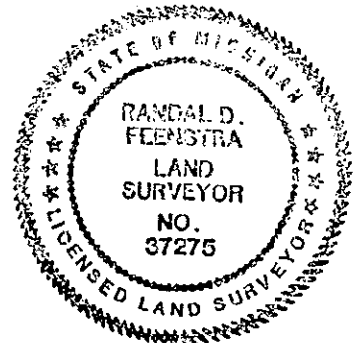

Signed by Randal D. Feenstra

Date May 9, 1994

Surveyor's Michigan License No. 37275