

SURVEY & REMONUMENTATION

OCT 24 1994

COMMISSION

**OTTAWA COUNTY REMONUMENTATION
LAND CORNER RECORDATION CERTIFICATE
Filing Requirement of Act 74, Mich. P.A. 1970**

RECORDED

94 OCT -7 PM 12:33

Polytha Robinson
REGISTER OF DEEDS
OTTAWA COUNTY, MI

For corners in

<u>Ottawa</u> (County)	Located In:	Corner Code #
1. Public Land Survey	T <u>6N</u> R <u>14W</u>	G-5 SE COR
	T _____ R _____	Sec. 9, Blendon
	T _____ R _____	_____
	T _____ R _____	_____
2. Property Controlling in Section	S _____ T _____ R _____	_____
	S _____ T _____ R _____	_____
3. Miscellaneous Property in Sec.	S _____ T _____ R _____	_____
	S _____ T _____ R _____	_____
4. Lot No. _____, Recorded Plat _____		
5. Private Claims _____		

Register of Deeds Stamp & File Number

I, Randal D. Feenstra in a field survey on May 9, 19 94, do hereby certify that under requirements of P.A. 74, Michigan P.A. of 1970, the corner points mentioned in lines 1 and 2 above were in conformance with regulations and rules therefore as required in the current manual of survey instructions of the United States Department of the Interior, Bureau of Land Management or by a decree of a Court of Law and/or that the corner points mentioned in lines 3, 4 and 5 above were in conformance with the rules of the Michigan Board of Land Surveyors or by a Decree of a Court of Law; established, re-established, monumented, re-monumented, recovered, found as expressed below:

NOTE: Not more than 4 corners, all in the same town and range, may be recorded on this certificate.

	A	B	C	D	E	F	G	H	I	J	K	L	M
2	6		5		4		3		2				
3													
4	7		8		9		10		11		12		
5													
6	18		17		16		15		14		13		
7													
8	19		20		21		22		23		24		
9													
10	30		29		28		27		26		25		
11													
12	31		32		33		34		35		36		
13													

A. Description of original monument and accessories and/or subsequent restoration:

GLO (1932)	L-2 Page 481 (1974)	L-2 Page 816 (1975)
POST		
7" Sugar	N87°E 4.0' Found 1" Iron Pipe	3/4" iron in Mon. Box
6" Elm	S78°W 4.6' St. Sign	ESE 39.70' Pk in side guy pole SE 38.04'
Samuel Marrs	PP SW 36.29'	Pk in side cor Fence post NE post 48.44'
	PP SE 38.05'	Pk in side PP SW 36.29'

B. Description of corner evidence found and/or method applied in restoring or reestablishing corner:

Found: Cast Iron Monument in Monument Box - accepted as a careful and faithful perpetuation of the position of the original corner.
 Found Witnesses:
 Spike NW side PP S45°W 36.29
 PK E side PP S45°W 36.24

P.A. 345 OTTAWA COUNTY
 PEER APPROVED 9/22/94
George P. Medwell

C. Description of monument for corner and accessories established to perpetuate locating the position of the corner:

G-5 Cast Iron Monument		
O.C. Remon. Nail & tag in PP	S45°W	36.11'
O.C. Remon. Nail & tag in PP	S40°E	38.64'
Chisled x in 24' conc. culvert	N70°W	52.49'
O.C. Remon. Nail & tag in S side Basswood	N80°E	93.97'
2.5' West of 72nd CL 4' South of Polk CL		

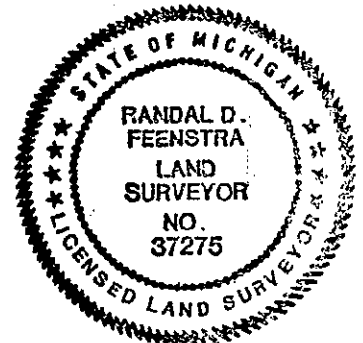

Signed by Randal D. Feenstra Date May 9, 1994
 Surveyor's Michigan License No. 37275