

SURVEY & REMONUMENTATION

APR 05 1996

**OTTAWA COUNTY REMONUMENTATION
LAND CORNER RECORDATION CERTIFICATE
Filing Requirement of Act 74, Mich. P.A. 1970**

COMMISSION

For corners in

Ottawa (County)	Located In: Blendon Twp.	Corner Code #
1. Public Land Survey	T 6N R 14W	G-6, W1/4 Cor. Sec. 15
	T R	
	T R	
	T R	
	T R	
2. Property Controlling in Section	S T R	
	S T R	
3. Miscellaneous Property in Sec.	S T R	
	S T R	
4. Lot No. _____, Recorded Plat _____		
5. Private Claims _____		

RECORDED
95 NOV 29 PM 1:43
Register of Deeds
**REGISTER OF DEEDS
OTTAWA COUNTY, MI**

Register of Deeds Stamp & File Number

I, Randal D. Feenstra, in a field survey on Nov. 6, 1995, do hereby certify that under requirements of P.A. 74, Michigan P.A. of 1970, the corner points mentioned in lines 1 and 2 above were in conformance with regulations and rules therefore as required in the current manual of survey instructions of the United States Department of the Interior, Bureau of Land Management or by a decree of a Court of Law and/or that the corner points mentioned in lines 3, 4 and 5 above were in conformance with the rules of the Michigan Board of Land Surveyors or by a Decree of a Court of Law; established, re-established, monumented, re-monumented, recovered, found as expressed below:

A	B	C	D	E	F	G	H	I	J	K	L	M
2	6	5	4	3	2							
3												
4	7	8	9	10	11	12						
5												
6	18	17	16	15	14	13						
7												
8	19	20	21	22	23	24						
9												
10	30	29	28	27	26	25						
11												
12	31	32	33	34	35	36						
13												

NOTE: Not more than 4 corners, all in the same town and range, may be recorded on this certificate.

A. Description of original monument and accessories and/or subsequent restoration:

GLO (1832) Calvin Britain 7" Beech N88°E 14 lks. 6" Hickory N28°W 11 lks.	LIBER 2, PAGE 469 (1974) 3/4" Pipe S. end of culv. SE 32.00' T. Pole NW 49.00' T. Pole SW 70.92'	LIBER 2, PAGE 705 (1974) 3/4" Iron in Mon. box Pk. in top of f. post NE 36.46' SE cor. Hse. fndtn. NW 119.88' Pk. in side T. Pole SW 71.08'	LIBER 5, PAGE 123 (1984) C.I.M. T. Pole SE 56.44' T. Pole SW 71.75' SE cor., Hse. NW 120.02' P.P. <u>ANN</u> 151.66'
--	--	---	---

B. Description of corner evidence found and/or method applied in restoring or reestablishing corner:

Found: C.I.M. in box Accepted as a careful and faithful perpetuation of the position of the original corner.
SE Cor. Fndn. to Hse. #611 NW 119.85'
Nail in SW side P. Pole NNW 151.55'

P.A. 345 OTTAWA COUNTY
PEER APPROVED 11/20/95
Randal D. Feenstra
R D F

C. Description of monument for corner and accessories established to perpetuate locating the position of the corner:

G-6	C.I.M. in box	
	Ottawa County Remon. Nail & Tag in E side P. Pole 156°	222.28'
	Ottawa County Remon. Nail & Tag in E side P. Pole 28°	166.08'
	SE Cor. Fndn. to Hse. #611 310°	119.85'
	SW Cor. Fndn. to Hse. #611 300°	144.50'

2.5' E & 3' N of centerline "X" Baldwin & 72nd. Ave.

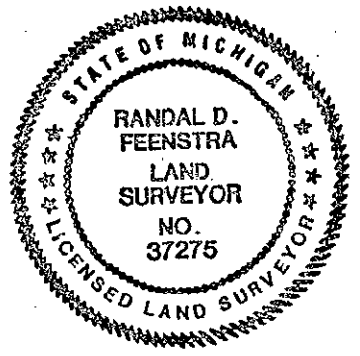

Signed by Randal D. Feenstra Date Nov. 6, 1995
Surveyor's Michigan License No. 37275