

SURVEY &
REMONUMENTATION

FEB 18 1994

OTTAWA COUNTY REMONUMENTATION
LAND CORNER RECORDATION CERTIFICATE
Filing Requirement of Act 74, Mich. P.A. 1970

RECORDED

93 NOV -8 PM 1:58

Rhonda Williams
REGISTER OF DEEDS
OTTAWA COUNTY, MI

For corners in

Ottawa
(County)

Located in:

Corner Code ##

- | | | |
|---------------------------------------|--------------------------|---|
| 1. Public Land Survey | T <u>6N</u> R <u>14W</u> | <u>G-8, E 1/4 COR.</u>
<u>Sec. 21, Blendon</u> |
| | T _____ R _____ | _____ |
| | T _____ R _____ | _____ |
| | T _____ R _____ | _____ |
| 2. Property Controlling
in Section | S _____ T _____ R _____ | _____ |
| | S _____ T _____ R _____ | _____ |
| 3. Miscellaneous
Property in Sec. | S _____ T _____ R _____ | _____ |
| | S _____ T _____ R _____ | _____ |

Register of Deeds Stamp & File Number

4. Lot No. _____, Recorded Plat _____
5. Private Claims _____

I, Randal D. Feenstra in a field survey on October 13, 19 93, do hereby certify that under requirements of P.A. 74, Michigan P.A. of 1970, the corner points mentioned in lines 1 and 2 above were in conformance with regulations and rules therefore as required in the current manual of survey instructions of the United States Department of the Interior, Bureau of Land Management or by a decree of a Court of Law and/or that the corner points mentioned in lines 3, 4 and 5 above were in conformance with the rules of the Michigan Board of Land Surveyors or by a Decree of a Court of Law; established, re-established, monumented, re-monumented, recovered, found as expressed below:

NOTE: Not more than 4 corners, all in the same town and range, may be recorded on this certificate.

A	B	C	D	E	F	G	H	I	J	K	L	M
2	6	5	4	3	2	1						
3												
4	7	8	9	10	11	12						
5												
6	18	17	16	15	14	13						
7												
8	19	20	21	22	23	24						
9												
10	30	29	28	27	26	25						
11												
12	31	32	33	34	35	36						
13												

A. Description of original monument and accessories and/or subsequent restoration:

G-8:			
L.C.R.C.# L-2, P-329 (8-15-73)		L.C.R.C.# L-5, P-124 (6-26-84)	
1" Iron		C.I. Monument	
24" Oak	NE 42.90'	32" tree	NE 42.83'
CL Sign Post	SE 40.73'	T.P.	SE 54.74'
T. Pole	SW 45.15'	T.P.	SW 45.82'
P. Pole	WNW 71.95'	6" Ash	WNW 46.55'

B. Description of corner evidence found and/or method applied in restoring or reestablishing corner:

G-8: Found Cast Iron Monument, accepted as a careful and faithful perpetuation of the position of the original corner.
Nail in S. side 32" Oak N50°E 42.85'

C. Description of monument for corner and accessories established to perpetuate locating the position of the corner:

G-8" Cast Iron Monument

O.C. Remon. Nail & Tag in SW side P.P.	S45°E	42.97'
O.C. Remon. Nail & Tag in S. side 32" Oak	N50°E	42.90'
O.C. Remon. Nail & Tag in N. side P.P.	S50°W	72.61'
O.C. Remon. Nail & Tag in NE side 8" Ash	N45°W	56.42'

2' N. and 2.5' E. of CL "X" 72nd Ave. and Blair St.

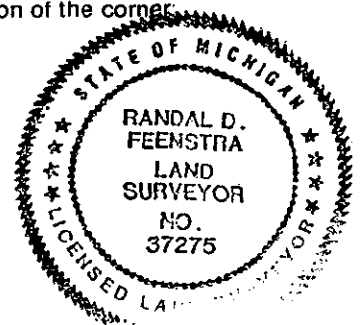

Signed by Randal D. Feenstra Date 10-18-93

Surveyor's Michigan License No. 37275