

SURVEY & REMONUMENTATION

FEB 27 1998

**OTTAWA COUNTY REMONUMENTATION
LAND CORNER RECORDATION CERTIFICATE
Filing Requirement of Act 74, Mich. P.A. 1970**

SECTION

For corners in

<u>Ottawa</u> (County)	Located In:	Corner Code #
	Blendon Twp.	
1. Public Land Survey	T <u>6N</u> R <u>14W</u>	H-1, N 1/4 cor. Sec. 3
	T ___ R ___	___
	T ___ R ___	___
	T ___ R ___	___
2. Property Controlling in Section	S ___ T ___ R ___	___
	S ___ T ___ R ___	___
3. Miscellaneous Property in Sec.	S ___ T ___ R ___	___
	S ___ T ___ R ___	___

RECORDED
97 DEC -8 AM 11:38

Randal D. Feenstra
REGISTER OF DEEDS
OTTAWA COUNTY, MI

Register of Deeds Stamp & File Number

4. Lot No. _____, Recorded Plat _____
5. Private Claims _____

I, Randal D. Feenstra, in a field survey on Feb. 19 97, do hereby state that under requirements of P.A. 74, Michigan P.A. of 1970, the corner points mentioned in lines 1 and 2 above were in conformance with regulations and rules therefore as required in the current manual of survey instructions of the United States Department of the Interior, Bureau of Land Management or by a decree of a Court of Law and/or that the corner points mentioned in lines 3, 4 and 5 above were in conformance with the rules of the Michigan Board of Land Surveyors or by a Decree of a Court of Law; established, re-established, monumented, recovered, found as expressed below:

NOTE: Not more than 2 corners, all in the same town and range, may be recorded on this certificate.

A	B	C	D	E	F	G	H	I	J	K	L	M
1												
2	6	5	4	3	2	1						
3												
4	7	8	9	10	11	12						
5												
6	18	17	16	15	14	13						
7												
8	19	20	21	22	23	24						
9												
10	30	29	28	27	26	25						
11												
12	31	32	33	34	35	36						

A. Description of original monument and accessories and/or subsequent restoration:

G.L.O. (not set)	L.C.R.C., L-5, P. 2 1982	L.C.R.C., L-6, P-151 1991
	H-1 Found "T" Iron	H-1 Replaced Cast Monument
	Set Cast Iron Monument	N10°E 45.11' Head of 60d Nail S. side of power pole
	Light Pole N 45.60'	N60°E 87.01' PK top of 4"x4" post
	10" Catalpa NW 44.15'	S60°E 133.04' PK NW corner of bit. parking lot
	Power Pole S 70.00'	S5°E 59.86' 16d Nail E. side of power pole
	Allendale Cor. E 33.64'	Due East 33.54' Cast Monument (S 1/4 Cor. 34)

B. Description of corner evidence found and/or method applied in restoring or reestablishing corner:

H-1 Found: Cast Iron Monument in Monument Box

Nail and Tag in W. side Power Pole N 45.45'
Allendale Corner (C.I.M.) E 33.57'

PA. 345 OTTAWA COUNTY
PEER APPROVED 12-1-97
G.D.Z.

This position not established by original government surveyors. This monument is accepted as the best available evidence of the position of the corner.

C. Description of monument for corner and accessories established to perpetuate locating the position of the corner:

H-1 Cast Iron Monument in Monument Box (0.44 ft. North of Townline to North (see sketch on back))	
Remon Nail & Tag in W side Power Pole	S4°E 59.27'
Remon Nail & Tag in NW side 6" Pine	S42°W 76.82'
Remon Nail & Tag in W side Power Pole	N6°E 45.45'
Remon Nail & Tag in Top MBT Post (4"x4")	N60°E 87.07'
Allendale Corner C.I.M.	E 33.57'
Centerline EW Bituminous Road (Fillmore St.)	S 0.6'
Centerline Bituminous Road to N. (68th Ave.)	E 34'
On treeline to South	

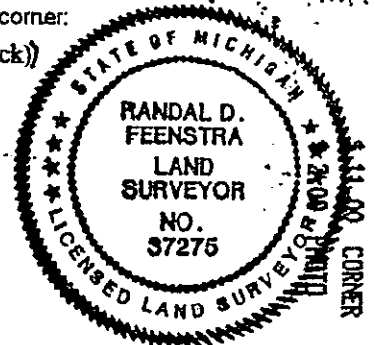

Signed by Randal D. Feenstra
Surveyor's Michigan License No. 37275

Date October 10, 1996

ALLENOLE TWP.

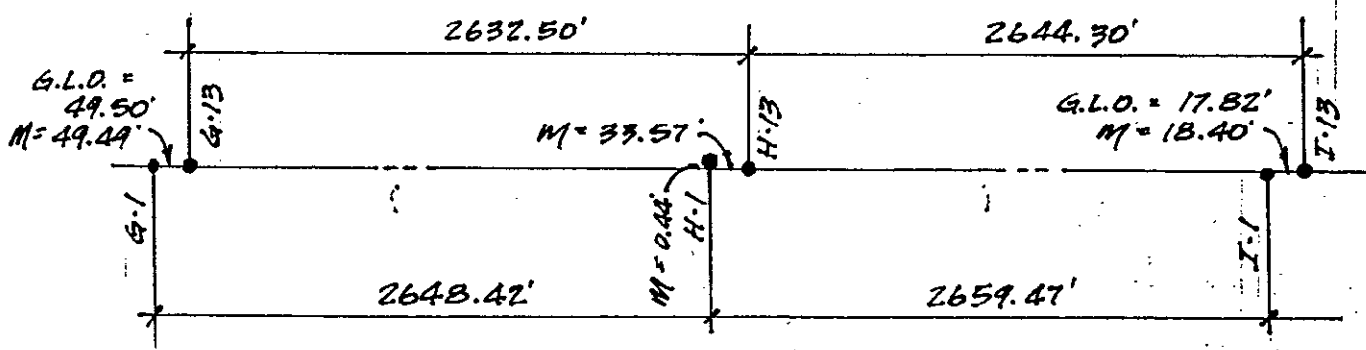

BLENDON TWP.

SURVEY &
REMONUMENTATION

FEB 27 1998

SECTION