

SURVEY & REMONUMENTATION

APR 05 1996

COMMISSION

**OTTAWA COUNTY REMONUMENTATION
LAND CORNER RECORDATION CERTIFICATE
Filing Requirement of Act 74, Mich. P.A. 1970**

For corners in
Ottawa

(County)	Located In:	Corner Code #
1. Public Land Survey	Blendon Twp. T <u>6N</u> R <u>14W</u>	I-13, SE cor.
	T _____ R _____	Sec. 34
	T _____ R _____	_____
	T _____ R _____	_____
	T _____ R _____	_____
2. Property Controlling in Section	S _____ T _____ R _____	_____
	S _____ T _____ R _____	_____
3. Miscellaneous Property in Sec.	S _____ T _____ R _____	_____
	S _____ T _____ R _____	_____

RECORDED

95 NOV 29 PM 1:43

Polycia Chalkman
REGISTER OF DEEDS
OTTAWA COUNTY, MI

Register of Deeds Stamp & File Number

- 4. Lot No. _____, Recorded Plat _____
- 5. Private Claims _____

	A	B	C	D	E	F	G	H	I	J	K	L	M
2	6		5		4		3		2		1		
3													
4	7		8		9		10		11		12		
5													
6	18		17		16		15		14		13		
7													
8	19		20		21		22		23		24		
9													
10	30		29		28		27		26		25		
11													
12	31		32		33		34		35		36		
13													

Randal D. Feenstra November 6 95

I, _____, in a field survey on _____, 19 _____, do hereby certify that under requirements of P.A. 74, Michigan P.A. of 1970, the corner points mentioned in lines 1 and 2 above were in conformance with regulations and rules therefore as required in the current manual of survey instructions of the United States Department of the Interior, Bureau of Land Management or by a decree of a Court of Law and/or that the corner points mentioned in lines 3, 4 and 5 above were in conformance with the rules of the Michigan Board of Land Surveyors or by a Decree of a Court of Law; established, re-established, monumented, re-monumented, recovered, found as expressed below:

NOTE: Not more than 4 corners, all in the same town and range, may be recorded on this certificate.

- A. Description of original monument and accessories and/or subsequent restoration:
- | | |
|-------------------------|----------------------------------|
| G.L.O. (1831) | L-1, P-319, (1972) |
| Calvin Britain | "T" Iron |
| 6" B. Ash N67°W 34 lks. | Nail in T. Pole NNW 108.22' |
| 7' Beech N20°E 26 lks | SE Cor. E'ly Headwall SSW 45.51' |
| | NW Cor. W'ly Headwall SW 53.89' |
| | St. Sign NW 54.31' |

- B. Description of corner evidence found and/or method applied in restoring or reestablishing corner:
- Found: "T" Iron Accepted as a careful and faithful perpetuation of the position of the original corner.

St. Sign NW 54.44"
Zeeland Twp. Corner (C.I.M.) W 36.35'
(referenced to I-1, Liber 3, Page 261, Blendon Cor. E 36.26)

RA. 345 OTTAWA COUNTY
PEER APPROVED 11/20/95

Randal D. Feenstra
RDF

- C. Description of monument for corner and accessories established to perpetuate locating the position of the corner:
- | | |
|--|--------------|
| I-13 Set Ottawa County Bar and Cap in Gravel | |
| SE Cor. Block Fndn. of Hse. #6415 New Holland | 336° 166.83' |
| SW Cor. Block Fndn. of Hse. #6415 New Holland | 319° 198.68' |
| Ottawa County Remon Nail & Tag in W end N'ly 48" CMP | 241° 68.15' |
| Zeeland Twp. Cor. (Mon.). | 270° 36.35' |

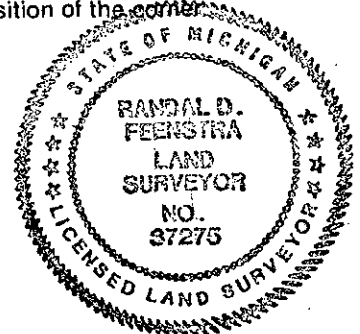

Signed by Randal D. Feenstra
37275

November 6, 1995

Surveyor's Michigan License No. _____