

SURVEY & REMONUMENTATION

APR 05 1996

**OTTAWA COUNTY REMONUMENTATION
LAND CORNER RECORDATION CERTIFICATE
Filing Requirement of Act 74, Mich. P.A. 1970**

For corners in **COMMISSION**
Ottawa
(County)

Located In:	Corner Code #
Blendon Twp.	J-11, N 1/4 Cor.
T 6N R 14W	Sec. 35
T R	
T R	
T R	
S T R	
S T R	
S T R	
S T R	

RECORDED
95 NOV 29 PM 1:38
Randy D. Fenstra
REGISTER OF DEEDS
OTTAWA COUNTY, MI

Register of Deeds Stamp & File Number

- Public Land Survey
- Property Controlling in Section
- Miscellaneous Property in Sec.
- Lot No. _____, Recorded Plat _____
- Private Claims _____

I, Randal D. Fenstra, in a field survey on November 6, 1995, do hereby certify that under requirements of P.A. 74, Michigan P.A. of 1970, the corner points mentioned in lines 1 and 2 above were in conformance with regulations and rules therefore as required in the current manual of survey instructions of the United States Department of the Interior, Bureau of Land Management or by a decree of a Court of Law and/or that the corner points mentioned in lines 3, 4 and 5 above were in conformance with the rules of the Michigan Board of Land Surveyors or by a Decree of a Court of Law; established, re-established, monumented, re-monumented, recovered, found as expressed below:

A	B	C	D	E	F	G	H	I	J	K	L	M
2	6	5	4	3	2	1						
3												
4	7	8	9	10	11	12						
5												
6	18	17	16	15	14	13						
7												
8	19	20	21	22	23	24						
9												
10	30	29	28	27	26	25						
11												
12	31	32	33	34	35	36						
13												

NOTE: Not more than 4 corners, all in the same town and range, may be recorded on this certificate.

A. Description of original monument and accessories and/or subsequent restoration:

G.L.O. (1832)		LIBER 2, PAGE 57 (1973)	LIBER 2, PAGE 441 (1974)
Calvin Britain		Stone	Stone
8" Sugar	S57°E 10 lks.	St. Sign	Nail in P. Pole
8" Sugar	N10°E 9 lks	24" Stump	St. Sign
		P. Pole	Nail in 10" Triple Ash
			"X" on S. end culvert
		S 23.16'	NW 34.72'
		SW 40.43'	SSE 23.13'
		NW 34.17'	S 111.68'
			SW 40.17'

B. Description of corner evidence found and/or method applied in restoring or reestablishing corner:

Found: C.I.M. in box Accepted as a careful and faithful perpetuation of the position of the original corner.

St. Sign SSE 24.25'
Pk in NE side P. Pole NW 34.70'

P.A. 345 OTTAWA COUNTY
PEER APPROVED 11/20/95

Randy D. Fenstra
RDF

C. Description of monument for corner and accessories established to perpetuate locating the position of the corner:

J-11	C.I.M. in gravel	
	Ottawa County Remon Nail & Tag in NE side P. Pole	317° 34.74'
	Ottawa County Remon Nail & Tag in E side P. Pole	349° 127.32'
	Ottawa County Remon Nail & Tag in E side 10" Twin Ash	181° 70.62'
	Ottawa County Remon. Nail & Tag in N side 10" Ash	236° 39.39'

2' W of centerline "X" Van Buren & 60th Ave.

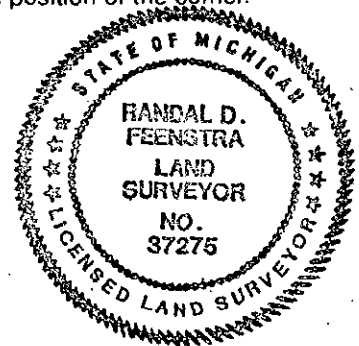

Signed by Randal D. Fenstra
37275
Surveyor's Michigan License No. _____

November 6, 1995

Date _____