

**SURVEY &  
REMONUMENTATION**

APR 05 1996

**COMMISSION**

**OTTAWA COUNTY REMONUMENTATION  
LAND CORNER RECORDATION CERTIFICATE  
Filing Requirement of Act 74, Mich. P.A. 1970**

For corners in  
Ottawa

For corners in Ottawa (County)	Located In:	Corner Code #
1. Public Land Survey	Blendon Twp.	J-13, S 1/4 cor.
	T 6N R 14W	Sec. 35
	T _____ R _____	_____
	T _____ R _____	_____
	T _____ R _____	_____
2. Property Controlling in Section	S _____ T _____ R _____	_____
	S _____ T _____ R _____	_____
3. Miscellaneous Property in Sec.	S _____ T _____ R _____	_____
	S _____ T _____ R _____	_____
4. Lot No. _____, Recorded Plat _____		
5. Private Claims _____		

**RECORDED**  
95 NOV 29 PM 1:38  
*Randy D. Feenstra*  
REGISTER OF DEEDS  
OTTAWA COUNTY, MI

Register of Deeds Stamp & File Number

I, Randal D. Feenstra, in a field survey on November 6, 1995, do hereby certify that under requirements of P.A. 74, Michigan P.A. of 1970, the corner points mentioned in lines 1 and 2 above were in conformance with regulations and rules therefore as required in the current manual of survey instructions of the United States Department of the Interior, Bureau of Land Management or by a decree of a Court of Law and/or that the corner points mentioned in lines 3, 4 and 5 above were in conformance with the rules of the Michigan Board of Land Surveyors or by a Decree of a Court of Law; established, re-established, monumented, re-monumented, recovered, found as expressed below:

A	B	C	D	E	F	G	H	I	J	K	L	M
2	6	5	4	3	2	1						
3												
4	7	8	9	10	11	12						
5												
6	18	17	16	15	14	13						
7												
8	19	20	21	22	23	24						
9												
10	30	29	28	27	26	25						
11												
12	31	32	33	34	35	36						
13												

**NOTE: Not more than 4 corners, all in the same town and range, may be recorded on this certificate.**

A. Description of original monument and accessories and/or subsequent restoration:  
 G.L.O. (1831) L-1, P-321, 1972  
 Calvin Britain "T" Iron  
 8" Sugar N53°W 28 lks. Nail in 12" Hickory N 51.55'  
 9" Sugar N80°E 45 lks. Nail in T. Pole SSW 31.51'  
 Centerline of gravel N 3'  
 On line with fence to North

B. Description of corner evidence found and/or method applied in restoring or reestablishing corner:

Found :1/2" REROD Accepted as a careful and faithful perpetuation of the position of the original corner.

Nail in W. side 16" Hickory N 52.27'  
 Centerline of gravel N 3'  
 Zeeland Township Corner (C.I.M.) W 25.38'  
 (referenced to J-1 Liber 4, Page 346 Blendon Cor. E 25.29')

P.A. 845 OTTAWA COUNTY  
**PEER APPROVED** 11/20/95  
*Randy D. Feenstra*  
 RDM

C. Description of monument for corner and accessories established to perpetuate locating the position of the corner:

J-13 Set Ottawa County Remon. Bar and Cap in Gravel  
 Ottawa County Remon. Nail & Tag in E side P. Pole 205° 52.97'  
 Ottawa County Remon. Nail & Tag in W side 16" Hickory 358° 52.15'  
 Ottawa County Remon. Nail & Tag in N side P. Pole 98° 326.53'  
 Zeeland Township Cor. (C.I.M.) 273° 25.38'  
 Centerline of New Holland 3' North  
 On line with tree line to North

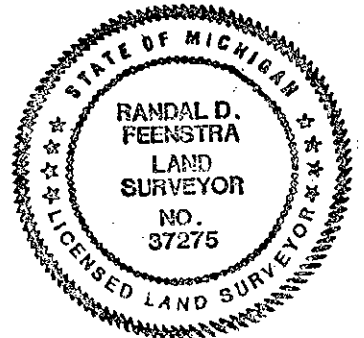

Signed by *Randal D. Feenstra*  
 Surveyor's Michigan License No. 37275

Date November 6, 1995