

SURVEY & REMONUMENTATION
OTTAWA COUNTY REMONUMENTATION

FEB 27 1998 LAND CORNER RECORDATION CERTIFICATE
 Filing Requirement of Act 74, Mich. P.A. 1970

For corners in
Ottawa
 (County)

SECTION

Located in: BLENDON TWP. Corner Code #

| | | | |
|------------------------------------|-------------------|---------------|-------------------|
| 1. Public Land Survey | T <u>6</u> N | R <u>14</u> W | K-2, E 1/4 corner |
| | T ___ R ___ | | Sec. 2 |
| | T ___ R ___ | | |
| | T ___ R ___ | | |
| 2. Property Controlling in Section | S ___ T ___ R ___ | | |
| | S ___ T ___ R ___ | | |
| 3. Miscellaneous Property in Sec. | S ___ T ___ R ___ | | |
| | S ___ T ___ R ___ | | |

RECORDED

97 DEC -8 AM 11:26

Randy Feenstra
 REGISTER OF DEEDS
 OTTAWA COUNTY, MI

Register of Deeds Stamp & File Number

4. Lot No. _____, Recorded Plat _____
 5. Private Claims _____

I, Randal D. Feenstra, in a field survey on Feb. 17, 1997 do hereby state that under requirements of P.A. 74, Michigan P.A. of 1970, the corner points mentioned in lines 1 and 2 above were in conformance with regulations and rules therefore as required in the current manual of survey instructions of the United States Department of the Interior, Bureau of Land Management or by a decree of a Court of Law and for that the corner points mentioned in lines 3, 4 and 5 above were in conformance with the rules of the Michigan Board of Land Surveyors or by a Decree of a Court of Law; established, re-established, monumented, recovered, found as expressed below.

NOTE: Not more than 2 corners, all in the same town and range, may be recorded on this certificate.

| | | | | | | | | | | | | | |
|----|----|---|----|---|----|---|----|---|----|---|----|---|---|
| | A | B | C | D | E | F | G | H | I | J | K | L | M |
| 1 | | | | | | | | | | | | | |
| 2 | 6 | | 5 | | 4 | | 3 | | 2 | | 1 | | |
| 3 | | | | | | | | | | | | | |
| 4 | 7 | | 8 | | 9 | | 10 | | 11 | | 12 | | |
| 5 | | | | | | | | | | | | | |
| 6 | 18 | | 17 | | 16 | | 15 | | 14 | | 13 | | |
| 7 | | | | | | | | | | | | | |
| 8 | 19 | | 20 | | 21 | | 22 | | 23 | | 24 | | |
| 9 | | | | | | | | | | | | | |
| 10 | 30 | | 29 | | 28 | | 27 | | 26 | | 25 | | |
| 11 | | | | | | | | | | | | | |
| 12 | 31 | | 32 | | 33 | | 34 | | 35 | | 36 | | |
| 13 | | | | | | | | | | | | | |

A. Description of original monument and accessories and/or subsequent restoration:

| | | | |
|--|---|--|---|
| G.L.O. (1832) Calvin Britain, DS Set Post 3" Black Ash S 55°E 5lks 10" Birch N 52°E 5lks | LCRC, L-2, P-125 K-2, 1" Pipe SE 55.2 T.P. W 58.58 P.P. NW 24.45 St. Sign | LCRC, L-2, P. 195 K-2, Iron in Monument Box Nail in face P.P. W 58.55' Nail in face P.P. SE 55.18' NW Cor. Hse. Fndtn. SSE 176.65' | LCRC, L-5, P. 117 K-2, Set Cast Iron Monument P.P. W 59.09' Wood Board Post NE 34.43' P.P. SE 55.71' Twin 9" Maple SE 90.76' |
|--|---|--|---|

B. Description of corner evidence found and/or method applied in restoring or reestablishing corner:

K-2 Found: Broken Cast Iron Monument in Mon. Box

P.K. in P. Pole W 59.17'

P.A. 345 OTTAWA COUNTY
 PEER APPROVED 8-18-97

RDF

Accepted as a careful and faithful perpetuation of the position of the original corner

C. Description of monument for corner and accessories established to perpetuate locating the position of the corner:

K-2 Found: Broken Cast Iron Monument in Monument Box
 Ottawa County Remon Nail and Tag in N side P. Pole W 59.17'
 Ottawa County Remon Nail and Tag in W side 18" Mult. Maple N 17°W 118.49'
 Ottawa County Remon Nail and Tag in S side 18" Hickory S 12°E 154.69'
 Ottawa County Remon Nail and Tag in N side 16" Twin Maple S 77°E 90.30'
 Centerline Gravel Rd. to E (Stanton St.) N 4'
 On centerline N-S bit. rd. (56th Ave.) W 0.3'
 On Tree and brush row to W

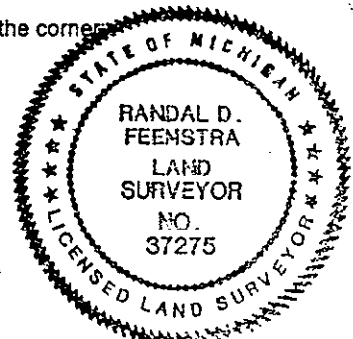

\$ 1.00 PHOTO

Signed by *Randal D. Feenstra*
 Surveyor's Michigan License No. 37275

Date Feb. 17, 1997