

SURVEY &
REMONUMENTATION

OCT 24 1994

OTTAWA COUNTY REMONUMENTATION
LAND CORNER RECORDATION CERTIFICATE
Filing Requirement of Act 74, Mich. P.A. 1970

RECORDED

94 OCT -7 PM 12:33

For corners in COMMISSION

R. J. ...
REGISTER OF DEEDS
OTTAWA COUNTY, MI.

Ottawa (County)	Located In:	Corner Code #
1. Public Land Survey	T <u>6N</u> R <u>14W</u>	K-5 SE COR
	T _____ R _____	Sec. <u>11</u> Blendon
	T _____ R _____	_____
	T _____ R _____	_____
2. Property Controlling in Section	S _____ T _____ R _____	_____
	S _____ T _____ R _____	_____
3. Miscellaneous Property in Sec.	S _____ T _____ R _____	_____
	S _____ T _____ R _____	_____

Register of Deeds Stamp & File Number

4. Lot No. _____, Recorded Plat _____
5. Private Claims _____

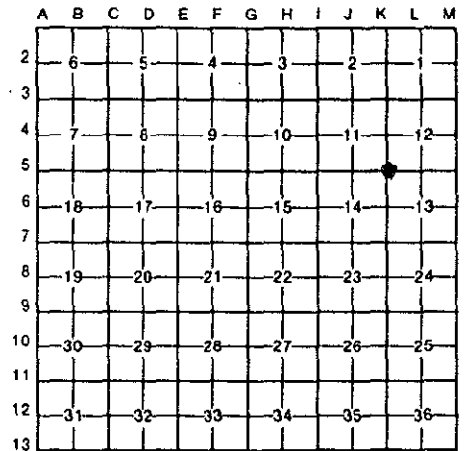

I, Randal D. Feenstra in a field survey on May 26, 1994, do hereby certify that under requirements of P.A. 74, Michigan P.A. of 1970, the corner points mentioned in lines 1 and 2 above were in conformance with regulations and rules therefore as required in the current manual of survey instructions of the United States Department of the Interior, Bureau of Land Management or by a decree of a Court of Law and/or that the corner points mentioned in lines 3, 4 and 5 above were in conformance with the rules of the Michigan Board of Land Surveyors or by a Decree of a Court of Law, established, re-established, monumented, re-monumented, recovered, found as expressed below:

NOTE: Not more than 4 corners, all in the same town and range, may be recorded on this certificate.

A. Description of original monument and accessories and/or subsequent restoration:

GLO (1838)	L-1 Page 751 (1972)	L-4 Page 265 (1981)
24" Pine S54°E 20.5	1" IRON	Cast Iron Monument
30" Pine N80°W 9.2	Nail in 24" Sycamore NNW 93.57'	6" Maple ENE 37.21'
POST	Nail in 24" Maple WSW 57.43'	13" Maple E 41.38'
Samuel Marrs	Nail in 10" Maple E 41.38'	12" Cherry SE 41.26'
	Nail in 12" Maple ESE 28.84'	30" Maple SW 56.72'

B. Description of corner evidence found and/or method applied in restoring or reestablishing corner:

Found CIM in Monument Box - accepted as a careful and faithful perpetuation of the position of the original corner.
Found Witnesses;
Nail S side 10" Maple N80°E 37.21'

P.A. 345 OTTAWA COUNTY
PEER APPROVED 8/22/94

Randal D. Feenstra

C. Description of monument for corner and accessories established to perpetuate locating the position of the corner:

<-5 Cast Iron Monument		
O.C. Remon. Nail & tag S side 32" Maple	S60°W	56.85'
O.C. Remon. Nail & tag S side 24" Maple	S65°E	28.45'
O.C. Remon. Nail & tag S side 10" Maple	N80°E	37.18'
O.C. Remon. Nail & tag W side PP	S25°W	139.77'
CL 56th Avenue and ± 5' N of Polk Street		

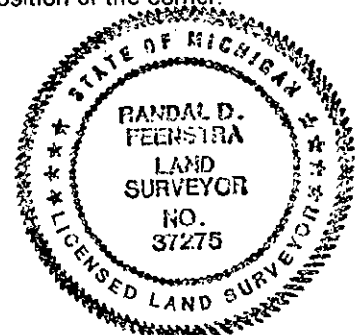

Signed by Randal D. Feenstra Date May 26, 1994
Surveyor's Michigan License No. 37275