

SURVEY &
REMONUMENTATION

NOV 1 6 1993

COMMISSION

LAND CORNER RECORDATION CERTIFICATE
Filing Requirement of Act 74, Mich. P.A. 1970
Ottawa County Remonumentation

For corners in

Ottawa
(County)

Located In: Corner Code #

1. Public Land Survey

BLENDON TWP.
T 6N R 14W K-7 NW Cor-24
T 6N R 14W L-7, N 1/2 Cor-24
T _____ R _____
T _____ R _____
S _____ T _____ R _____
S _____ T _____ R _____
S _____ T _____ R _____
S _____ T _____ R _____

2. Property Controlling
in Section
3. Miscellaneous
Property in Sec.

4. Lot No. _____, Recorded Plat _____
5. Private Claims _____

RECORDED

1993 SEP 29 PM 3:13

Phyllis Christine
REGISTER OF DEEDS
OTTAWA COUNTY, MI

Register of Deeds Stamp & File Number

I, Randal D. Feenstra a field survey on July 13, 19 93,
do hereby certify that under requirements of P.A. 74, Michigan P.A. of 1970, the corner points mentioned
in lines 1 and 2 above were in conformance with regulations and rules therefore as required in the
current manual of survey instructions of the United States Department of the Interior, Bureau of Land
Management or by a decree of a Court of Law and/or that the corner points mentioned in lines 3, 4 and 5
above were in conformance with the rules of the Michigan Board of Land Surveyors or by a Decree of a
Court of Law; established, re-established, monumented, re-monumented, recovered, found as
expressed below:

NOTE: Not more than 4 corners, all in the same town and range, may be recorded
on this certificate.

	A	B	C	D	E	F	G	H	I	J	K	L	M
2	6		5		4		3		2		1		
3													
4	7		8		9		10		11		12		
5													
6	18		17		16		15		14		13		
7													
8	19		20		21		22		23		24		
9													
10	30		29		28		27		26		25		
11													
12	31		32		33		34		35		36		
13													

A. Description of original monument and accessories and/or subsequent restoration:

K-7 = LCRC#'s L-1, P-409; L-1, P601; L-2, P-191; L-4, P-353; L-5, P-281

L-7 = LCRC#'s L-3, P-26; L-3, P-239; L-5, P-178

B. Description of corner evidence found and/or method applied in restoring or reestablishing corner:

K-7
Found Cast Iron Monument
And Witnesses Per
LCRC # L-5, P-281

L-7
Found Cast Iron Monument
And Witnesses Per
L-5, P-178

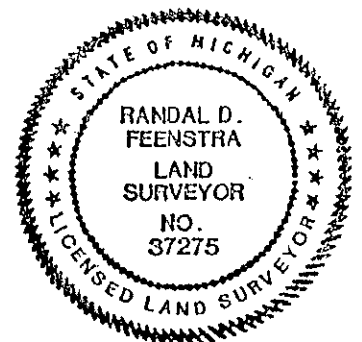

C. Description of monument for corner and accessories established to perpetuate locating the position of the corner:

K-7- Cast Iron Monument per L-5, P-281, Ottawa County, MI, and is accepted as a careful and
O.C. Remon. Nail & Tag in P. Pole N28°W 90.88' faithful perpetuation of the
O.C. Remon. Nail & Tag in 6" Poplar N70°E 69.25 position of the original corner.
O.C. Remon. Nail & Tag in 4" Birch S40°E 93.89
O.C. Remon. Nail & Tag in 12" Maple N68°W 91.62 CL Tyler 11' South, CL 56th O'W.

L-7-Cast Iron Monument per L-5, P-178, Ottawa County, MI, and is accepted as a careful and
O.C. Remon. Nail & Tag in P. Pole N30°W 35.09 faithful perpetuation of the
O.C. Remon. Nail & Tag in 12" Pine S40°W 62.24 position of the original corner.
O.C. Remon. Nail & Tag in 32" Oak S60°E 121.42
NW cor. of shed foundation S00°E 55.15
CL Tyler - 20' ± South

Signed by Randal D. Feenstra Date July 13, 1993

Surveyor's Michigan License No. 37275