

**SURVEY & REMONUMENTATION**

OCT 24 1994

COMMISSION

OTTAWA COUNTY REMONUMENTATION

**LAND CORNER RECORDATION CERTIFICATE**  
Filing Requirement of Act 74, Mich. P.A. 1970

RECORDED

94 OCT -7 PM 12:34

*R. J. ...*  
REGISTER OF DEEDS  
OTTAWA COUNTY, MI

For corners in

Ottawa

(County)

Located In:

Corner Code #

- |                                       |                          |                        |
|---------------------------------------|--------------------------|------------------------|
| 1. Public Land Survey                 | T <u>6N</u> R <u>14W</u> | L-5 <u>S1/4</u> COR    |
|                                       | T _____ R _____          | Sec. <u>12</u> Blendon |
|                                       | T _____ R _____          | _____                  |
|                                       | T _____ R _____          | _____                  |
| 2. Property Controlling in Section    | S _____ T _____ R _____  | _____                  |
|                                       | S _____ T _____ R _____  | _____                  |
| 3. Miscellaneous Property in Sec.     | S _____ T _____ R _____  | _____                  |
|                                       | S _____ T _____ R _____  | _____                  |
| 4. Lot No. _____, Recorded Plat _____ |                          |                        |
| 5. Private Claims _____               |                          |                        |

Register of Deeds Stamp & File Number

A	B	C	D	E	F	G	H	I	J	K	L	M
2	6	5	4	3	2	1						
3												
4	7	8	9	10	11	12						
5												
6	18	17	16	15	14	13						
7												
8	19	20	21	22	23	24						
9												
10	30	29	28	27	26	25						
11												
12	31	32	33	34	35	36						
13												

I, Randal D. Feenstra, in a field survey on May 27, 1994, do hereby certify that under requirements of P.A. 74, Michigan P.A. of 1970, the corner points mentioned in lines 1 and 2 above were in conformance with regulations and rules therefore as required in the current manual of survey instructions of the United States Department of the Interior, Bureau of Land Management or by a decree of a Court of Law and/or that the corner points mentioned in lines 3, 4 and 5 above were in conformance with the rules of the Michigan Board of Land Surveyors or by a Decree of a Court of Law; established, re-established, monumented, re-monumented, recovered, found as expressed below.

**NOTE: Not more than 4 corners, all in the same town and range, may be recorded on this certificate.**

A. Description of original monument and accessories and/or subsequent restoration:

GLO (1838)	L-2 Page 115 (1973)
9" Black Ash S30°E 5.3	3/4" Pipe
8" Black Ash N 7.3	14" Maple N 14.15'
POST	18" Oak NW 17.7
Samuel Marrs	15" Ash SE 34.75'

B. Description of corner evidence found and/or method applied in restoring or reestablishing corner:

Found: 3/4" Pipe - accepted as a careful and faithful perpetuation of the position of the original corner.

Found Witnesses:  
Nail in W side 12" Maple N10°E 14.62'  
Nail in N side 12" Ash S45°E 35.41'

PA. 345 OTTAWA COUNTY  
PEER APPROVED 8/22/94  
*Jordan D. Hedewell*

C. Description of monument for corner and accessories established to perpetuate locating the position of the corner:

L-5 Set O.C. Remon. Bar and Cap		
O.C. Remon. Nail & tag N side 12" Ash	S45°E	35.12'
O.C. Remon. Nail & tag W side 12" Maple	N10°E	14.49'
O.C. Remon. Nail & tag NE side 28" Oak	N50°W	17.29'
O.C. Remon. Nail & tag N side 10" Maple	S50°W	36.05'

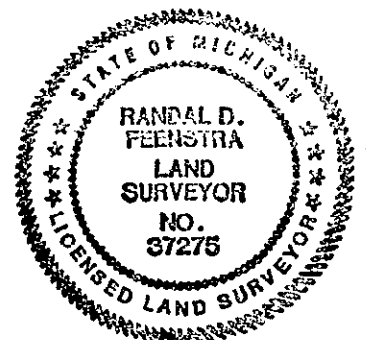

Signed by Randal D. Feenstra Date May 27, 1994

Surveyor's Michigan License No. 37275