

NOV 10 1993

COMMISSION

**LAND CORNER RECORDATION CERTIFICATE**

Filing Requirement of Act 74, Mich. P.A. 1970  
OTTAWA COUNTY REMONUMENTATION

For corners in  
OTTAWA  
(County)

Located In: BLENDON TWP. Corner Code ##

|                                    |                          |                                   |
|------------------------------------|--------------------------|-----------------------------------|
| 1. Public Land Survey              | T <u>6N</u> R <u>14W</u> | <u>L-9</u> S $\frac{1}{2}$ Cor-24 |
|                                    | T <u>6N</u> R <u>14W</u> | M-9, SE Ccr-24                    |
|                                    | T _____ R _____          | _____                             |
|                                    | T _____ R _____          | _____                             |
| 2. Property Controlling in Section | S _____ T _____ R _____  | _____                             |
|                                    | S _____ T _____ R _____  | _____                             |
| 3. Miscellaneous Property in Sec.  | S _____ T _____ R _____  | _____                             |
|                                    | S _____ T _____ R _____  | _____                             |

RECORDED

1993 SEP 29 PM 3:13

*Sheldon K. Sheldon*  
REGISTER OF DEEDS  
OTTAWA COUNTY, MI

Register of Deeds Stamp & File Number

4. Lot No. \_\_\_\_\_, Recorded Plat \_\_\_\_\_  
5. Private Claims \_\_\_\_\_

|    | A  | B  | C  | D  | E  | F  | G | H | I | J | K | L | M |
|----|----|----|----|----|----|----|---|---|---|---|---|---|---|
| 2  | 6  | 5  | 4  | 3  | 2  | 1  |   |   |   |   |   |   |   |
| 3  |    |    |    |    |    |    |   |   |   |   |   |   |   |
| 4  | 7  | 8  | 9  | 10 | 11 | 12 |   |   |   |   |   |   |   |
| 5  |    |    |    |    |    |    |   |   |   |   |   |   |   |
| 6  | 18 | 17 | 16 | 15 | 14 | 13 |   |   |   |   |   |   |   |
| 7  |    |    |    |    |    |    |   |   |   |   |   |   |   |
| 8  | 19 | 20 | 21 | 22 | 23 | 24 |   |   |   |   |   |   |   |
| 9  |    |    |    |    |    |    |   |   |   |   |   |   |   |
| 10 | 30 | 29 | 28 | 27 | 26 | 25 |   |   |   |   |   |   |   |
| 11 |    |    |    |    |    |    |   |   |   |   |   |   |   |
| 12 | 31 | 32 | 33 | 34 | 35 | 36 |   |   |   |   |   |   |   |
| 13 |    |    |    |    |    |    |   |   |   |   |   |   |   |

I, Randal D. Feenstra, in a field survey on July 13, 1993, do hereby certify that under requirements of P.A. 74, Michigan P.A. of 1970, the corner points mentioned in lines 1 and 2 above were in conformance with regulations and rules therefore as required in the current manual of survey instructions of the United States Department of the Interior, Bureau of Land Management or by a decree of a Court of Law and/or that the corner points mentioned in lines 3, 4 and 5 above were in conformance with the rules of the Michigan Board of Land Surveyors or by a Decree of a Court of Law; established, re-established, monumented, re-monumented, recovered, found as expressed below:

**NOTE: Not more than 4 corners, all in the same town and range, may be recorded on this certificate.**

A. Description of original monument and accessories and/or subsequent restoration:

- L-9 = LCRC#'s L-3, P-161; L-5, P120
- M-9 = LCRC#'s L-3, P-161; L-5, P-126

B. Description of corner evidence found and/or method applied in restoring or reestablishing corner:

- |   |   |
|---|---|
| L-9   | M-9   |
| Found Cast Iron Monument in Box<br>And Witnesses Per<br>LCRC # L-5, P-120 | Found Cast Iron Monument in Box<br>And Witnesses Per<br>LCRC # L-5, P-126 |

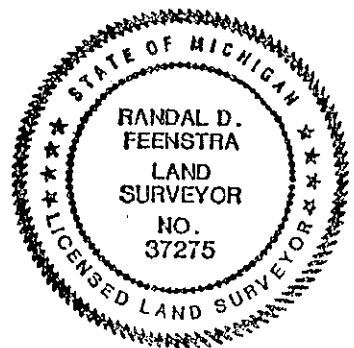

C. Description of monument for corner and accessories established to perpetuate locating the position of the corner:

- L-9-Cast Iron Monument per L-5, P-120, Ottawa County, MI, and is accepted as a careful and faithful perpetuation of the position of the original corner.
 

|                                      |       |       |  |
|--------------------------------------|-------|-------|--|
| O.C. Remon. Nail & Tag in Power Pole | N8°W  | 35.26 |  |
| O.C. Remon. Nail & Tag in Power Pole | S0°E  | 45.92 |  |
| O.C. Remon. Nail & Tag in 34" Maple  | N27°W | 48.77 |  |
| O.C. Remon. Nail & Tag in 26" Maple  | S30°E | 82.91 |  |
- ⓐ CL Port Sheldon
  - M-9-Cast Iron Monument per L-5, P-126, Ottawa County, MI, and is accepted as a careful and faithful perpetuation of the position of the original corner.
 

|  |       |       |  |
|--|-------|-------|--|
| O.C. Remon. Nail & Tag in Power Pole   | S42°E | 60.53 |  |
| O.C. Remon. Nail & Tag in Telephone P. | N44°E | 43.31 |  |
| O.C. Remon. Nail & Tag in Light Pole   | N50°W | 53.64 |  |
| Georgetown Twp cor (Mon. in box)       | S0°E  | 12.54 |  |
  - CL "X" Port Sheldon & 48th

Signed by Randal D. Feenstra Date July 13, 1993  
Surveyor's Michigan License No. 37275