

OCT 24 1994

COMMISSION

OTTAWA COUNTY REMONUMENTATION

LAND CORNER RECORDATION CERTIFICATE  
Filing Requirement of Act 74, Mich. P.A. 1970

RECORDED

94 OCT -7 PM 12:33

*Ruthie Anderson*  
REGISTER OF DEEDS  
OTTAWA COUNTY, MI

For corners in

Ottawa (County) Located In: Corner Code #

1. Public Land Survey T 6N R 14W M-3 NE COR  
T \_\_\_\_\_ R \_\_\_\_\_ Sec, 12 Blendon  
T \_\_\_\_\_ R \_\_\_\_\_  
T \_\_\_\_\_ R \_\_\_\_\_

2. Property Controlling S \_\_\_\_\_ T \_\_\_\_\_ R \_\_\_\_\_  
in Section S \_\_\_\_\_ T \_\_\_\_\_ R \_\_\_\_\_

3. Miscellaneous S \_\_\_\_\_ T \_\_\_\_\_ R \_\_\_\_\_  
Property in Sec. S \_\_\_\_\_ T \_\_\_\_\_ R \_\_\_\_\_

4. Lot No. \_\_\_\_\_, Recorded Plat \_\_\_\_\_

5. Private Claims \_\_\_\_\_

Register of Deeds Stamp & File Number

I, Randal D. Feenstra, in a field survey on May 27, 19 94, do hereby certify that under requirements of P.A. 74, Michigan P.A. of 1970, the corner points mentioned in lines 1 and 2 above were in conformance with regulations and rules therefore as required in the current manual of survey instructions of the United States Department of the Interior, Bureau of Land Management or by a decree of a Court of Law and/or that the corner points mentioned in lines 3, 4 and 5 above were in conformance with the rules of the Michigan Board of Land Surveyors or by a Decree of a Court of Law; established, re-established, monumented, re-monumented, recovered, found as expressed below:

	A	B	C	D	E	F	G	H	I	J	K	L	M
2	6		5		4		3		2		1		
3													
4	7		8		9		10		11		12		
5													
6	18		17		16		15		14		13		
7													
8	19		20		21		22		23		24		
9													
10	30		29		28		27		26		25		
11													
12	31		32		33		34		35		36		
13													

NOTE: Not more than 4 corners, all in the same town and range, may be recorded on this certificate.

A. Description of original monument and accessories and/or subsequent restoration:

GLO (1938)	L-5 Page 74 (1983)
7" Beech S54°W 9.9	Cast Iron Monument
10" Beech N32°W 25.0	Fence Post E 39.71
POST	S end Corr. culvert SE 38.88
Samuel Marrs	S end Corr. culvert NW 150.25

B. Description of corner evidence found and/or method applied in restoring or reestablishing corner:

Found Cast Iron Monument in Monument Box - accepted as a careful and faithful perpetuation of the position of the original corner.  
Found Witnesses:  
S end 12" CMP Culvert S50°E 38.8±

P.A. 345 OTTAWA COUNTY  
PEER APPROVED 9/22/94  
*George D. Nedwell*

C. Description of monument for corner and accessories established to perpetuate locating the position of the corner:

M-3 Cast Iron Monument

O.C. Remon. Nail & tag N side Fence Post	E 40.06'
O.C. Remon. Nail & tag N side 10" elm	W 63.21'
O.C. Remon. Nail & tag N end 15" CMP culvert N 65°E	44.01'
O.C. Remon. Nail & tag S end 15" CMP culvert S 50°E	38.55'

CL of 48th Avenue

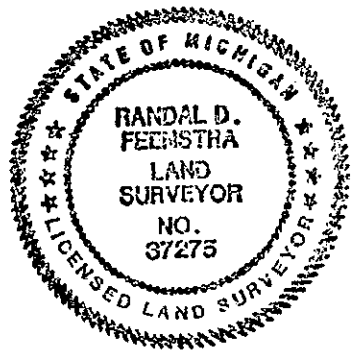

Signed by Randal D. Feenstra Date May 27, 1994  
Surveyor's Michigan License No. 37275